



Property Record Card

Routt County Assessor

STEAMBOAT SPRINGS CHRISTIAN CENTER

OF THE ASSEMBLIES OF GOD
P O BOX 770968
STEAMBOAT SPRINGS, CO 80477-0968

Account: R0520224

STEAMBOAT CHRISTIAN
CENTER
Tax Area: 25 - *RE2* SS City
Limits_Mountain / Mtn. Village
Areas_But Not Ski Area Base
Acres: 5.000

Parcel: 936283004

Situs Address:
795 DOUGHERTY RD
STEAMBOAT SPRINGS, 80487

Value Summary

Value By:	Market	Override
Comm Land (1)	\$2,450,000	N/A
Steamboat Res (1)	\$579,280	N/A
Comm Imprv (1)	\$1,211,690	N/A
Comm Imprv (2)	\$1,478,390	N/A
Comm Imprv (3)	\$463,140	N/A
XFOB (1)	\$0	N/A
XFOB (2)	\$9,510	N/A
Total	\$6,192,010	\$6,192,010

Legal Description

TR IN SE4SW4 SEC 28-6-84 TOTAL 5A



Public Remarks

Entry Date	Model	Remark
06/22/2005		SOA #620555 AUTHORIZING RICHARD DUNCAN, CHAIRMAN & JAMES C. PEARSON, CORPORATE SECRETARY. KL
03/21/2019	Steamboat Res Occurrence 1	TY2019: DPT FILE#54-01027

Comm Land Occurrence 1

Property Code	9151 - CHURCH LAND NON RES 9155 - RELIGIOUS RES OTHER LAND	Economic Area	7 - STEAMBOAT COMM
Neighborhood	4 - STEAMBOAT FRINGE	Land Code	7777101 - SOUTH LINCOLN AND



Property Record Card

Routt County Assessor

Comm Land Occurrence 1

Land Use	1 - PRIME SITE	Zoning	WALTON
Site Access	2 - YEAR-ROUND	Road	RE-1
Site View	3 - AVERAGE	Topography	4 - PAVED
Slope	1 - NOT EFFECTED	Wetness	1 - LEVEL
Water	3 - COMM/PUBLIC	Utilities	1 - NOT AFFECTED
Sewer	3 - COMM/PUBLIC		4 - GAS/ELEC

SubArea	ABOVE GRADE LIVING	ACTUAL TOTAL SQ FT	Effective SqFt - Assessor Use Only	RENTAL AREA	UNIT VALUE
Acres		5.0			
Total		5.00			
	Value	Rate	Rate	Rate	Rate
	\$2,450,000		490,000.00		

Steamboat Res Occurrence 1

Property Code	9255 - RELIGIOUS RES OTHER BLDG	Economic Area	7 - STEAMBOAT COMM
Neighborhood	71002 - WHISTLER MDWS	Building Type	1 - 1 STORY
Grade/Quality	40 - GOOD	Foundation	1 - CONCRETE
Garage Capacity	2	Total Rooms	8
Bedrooms	4	Bath Count	3.5
Baths Full	3	Baths Half	1
Kitchen Count	1	Fireplace Count	0
Roof Style	1 - GABLE	Roof Cover	3 - METAL
Insulation	3 - AVERAGE	Windows	3 - DOUBLE GLAZE
Exterior Condition	4 - NORMAL	Heating Fuel	2 - GAS
Heating Type	4 - HOT WTR BSBD	Interior Condition	3 - NORMAL
Exterior Wall	1 - PLY/HBD	Percent	100
Architectural Style	2 - CONTEMPORARY	Effective Year Built	2000
Actual Year Built	2000	Fuel Type	2 - GAS

SubArea	ABOVE GRADE LIVING	ACTUAL TOTAL SQ FT	Effective SqFt - Assessor Use Only	RENTAL AREA	UNIT VALUE
FIRST	1998	1998	1998		
Total	1,998.00	1,998.00	1,998.00		
	Value	Rate	Rate	Rate	Rate
	\$579,280	289.93	289.93		

Property Record Card

Routt County Assessor

Steamboat Res Occurrence 1

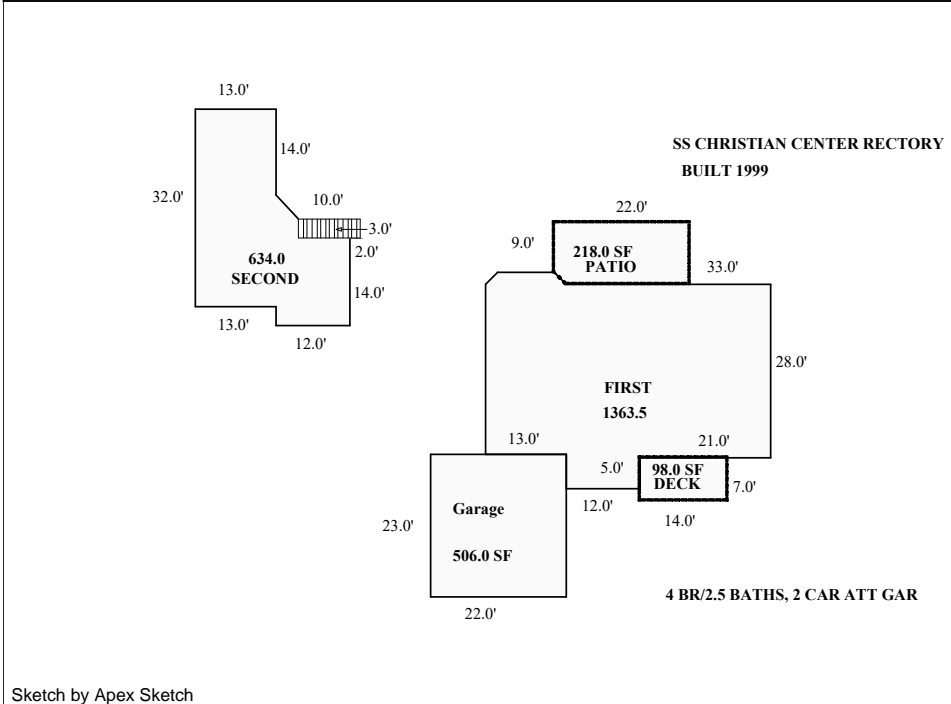

Comm Imprv Occurrence 1

Property Code	9251 - CHURCH BLDG NON RES	Actual Year Built	1985
Building Use	67 - Church w/out school	Neighborhood	4 - Steamboat Fringe
Grade/Quality	6 - Superior + + +	Effective Year Built	2000
Stories	1	Roof Structure	1 - GABLE
Roof Cover	3 - METAL	Foundation	1 - CONCRETE
Frame	1 - WOOD	Basement Type	1 - SLAB
Interior Condition	4 - Normal	Exterior Condition	4 - Normal
Air Conditioning	3 - CENTRAL	Heating Fuel	1 - GAS
Heating Type	2 - FORCED AIR	Interior Wall Height	3 - > = 15 feet
Exterior Wall	6 - LOG	Interior Wall	2 - TXT DRYWALL

SubArea	ABOVE GRADE LIVING	ACTUAL TOTAL SQ FT	Effective SqFt - Assessor Use Only	RENTAL AREA	UNIT VALUE
SubArea_FIRST		7901	7901	7901	
SubArea_SECOND		1917	1629	1629	
Total		9,818.00	9,530.00	9,530.00	
	Value	Rate	Rate	Rate	Rate
	\$1,211,690		123.42	127.14	127.14

Comm Imprv Occurrence 1

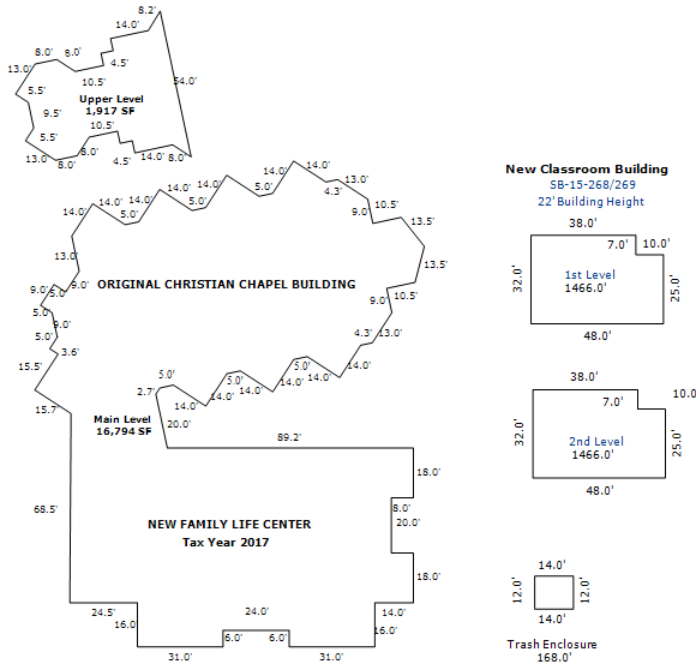

Comm Imprv Occurrence 2

Property Code	9251 - CHURCH BLDG NON RES	Actual Year Built	2016
Building Use	67 - Church w/out school	Neighborhood	4 - Steamboat Fringe
Grade/Quality	7 - Superior + + + +	Effective Year Built	2016
Stories	1	Roof Structure	1 - GABLE
Roof Cover	3 - METAL	Foundation	1 - CONCRETE
Frame	1 - WOOD	Basement Type	1 - SLAB
Interior Condition	4 - Normal	Exterior Condition	4 - Normal
Air Conditioning	3 - CENTRAL	Heating Fuel	1 - GAS
Heating Type	2 - FORCED AIR	Interior Wall Height	2 - 11 to 14 feet
Exterior Wall	6 - LOG	Interior Wall	2 - TXT DRYWALL
Permit Description	NEW FAMILY LIFE CENTER - GYMNASIUM/STAGE/BATHS/OFFICE/KIOSK		

SubArea	ABOVE GRADE LIVING	ACTUAL TOTAL SQ FT	Effective SqFt - Assessor Use Only	RENTAL AREA	UNIT VALUE
SubArea_FIRST		8893	8893	8893	
Total		8,893.00	8,893.00	8,893.00	
	Value	Rate	Rate	Rate	Rate
	\$1,478,390		166.24	166.24	166.24

Comm Imprv Occurrence 3

Property Code	9251 - CHURCH BLDG NON RES	Actual Year Built	2015
Building Use	58 - School	Neighborhood	4 - Steamboat Fringe
Grade/Quality	3 - Average	Effective Year Built	2015
Stories	1	Roof Structure	1 - GABLE
Roof Cover	3 - METAL	Foundation	1 - CONCRETE
Frame	1 - WOOD	Basement Type	1 - SLAB



Property Record Card

Routt County Assessor

Comm Imprv Occurrence 3

Interior Condition	7 - Excellent	Exterior Condition	7 - Excellent
Air Conditioning	3 - CENTRAL	Heating Fuel	1 - GAS
Heating Type	2 - FORCED AIR	Interior Wall Height	1 - 8 to 10 feet
Exterior Wall	1 - PLYWD / HRDBD	Permit Description	SB-15-268 2 STORY CLASSROOM BUILDING

SubArea	ABOVE GRADE LIVING	ACTUAL TOTAL SQ FT	Effective SqFt - Assessor Use Only	RENTAL AREA	UNIT VALUE
SubArea_FIRST		1466	1466	1466	
SubArea_SECOND		1466	1246	1246	
Total		2,932.00	2,712.00	2,712.00	
	Value	Rate	Rate	Rate	Rate
	\$463,140		157.96	170.77	170.77

XFOB Occurrence 1

Property Code	9255 - RELIGIOUS RES OTHER BLDG	Paired Model	1
Grade	40 - GOOD	Effective Year Built	2000
XFOB Code	101 - GAR,1 STORY ATT	Actual Year Built	2000
Condition	4 - NORMAL		

SubArea	ABOVE GRADE LIVING	ACTUAL TOTAL SQ FT	Effective SqFt - Assessor Use Only	RENTAL AREA	UNIT VALUE
SQFT		400	400		
Total		400.00	400.00		
	Value	Rate	Rate	Rate	Rate
	\$0				

XFOB Occurrence 2

Property Code	9251 - CHURCH BLDG NON RES	Paired Model	1
Grade	30 - AVERAGE	Effective Year Built	2015
XFOB Code	939 - UTILITY, D	Actual Year Built	2015
Condition	5 - GOOD		

SubArea	ABOVE GRADE LIVING	ACTUAL TOTAL SQ FT	Effective SqFt - Assessor Use Only	RENTAL AREA	UNIT VALUE
SQFT		400	400		
Total		400.00	400.00		
	Value	Rate	Rate	Rate	Rate
	\$9,510		23.78	23.78	

Abstract Summary

Code	Classification	Actual Value	Value	Taxable Value	Actual Value Override	Taxable Override
9151	CHURCH LAND NON RES		\$2,205,000	\$639,450	NA	NA
9155	RELIGIOUS RES OTHER LAND		\$245,000	\$17,520	NA	NA
9251	CHURCH BLDG NON RES		\$3,162,730	\$917,190	NA	NA
9255	RELIGIOUS RES OTHER BLDG		\$579,280	\$41,420	NA	NA
Total			\$6,192,010	\$1,615,580	NA	NA