

IF THIS DRAWING IS PRESENTED IN A FORMAT OTHER THAN 24" X 36", THE GRAPHIC SCALE SHOULD BE UTILIZED.

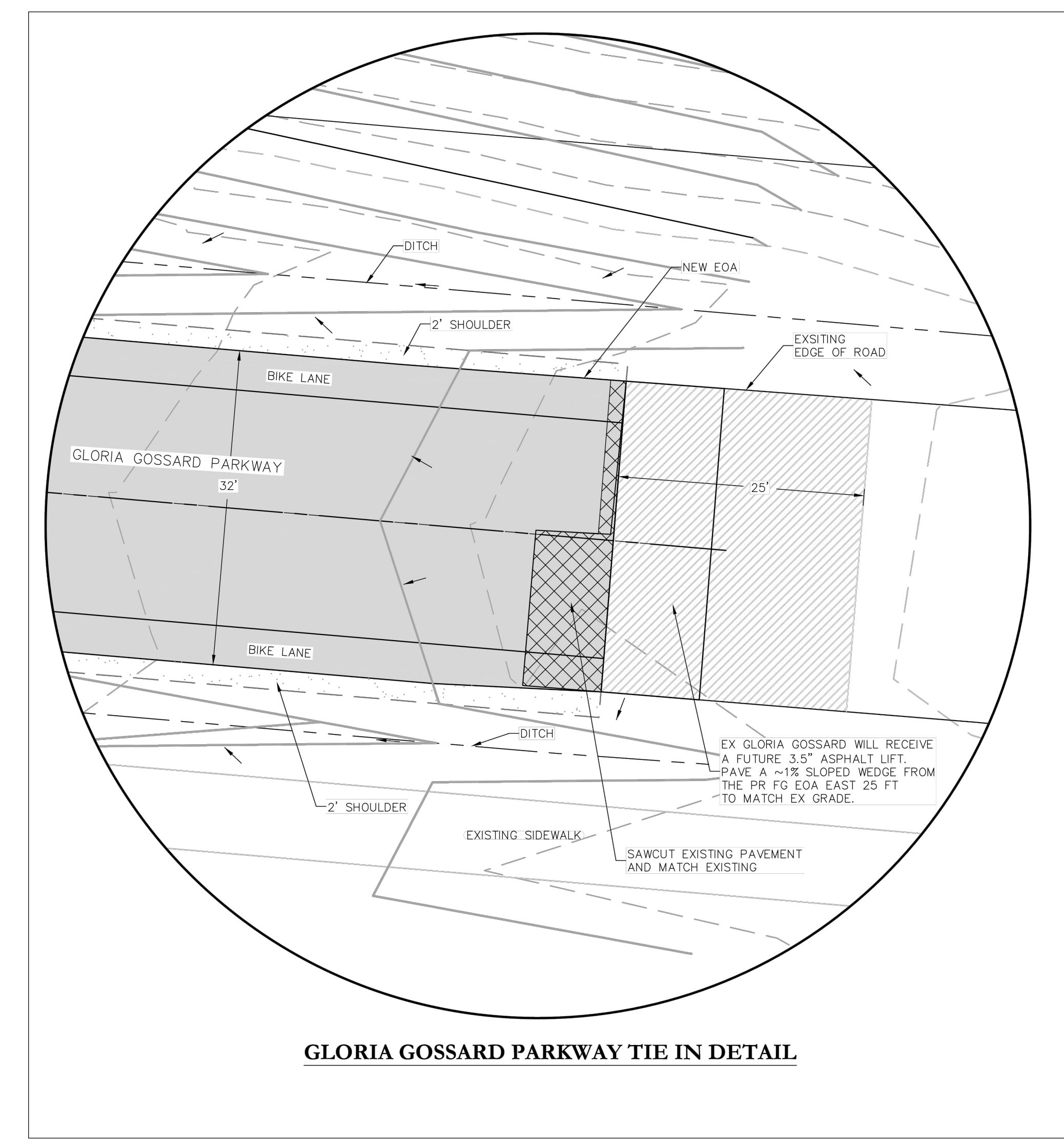

GLORIA GOSSARD PARKWAY TIE IN DETAIL

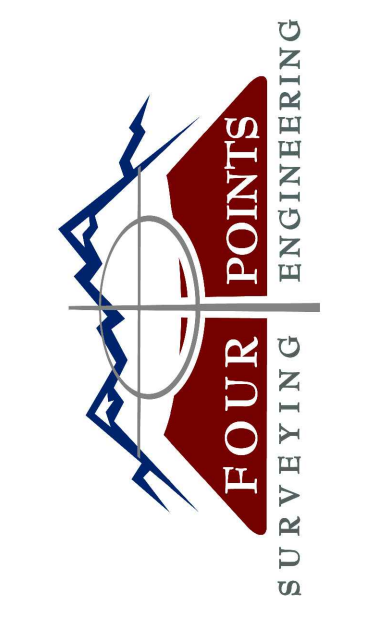
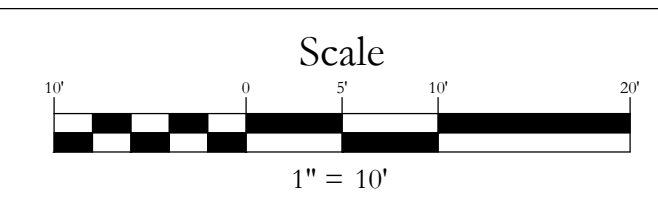

440 S. Lincoln Ave, Suite 4A
P.O. Box 775966
Steamboat Springs, CO 80487
(970)-871-6772
www.fourpointse.com

No.	DATE	REVISIONS	INT

**STEAMBOAT AIRPARK
PRELIMINARY PLAT
LOT 1, WEST ACRES RANCH SUBDIVISION
GLORIA GOSSARD PARKWAY
STEAMBOAT SPRINGS, CO 80487**

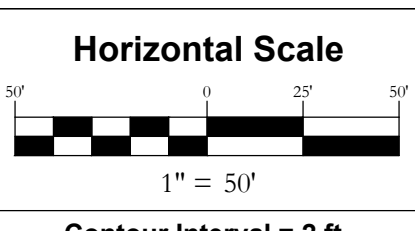

Contour Interval = 2 ft
DATE: 4-22-2022
JOB #: 1670-001
DRAWN BY: MDM/JLW
DESIGN BY: MDM/JLW
REVIEW BY: RL

IF THIS DRAWING IS PRESENTED IN A FORMAT OTHER THAN 24" X 36", THE GRAPHIC SCALE SHOULD BE UTILIZED.

**DRAWING:
GLORIA GOSSARD
PLAN & PROFILE
STA 10+00 TO 16+50**

SHEET #

PP15