



Property Record Card

Routt County Assessor

LIMAN, LES A.

P O BOX 774362
 STEAMBOAT SPRINGS, CO 80477-4362

Account: R8180938

Tax Area: 27X - *RE2* SS City
 Limits_ West Stmbt- Airport Comm.
 Areas, Fairview Subdv.

Acres: 0.000

Parcel: 321206601

Situs Address:
 2835 DOWNHILL PLZ #601
 STEAMBOAT SPRINGS, 80487

Value Summary

Value By:	Market	Override
Comm Imprv (1)	\$268,700	\$347,790
Total	\$268,700	\$347,790

Legal Description

UNIT 601 DOWNHILL PLAZA CONDOMINIUM



Public Remarks

Entry Date	Model	Remark
02/24/2021		2/24/2021: NEW CONDO FROM R6813454/121200007 TO R8180928/321255011-R8180950/321277001. FILE#14487, REC#820936 2/19/2021. COVS#820937. SUBCODE 3212.

Comm Imprv Occurrence 1

Property Code	2230 - SPEC PURPOSE BLDG 2130 - SPEC PURPOSE LAND	Actual Year Built	2018
Building Use	62 - Warehouse - Storage	Neighborhood	6 - Downhill - Copper - Elk
Grade/Quality	3 - Average	Effective Year Built	2018
Stories	2	Roof Structure	3 - FLAT
Roof Cover	4 - BUILTUP	Foundation	1 - CONCRETE
Frame	4 - BLOCK	Basement Type	1 - SLAB
Interior Condition	4 - Normal	Exterior Condition	4 - Normal
Air Conditioning	3 - CENTRAL	Heating Fuel	1 - GAS
Heating Type	2 - FORCED AIR	Floor	1 - UNFIN CONC
Interior Wall Height	2 - 11 to 14 feet	Exterior Wall	10 - CONC BLOCK
Interior Wall	2 - TXT DRYWALL	Permit Description	B-17-681 BUILDING 500 WAREHOUSE SPACE



Property Record Card

Routt County Assessor

Comm Imprv Occurrence 1

SubArea	ABOVE GRADE LIVING	ACTUAL TOTAL SQ FT	Effective SqFt - Assessor Use Only	RENTAL AREA	UNIT VALUE
SubArea_FIRST		2230	2230	2230	
Total		2,230.00	2,230.00	2,230.00	
	Value	Rate	Rate	Rate	Rate
	\$347,790		155.96	155.96	155.96

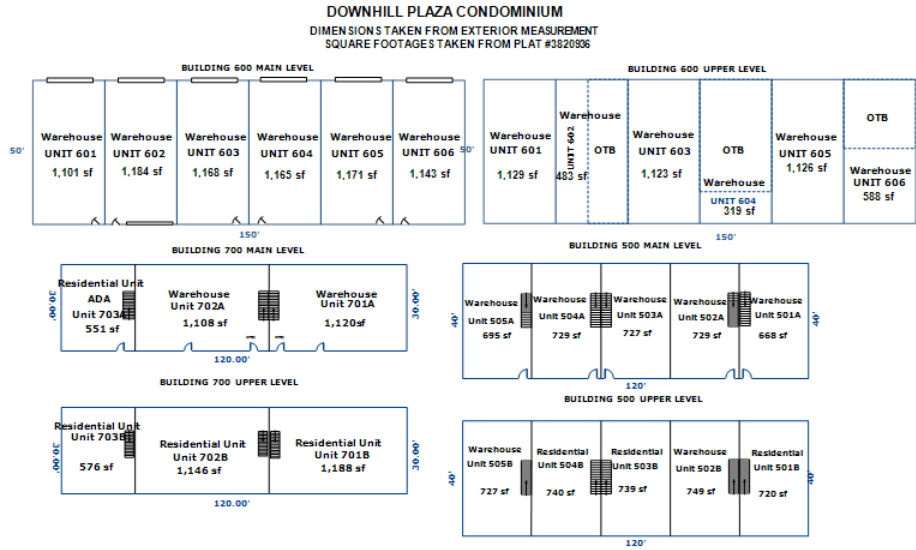

Abstract Summary

Code	Classification	Actual Value	Value	Taxable Value	Actual Value Override	Taxable Override
2130	SPEC PURPOSE LAND		\$134,350	\$38,960	\$43,820	\$12,710
2230	SPEC PURPOSE BLDG		\$134,350	\$38,960	\$303,970	\$88,150
Total			\$268,700	\$77,920	\$347,790	\$100,860