

**NOTES:**

1. THE SIZE, TYPE AND LOCATION OF ALL KNOWN UNDERGROUND UTILITIES ARE APPROXIMATE WHEN SHOWN ON THESE DRAWINGS. IT SHALL BE THE RESPONSIBILITY OF THE CONTRACTOR TO VERIFY THE EXISTENCE OF ALL UNDERGROUND UTILITIES IN THE AREA OF THE WORK. BEFORE COMMENCING NEW CONSTRUCTION, THE CONTRACTOR SHALL BE RESPONSIBLE FOR LOCATING ALL UNDERGROUND UTILITIES AND SHALL BE RESPONSIBLE FOR ALL UNKNOWN UNDERGROUND UTILITIES.
2. EXISTING UNDERGROUND AND OVERHEAD PUBLIC AND PRIVATE UTILITIES AS SHOWN ARE INDICATED ACCORDING TO THE BEST INFORMATION MADE AVAILABLE TO THE ENGINEER. THE ENGINEER DOES NOT GUARANTEE NOR IS RESPONSIBLE FOR THE ACCURACY OF SUCH INFORMATION. EXISTING UTILITY MAINS AND SERVICES MAY NOT BE STRAIGHT LINES OR AS INDICATED ON THESE DRAWINGS. CONTRACTOR TO VERIFY EXISTING HORIZONTAL AND VERTICAL LOCATIONS PRIOR TO CONSTRUCTION.
3. ALL SEWER CONSTRUCTION SHALL BE PER MOUNT WERNER WATER STANDARD SPECIFICATIONS, LATEST EDITION.
4. MAINTAIN 10' HORIZONTAL AND 18" VERTICAL MINIMUM SEPARATION BETWEEN ALL SANITARY SEWER MAINS, WATER MAINS & SERVICES.
5. MANHOLES LOCATED OUTSIDE OF PAVEMENTS SHALL PROTRUDE 1" ABOVE EXISTING GRADE TO REDUCE INFILTRATION. GRADE SURFACE TO DRAIN AROUND/AWAY FROM MANHOLE RIMS.
6. ALL MANHOLES LOCATED IN PAVEMENTS SHALL HAVE RIM ELEVATIONS ADJUSTED TO 1/2" BELOW FINISHED GRADE. IF NECESSARY, CONE SECTIONS SHALL BE ROTATED TO PREVENT LIDS BEING LOCATED WITHIN VEHICLE OR BICYCLE WHEEL PATHS.
7. SEWER SERVICE SHALL HAVE A MINIMUM OF 4-FT OF COVER.
8. WATER SERVICE SHALL HAVE A MINIMUM OF 7-FT OF COVER.
9. ALL WATER PIPE SHALL BE INSTALLED WITH A #10 SOLID COPPER WIRE COATED WITH 45 MIL POLYETHYLENE FOR LOCATING PURPOSES. "GLENN TEST STATIONS" BY VALVCO, INC. TRACER WIRE TEST STATIONS SHALL BE INSTALLED ADJACENT TO ALL FIRE HYDRANTS. ADDITIONAL LOCATIONS MAY BE REQUIRED.
10. ALL MATERIALS USED FOR BACKFILL SHALL BE FREE FROM REFUSE ORGANIC MATERIAL, COBBLES, BOLDERS, LARGE ROCKS OR STONES OR FROZEN SOILS GREATER THAN 6-INCHES IN DIAMETER.
11. ALL TRENCHES SHALL BE COMPACTED TO 95% AS DETERMINED BY ASTM D698 (STANDARD PROCTOR) OR AS SPECIFIED BY GEOTECHNICAL ENGINEER.
12. BEDDING AND SHADING MATERIALS SHALL ONLY BE 3/4-INCH WASHED OR SCREENED ROCK. 3/4-INCH MINUS, SQUEEGEE OR REJECT SAND, OR CLASS 6 AGGREGATE BASE COURSE IS NOT ALLOWED.
13. ALL PROJECT DATA IS ON VERTICAL DATUM, NAVD 88. SEE NOTES SHEET FOR BENCHMARK REFERENCES.
14. ELEVATIONS FOR IMPROVEMENTS THAT ARE CONTROLLED BY ADJACENT EXISTING FACILITIES (SUCH AS PROPOSED GUTTERS ALONG EXISTING ASPHALT) MAY REQUIRE ADJUSTMENT BASED ON ACTUAL CONDITIONS. COORDINATE WITH ENGINEER TO ENSURE A CONSISTENT SECTION WITH SMOOTH TRANSITIONS WHERE NECESSARY.
15. SEE SOILS REPORT FOR PAVEMENT, SUBGRADE AND MATERIAL PREPARATION, DESIGN AND RECOMMENDATIONS.

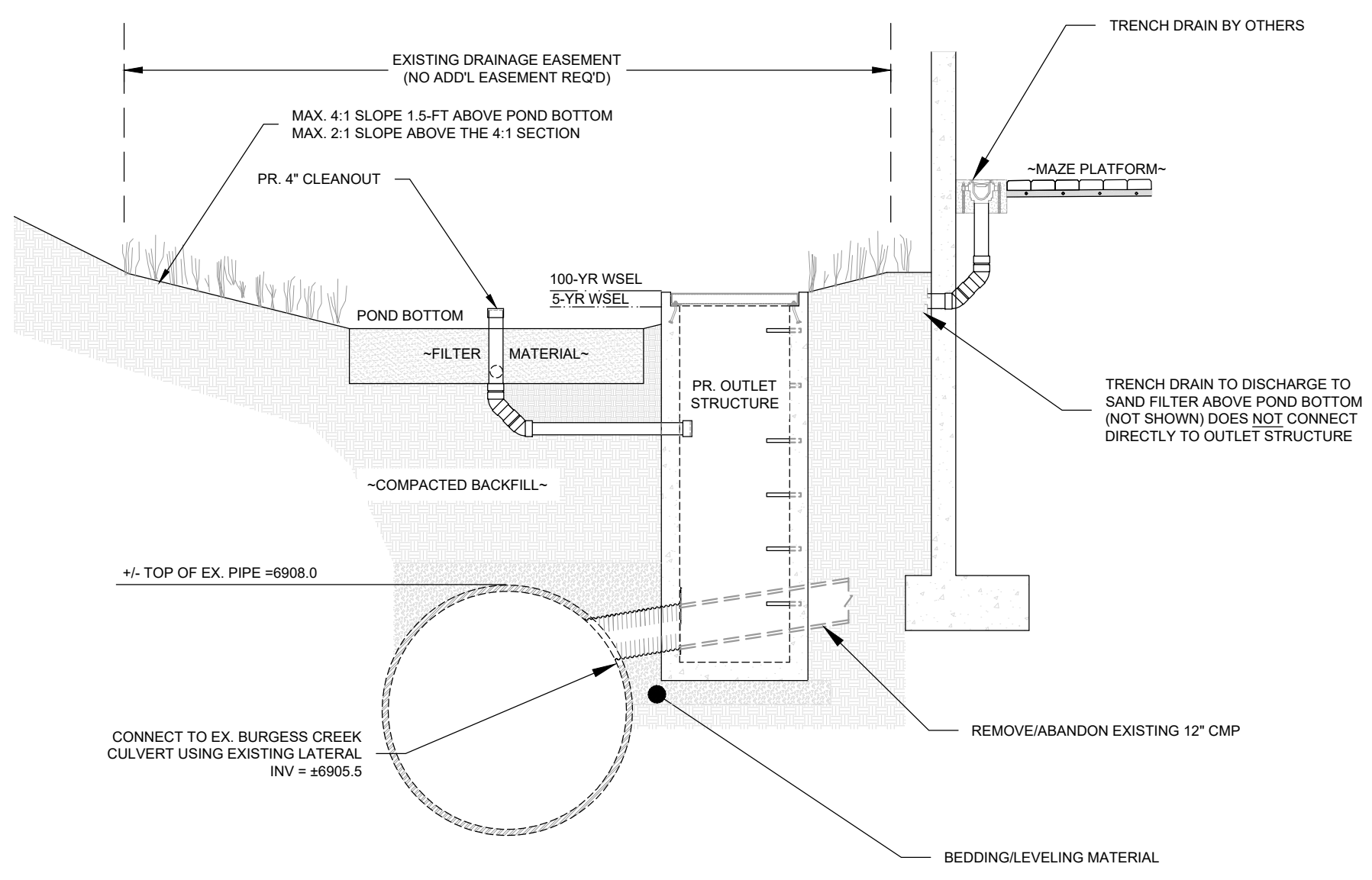

SAND FILTER, OUTLET AND CONNECTION TO EX. CULVERT EXHIBIT

CIVIL ENGINEERS | SURVEYORS  
 141 9th Street - P.O. Box 74843  
 Steamboat Springs, Colorado 80477  
 (970) 871-9494  
 www.LANDMARK-CD.com

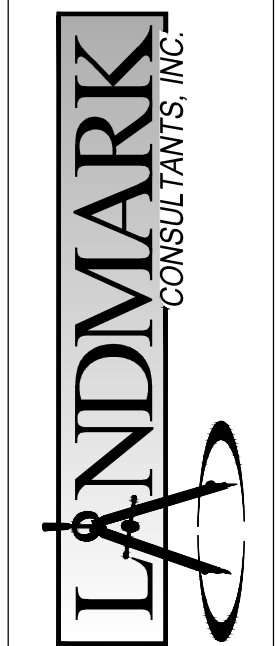

THIS SET OF DRAWINGS IS THE PROPERTY OF LANDMARK CONSULTANTS, INC. AND IS NOT TO BE REPRODUCED, COPIED, OR TRANSMITTED IN ANY FORM OR BY ANY MEANS, ELECTRONIC OR MECHANICAL, WITHOUT THE WRITTEN PERMISSION OF LANDMARK CONSULTANTS, INC.

DESCRIPTION  
 Addressed DIT Comments  
**REVIEW SET**  
**NOT FOR CONSTRUCTION**  
 12/29/2021

NO.	DATE	BY	GRIP
1	12-3-21		

PROJECT: 1012-050  
 DATE: 9/17/2021  
 CONTACT: Matt Genesi  
 EMAIL: mgenesi@landmark-co.com

**WILD BLUE GONDOLA**  
**Detailed Grading, Drainage Plan**  
**(Lower Terminal)**

SHEET  
**C.300**  
 OF # SHEETS

DRAWING FILENAME: P:\1012-050\DWG\1012-050-050-C.300-Detailed Grading, Drainage Plan (Lower Terminal).dwg DATE: Tue, 07/20/2021 7:05:46 AM CAD: MATT GENESI  
 LIST OF SHEETS: 1012-050-050-050-C.300-Detailed Grading, Drainage Plan (Lower Terminal).dwg 1012-050-050-050-C.300-Detailed Grading, Drainage Plan (Lower Terminal).dwg 1012-050-050-050-C.300-Detailed Grading, Drainage Plan (Lower Terminal).dwg

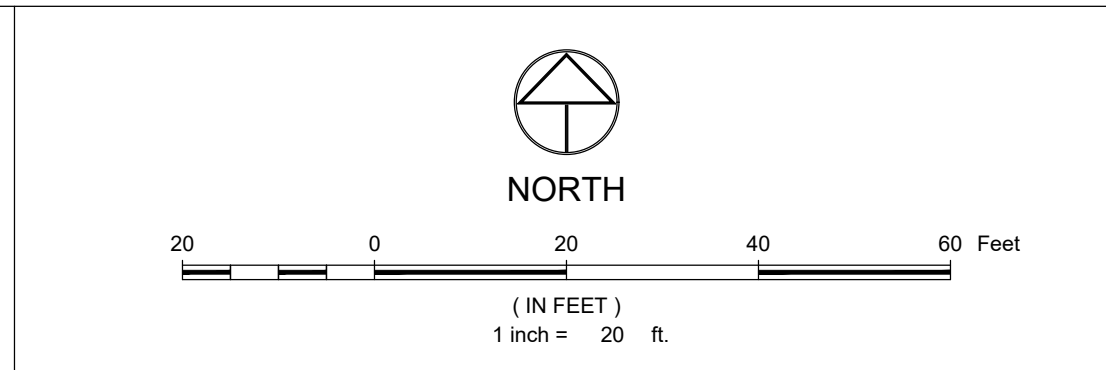
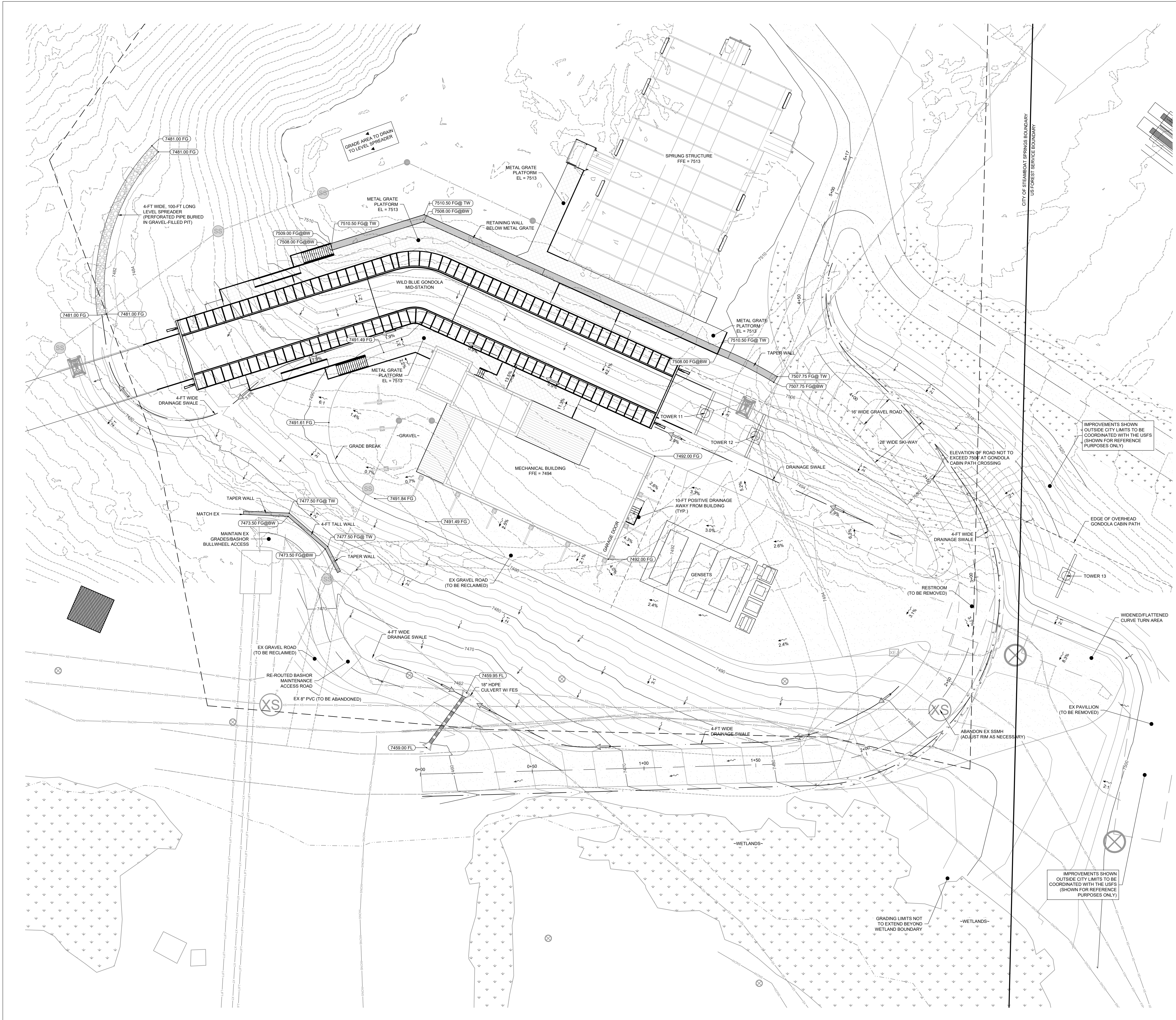

**LEGEND:**

- EXISTING STORM SEWER
- PROPOSED STORM SEWER
- PROPOSED STORM INLET (CURB & AREA)
- PROPOSED MAJOR CONTOUR
- PROPOSED MINOR CONTOUR
- EXISTING MAJOR CONTOUR
- EXISTING MINOR CONTOUR
- PROPOSED SWALE
- PROPOSED CURB & GUTTER
- PROPERTY BOUNDARY
- PROPOSED LOT LINE
- EXISTING RIGHT OF WAY
- FLOOD HAZARD LIMITS
- PROPOSED SPOT ELEVATION
- EXISTING SPOT ELEVATION
- PROPOSED OVERLAND FLOW DIRECTION W/SLOPE
- PROPOSED CHANNELIZED FLOW DIRECTION W/ SLOPE
- EXISTING CHANNELIZED FLOW DIRECTION

**NOTES:**

1. THE SIZE, TYPE AND LOCATION OF ALL KNOWN UNDERGROUND UTILITIES ARE APPROXIMATE WHEN SHOWN ON THESE DRAWINGS. IT SHALL BE THE RESPONSIBILITY OF THE DEVELOPER TO VERIFY THE EXISTENCE OF ALL UNDERGROUND UTILITIES IN THE AREA OF THE WORK. BEFORE COMMENCING NEW CONSTRUCTION, THE CONTRACTOR SHALL BE RESPONSIBLE FOR LOCATING ALL UNDERGROUND UTILITIES AND SHALL BE RESPONSIBLE FOR ALL UNKNOWN UNDERGROUND UTILITIES.
2. ALL PROJECT DATA IS ON VERTICAL DATUM; NAVD 88. SEE NOTES SHEET FOR BENCHMARK REFERENCES.
3. ELEVATIONS FOR IMPROVEMENTS THAT ARE CONTROLLED BY ADJACENT EXISTING FACILITIES (SUCH AS PROPOSED GUTTERS ALONG EXISTING ASPHALT) MAY REQUIRE ADJUSTMENT BASED ON ACTUAL CONDITIONS. COORDINATE WITH ENGINEER TO ENSURE A CONSISTENT SECTION WITH SMOOTH TRANSITIONS WHERE NECESSARY.
4. SEE SOILS REPORT FOR PAVEMENT, SUBGRADE AND MATERIAL PREPARATION, DESIGN AND RECOMMENDATIONS.
5. ALL CURB SPOTS SHOWN ARE FLOWLINE ELEVATIONS, UNLESS NOTED OTHERWISE. ALL OTHER SPOTS ARE FINISHED GRADE ELEVATIONS.

CIVIL ENGINEERS | SURVEYORS  
 141 9th Street - P.O. Box 74843  
 Steamboat, Colorado 80477  
 (970) 871-9494  
 www.LANDMARK-CO.com

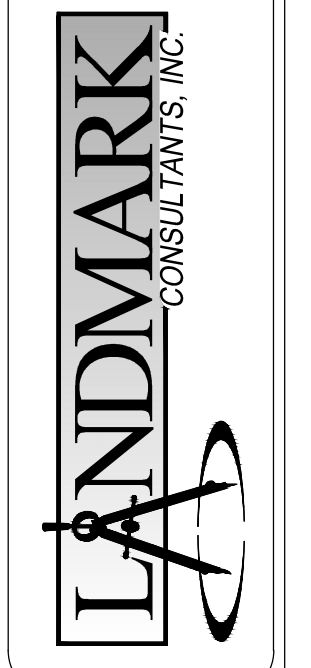

PLEASE NOTE: This drawing is for informational purposes only. It is not to be used for construction or other purposes without the written consent of Landmark Consultants, Inc. and is not to be construed as a contract or any other legal instrument. The user of this drawing assumes all liability for its use.

PROJECT:	1012-050
DATE:	9/17/2021
CONTACT:	Matt General
EMAIL:	mgeneral@landmark-co.com

**REVIEW SET**  
 NOT FOR CONSTRUCTION  
 12/31/2021

WILD BLUE GONDOLA  
 DETAILED GRADING PLAN  
 (GREEN HORN RANCH)

SHEET  
**C.310**  
 OF # SHEETS

DRAWING FILENAME: P:\1012-050\Drawings\1012-050-C.310-Detailed Grading Plan.dwg LAYOUT NAME: C.310 DATE: 09/17/2021 2:41pm CAD OPERATOR: Matt General  
 LIST OF SHEETS: 1012-050-001, 1012-050-002, 1012-050-003, 1012-050-004, 1012-050-005, 1012-050-006, 1012-050-007, 1012-050-008, 1012-050-009, 1012-050-010, 1012-050-011, 1012-050-012, 1012-050-013, 1012-050-014, 1012-050-015, 1012-050-016, 1012-050-017, 1012-050-018, 1012-050-019, 1012-050-020, 1012-050-021, 1012-050-022, 1012-050-023, 1012-050-024, 1012-050-025, 1012-050-026, 1012-050-027, 1012-050-028, 1012-050-029, 1012-050-030, 1012-050-031, 1012-050-032, 1012-050-033, 1012-050-034, 1012-050-035, 1012-050-036, 1012-050-037, 1012-050-038, 1012-050-039, 1012-050-040, 1012-050-041, 1012-050-042, 1012-050-043, 1012-050-044, 1012-050-045, 1012-050-046, 1012-050-047, 1012-050-048, 1012-050-049, 1012-050-050, 1012-050-051, 1012-050-052, 1012-050-053, 1012-050-054, 1012-050-055, 1012-050-056, 1012-050-057, 1012-050-058, 1012-050-059, 1012-050-060, 1012-050-061, 1012-050-062, 1012-050-063, 1012-050-064, 1012-050-065, 1012-050-066, 1012-050-067, 1012-050-068, 1012-050-069, 1012-050-070, 1012-050-071, 1012-050-072, 1012-050-073, 1012-050-074, 1012-050-075, 1012-050-076, 1012-050-077, 1012-050-078, 1012-050-079, 1012-050-080, 1012-050-081, 1012-050-082, 1012-050-083, 1012-050-084, 1012-050-085, 1012-050-086, 1012-050-087, 1012-050-088, 1012-050-089, 1012-050-090, 1012-050-091, 1012-050-092, 1012-050-093, 1012-050-094, 1012-050-095, 1012-050-096, 1012-050-097, 1012-050-098, 1012-050-099, 1012-050-100

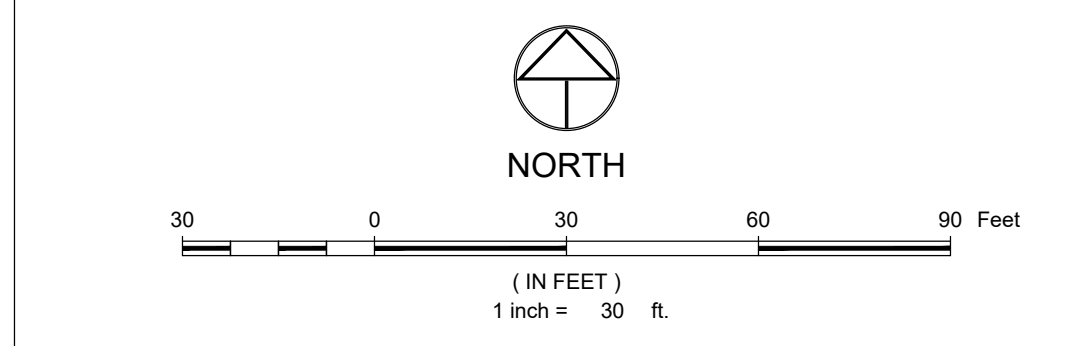
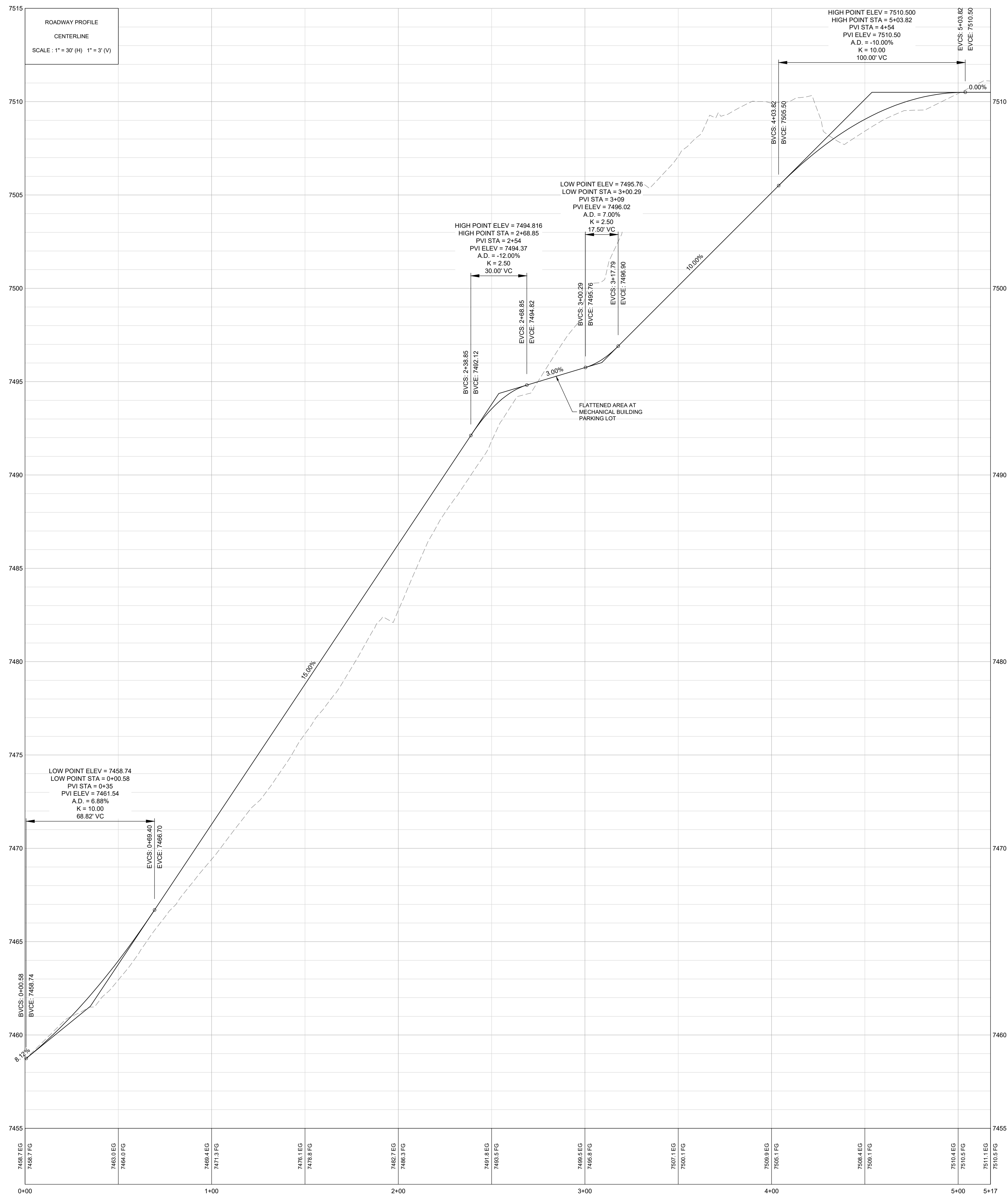

**LEGEND:**

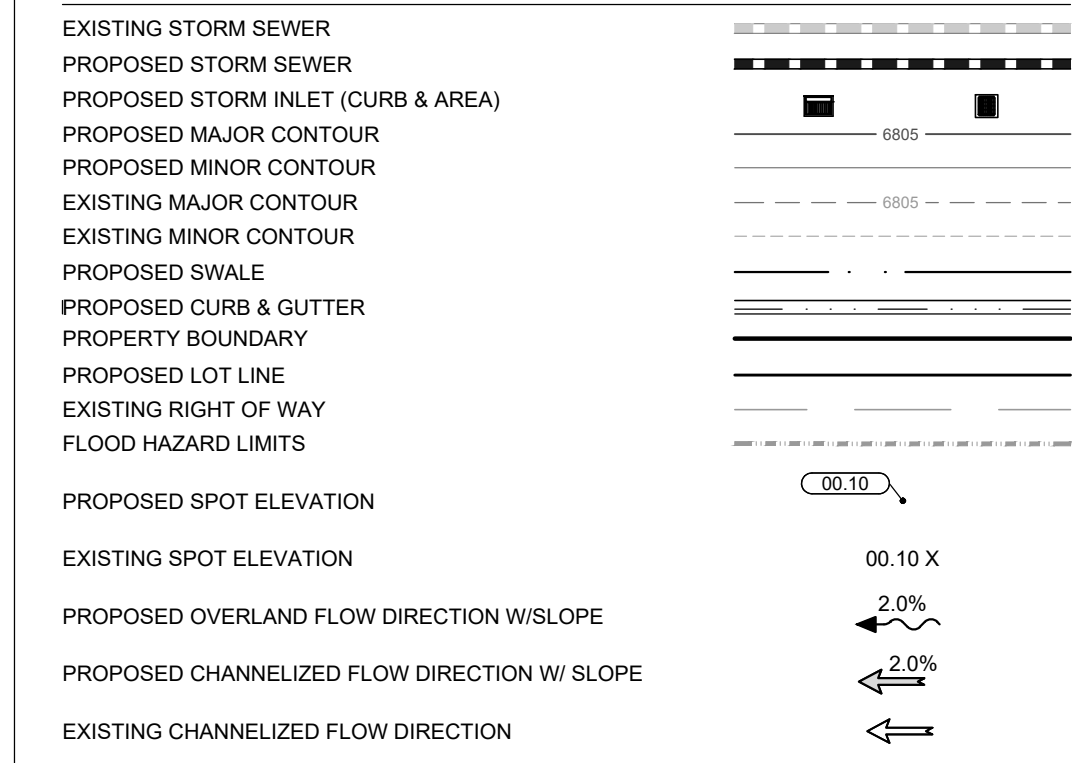

**NOTES:**

- THE SIZE, TYPE AND LOCATION OF ALL KNOWN UNDERGROUND UTILITIES ARE APPROXIMATE WHEN SHOWN ON THESE DRAWINGS. IT SHALL BE THE RESPONSIBILITY OF THE DEVELOPER TO VERIFY THE EXISTENCE OF ALL UNDERGROUND UTILITIES IN THE AREA OF THE WORK. BEFORE COMMENCING NEW CONSTRUCTION, THE CONTRACTOR SHALL BE RESPONSIBLE FOR LOCATING ALL UNDERGROUND UTILITIES AND SHALL BE RESPONSIBLE FOR ALL UNKNOWN UNDERGROUND UTILITIES.
- ALL PROJECT DATA IS ON VERTICAL DATUM; NAVD 88. SEE NOTE SHEET FOR BENCHMARK REFERENCES.
- ELEVATIONS FOR IMPROVEMENTS THAT ARE CONTROLLED BY ADJACENT EXISTING FACILITIES (SUCH AS PROPOSED GUTTERS ALONG EXISTING ASPHALT) MAY REQUIRE ADJUSTMENT BASED ON ACTUAL CONDITIONS. COORDINATE WITH ENGINEER TO ENSURE A CONSISTENT SECTION WITH SMOOTH TRANSITIONS WHERE NECESSARY.
- SEE SOILS REPORT FOR PAVEMENT, SUBGRADE AND MATERIAL PREPARATION, DESIGN AND RECOMMENDATIONS.
- ALL CURB SPOTS SHOWN ARE FLOWLINE ELEVATIONS, UNLESS NOTED OTHERWISE. ALL OTHER SPOTS ARE FINISHED GRADE ELEVATIONS.

CIVIL ENGINEERS | SURVEYORS  
141 9th Street - P.O. Box 774843  
Steamboat Springs, Colorado 80477  
(970) 871-9494  
www.LANDMARK-CD.com

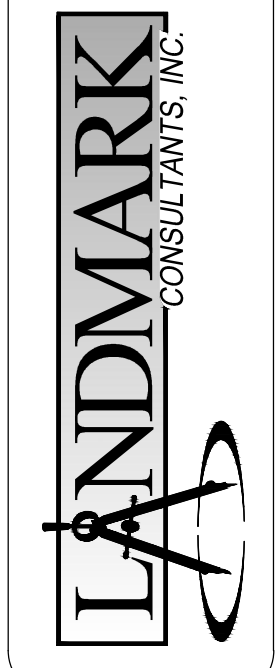

THESE DRAWINGS ARE PREPARED BY THE ENGINEER OR SURVEYOR PROVIDED BY LANDMARK CONSULTANTS, INC. AND ARE NOT TO BE USED FOR ANY OTHER PROJECT OR FOR CONSTRUCTION OR CONTRACTING UNLESS SIGNED AND SEALED BY A LICENSED PROFESSIONAL ENGINEER OR SURVEYOR EMPLOYED BY LANDMARK CONSULTANTS, INC.

NO.	DATE	BY	DESCRIPTION
1	12-3-21	mmg	Addressed DPT Comments

**REVIEW SET**  
**NOT FOR CONSTRUCTION**  
12/3/2021

PROJECT:	1012-550
DATE:	9/17/2021
CONTRACT:	Matt General
EMAIL:	mmg@landmark-co.com

WILD BLUE GONDOLA  
ROADWAY PLAN & PROFILE  
(GREEN HORN RANCH)

SHEET  
**C.311**  
OF # SHEETS

DRAWING FILENAME: P:\1012-550\Drawings\1012-550-09-C.311-Roadway Plan & Profile.dwg, PLOT DATE: 12/03/2021 2:43pm, PLOT OPERATOR: mmg  
LIST OF SHEETS: 1012-550-09-C.311-Roadway Plan & Profile.dwg, 1012-550-10-C.312-Roadway Plan & Profile.dwg, 1012-550-11-C.313-Roadway Plan & Profile.dwg