



Routt County Assessor's Office, Property Search

R8162772  
 2730 DOWNHILL PLZ, 2750 DOWNHILL  
 PLZ

**Owner:**  
 30390 DOWNHILL DR ASSOCIATION, INC  
 420 ST PAUL ST  
 DENVER, CO 80206-0000

Actual Value  
**\$90**

**KEY INFORMATION**

Account #	<b>R8162772</b>	Parcel #	<b>187377001</b>
Tax Area	<b>20SS - *RE2* SS City Limits_Old Town+Lower Fish/Tamarack Areas &amp; near</b>		
Aggregate Mill Levy	<b>41.919</b>		
Neighborhood	<b>DOWNHILL-COPPER-ELK COMM</b>		
Subdivision	<b>30390 DOWNHILL DRIVE</b>		
Legal Desc	<b>30390 DOWNHILL DRIVE COMMON AREA TOTAL 1.75A</b>		
Property Use	<b>COMMON AREA</b>		
Total Acres	<b>1.75</b>		
Owner	<b>30390 DOWNHILL DR ASSOCIATION, INC</b>		
Situs Addresses	<b>2730 DOWNHILL PLZ, 2750 DOWNHILL PLZ</b>		
Total Area SqFt	<b>-</b>		
Business Name	<b>DOWNHILL PLAZA</b>		

**ASSESSMENT DETAILS**

	<b>Actual</b>	<b>Assessed</b>
Land Value	<b>\$0</b>	<b>\$0</b>
Improvement Value	<b>\$0</b>	<b>\$0</b>
Total Value	<b>\$90</b>	<b>\$20</b>
Exempt Value	<b>-</b>	<b>\$-20</b>
Adjusted Taxable Total	<b>-</b>	<b>\$0</b>

**Most Recent Tax Liability**

<b>Current Year</b>	<b>2024</b>	<b>\$0.00</b>
<b>Prior Year</b>	<b>2023</b>	<b>\$0.00</b>

Contact the Treasurer's Office @ 970-870-5555 for exact amount due. Figures above do not reflect any processing fees, Senior/Vet exemptions, late penalties, interest or liens due. Please confirm all balances with the Treasurer prior to submitting payment, as short payments will be rejected.

**PUBLIC REMARKS**

<b>PUBLIC REMARK</b>	<b>PUBLIC REMARK DATE</b>
NW4 & SW4 SEC 6-6-84	1997-03-06 00:00:00
CORRECTED PIN FROM 187399001 TO187377001 BECAUSE IT'S A CONDO COMMON AREA. SH	2014-04-08 00:00:00
COMMON AREA TO ASSOC.	1997-03-06 00:00:00
PLAT FILE #12335/ COVENANTS 721/873	1997-03-06 00:00:00
TY2025: The assigned Tax Area ID# for this account was changed from TA-27X to TA-20SS. Action taken by the Assessor as part of a countywide research project to clean-up redundancies involving several tax areas found to contain the same Taxing Authorities	2025-07-29 00:00:00

## LAND DETAILS

### LAND OCCURRENCE 1 - COMM LAND

Property Code	<b>9145 - GEN IMPREC &amp; REC LAND</b>	Economic Area	<b>STEAMBOAT COMM</b>
Super Neighborhood	-	Neighborhood	<b>DOWNHILL - COPPER - ELK</b>
Land Code	<b>COMMON AREA</b>	Land Use	<b>PRIME SITE</b>
Zoning	<b>I</b>	Site Access	<b>YEAR-ROUND</b>
Road	<b>PAVED</b>	Site View	<b>AVERAGE</b>
Topography	<b>LEVEL</b>	Slope	<b>NOT AFFECTED</b>
Wetness	<b>NOT AFFECTED</b>	Water	<b>COMM/PUBLIC</b>
Utilities	<b>GAS/ELEC</b>	Sewer	<b>COMM/PUBLIC</b>
Acres	<b>1.75</b>	Description	-

## BUILDINGS

### EXTRA FEATURES / OUTBUILDINGS

No data to display

## TRANSFER HISTORY

[View Recorded Transfer Documents Here](#)

	<b>RECORDING DATE</b>	<b>REC. #</b>	<b>BOOK</b>	<b>PAGE</b>	<b>DEED TYPE</b>	<b>SALE DATE</b>	<b>SALE PRICE</b>
+	06/18/1996	464220	721	897	BSD	06/18/1996	\$0

Appraiser Public Remarks	-
Grantor	<b>LIMAN, LES A.</b>
Grantee	<b>30390 DOWNHILL DR ASSOCIATION, INC</b>

## TAX AUTHORITIES

TAX AREA	TAX AUTHORITY ENTITY	AUTHORITY TYPE	2024 LEVY BY ENTITY	2024 TAX AREA LEVY	ENTITY % OF TAX BILL	ESTIMATED AD VALOREM TAX
20SS	CITY OF STEAMBOAT SPRINGS	Home Rule Municipalities	2	41.919	4.77%	\$0
20SS	COLORADO MOUNTAIN COLLEGE	Local District College	3.23	41.919	7.71%	\$0
20SS	COLORADO RIVER WATER CONSERVATION DISTRICT	Water Conservancy	0.501	41.919	1.20%	\$0
20SS	EAST ROUTT REGIONAL LIBRARY DIST	Library Districts	2.798	41.919	6.67%	\$0
20SS	ROUTT COUNTY GOVERNMENT	County	13.913	41.919	33.19%	\$0
20SS	STEAMBOAT SPRINGS CEMETERY DISTRICT	Cemetery Districts	0.063	41.919	0.15%	\$0
20SS	STEAMBOAT SPRINGS SCHOOL DISTRICT (RE-2)	School Districts	16.594	41.919	39.59%	\$0
20SS	UPPER YAMPA WATER CONSERVATION DISTRICT	Water Conservancy	1.82	41.919	4.34%	\$0
20SS	YAMPA VALLEY HOUSING AUTHORITY	Housing Authorities (Municipal)	1	41.919	2.39%	\$0

### PRIOR YEAR ASSESSMENT INFORMATION

*YEAR	ACTUAL VALUE	ASSESSED VALUE	MILL LEVY	AD VALOREM TAXES
2024	\$90	\$30	41.92	\$0.00
2023	\$90	\$30	40.56	\$0.00
2022	\$90	\$0	55.20	\$0.00
2021	\$90	\$0	54.62	\$0.00
2020	\$90	\$0	54.24	\$0.00
2019	\$90	\$0	52.90	\$0.00
2018	\$90	\$0	49.90	\$0.00
2017	\$90	\$0	49.28	\$0.00
2016	\$90	\$0	45.48	\$0.00

Contact the Treasurer's Office for current property tax amount due. Do not use the figures above to pay outstanding property taxes.

\* 2024 assessment values reported above represent the assessor's appraised value less any Legislative discounts applied for SB24-233 & SB24B-1001 - Typically a \$55,000 Residential Actual Value credit and/or a \$30,000 Commercial Improvement Actual Value credit depending on the classification of the property. The 2023 values listed were subject to the same discounts under Legislative bills SB22-238 & SB23B-001.



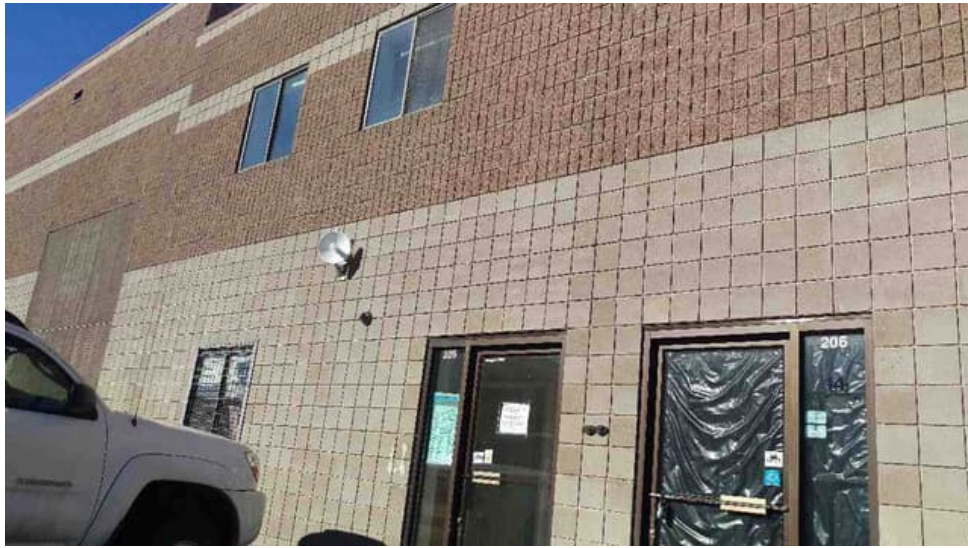



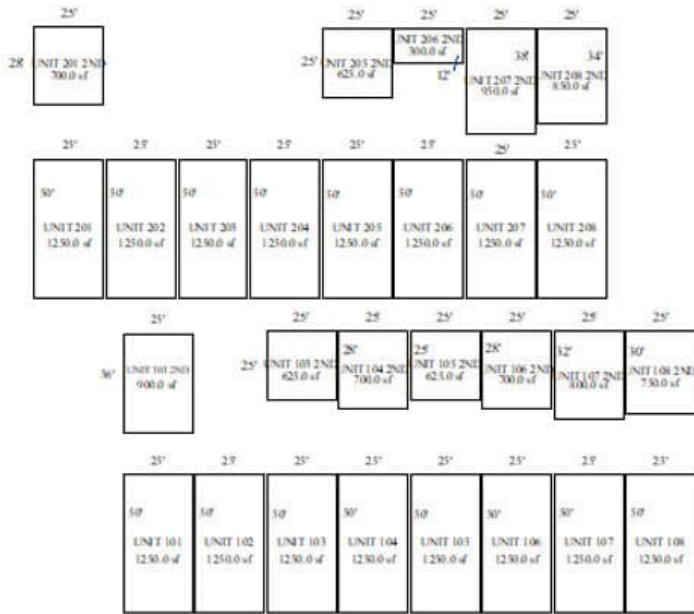

© 2025 by Apex Building, LLC

Data last updated: 10/24/2025