



Routt County Assessor's Office, Property Search

R8164099
2800 DOWNHILL PLZ

Owner:
30390 DOWNHILL DRIVE OWNERS ASSOC.,
INC.
420 ST PAUL ST
DENVER, CO 80206-0000

Actual Value
\$40

KEY INFORMATION

Account #	R8164099	Parcel #	205577001
Tax Area	20SS - *RE2* SS City Limits_Old Town+Lower Fish/Tamarack Areas & near		
Aggregate Mill Levy	41.919		
Neighborhood	DOWNHILL-COPPER-ELK COMM		
Subdivision	2800 DOWNHILL PLAZA		
Legal Desc	COMMON AREA, 2800 DOWNHILL PLAZA		
Property Use	COMMON AREA		
Total Acres	0.75		
Owner	30390 DOWNHILL DRIVE OWNERS ASSOC., INC.		
Situs Addresses	2800 DOWNHILL PLZ		
Total Area SqFt	-		
Business Name	DOWNHILL PLAZA		

ASSESSMENT DETAILS

	Actual	Assessed
Land Value	\$0	\$0
Improvement Value	\$0	\$0
Total Value	\$40	\$10
Exempt Value	-	\$-10
Adjusted Taxable Total	-	\$0

Most Recent Tax Liability

Current Year	2024	\$0.00
Prior Year	2023	\$0.00

Contact the Treasurer's Office @ 970-870-5555 for exact amount due. Figures above do not reflect any processing fees, Senior/Vet exemptions, late penalties, interest or liens due. Please confirm all balances with the Treasurer prior to submitting payment, as short payments will be rejected.

PUBLIC REMARKS

PUBLIC REMARK	PUBLIC REMARK DATE
COVENANTS: 721/873SUPPLEMENTAL: 753/311	1998-12-29 00:00:00
COMMON EXPENSE LIABILITY FOR THE UNIT IS 4.1667%.	1998-12-29 00:00:00
TY2025: The assigned Tax Area ID# for this account was changed from TA-27X to TA-20SS. Action taken by the Assessor as part of a countywide research project to clean-up redundancies involving several tax areas found to contain the same Taxing Authorities.	2025-07-29 00:00:00

LAND DETAILS

LAND OCCURRENCE 1 - COMM LAND

Property Code	9198 - MISC OTHER LAND	Economic Area	STEAMBOAT COMM
Super Neighborhood	-	Neighborhood	DOWNHILL - COPPER - ELK
Land Code	COMMON AREA	Land Use	PRIME SITE
Zoning	I	Site Access	YEAR-ROUND
Road	PAVED	Site View	AVERAGE
Topography	LEVEL	Slope	NOT AFFECTED
Wetness	NOT AFFECTED	Water	COMM/PUBLIC
Utilities	GAS/ELEC	Sewer	COMM/PUBLIC
Acres	0.75	Description	-

BUILDINGS

EXTRA FEATURES / OUTBUILDINGS

No data to display

TRANSFER HISTORY

[View Recorded Transfer Documents Here](#)

	RECORDING DATE	REC. #	BOOK	PAGE	DEED TYPE	SALE DATE	SALE PRICE
+	12/09/1998	503173	753	312	BSD	12/09/1998	\$0

Appraiser Public Remarks	-
Grantor	LIMAN, LES A.
Grantee	30390 DOWNHILL DRIVE OWNERS ASSOCIATION

TAX AUTHORITIES

TAX AREA	TAX AUTHORITY ENTITY	AUTHORITY TYPE	2024 LEVY BY ENTITY	2024 TAX AREA LEVY	ENTITY % OF TAX BILL	ESTIMATED AD VALOREM TAX
20SS	CITY OF STEAMBOAT SPRINGS	Home Rule Municipalities	2	41.919	4.77%	\$0
20SS	COLORADO MOUNTAIN COLLEGE	Local District College	3.23	41.919	7.71%	\$0
20SS	COLORADO RIVER WATER CONSERVATION DISTRICT	Water Conservancy	0.501	41.919	1.20%	\$0
20SS	EAST ROUTT REGIONAL LIBRARY DIST	Library Districts	2.798	41.919	6.67%	\$0
20SS	ROUTT COUNTY GOVERNMENT	County	13.913	41.919	33.19%	\$0
20SS	STEAMBOAT SPRINGS CEMETERY DISTRICT	Cemetery Districts	0.063	41.919	0.15%	\$0
20SS	STEAMBOAT SPRINGS SCHOOL DISTRICT (RE-2)	School Districts	16.594	41.919	39.59%	\$0
20SS	UPPER YAMPA WATER CONSERVATION DISTRICT	Water Conservancy	1.82	41.919	4.34%	\$0
20SS	YAMPA VALLEY HOUSING AUTHORITY	Housing Authorities (Municipal)	1	41.919	2.39%	\$0

PRIOR YEAR ASSESSMENT INFORMATION

*YEAR	ACTUAL VALUE	ASSESSED VALUE	MILL LEVY	AD VALOREM TAXES
2024	\$40	\$10	41.92	\$0.00
2023	\$40	\$10	40.56	\$0.00
2022	\$40	\$0	55.20	\$0.00
2021	\$40	\$0	54.62	\$0.00
2020	\$40	\$0	54.24	\$0.00
2019	\$40	\$0	52.90	\$0.00
2018	\$40	\$0	49.90	\$0.00
2017	\$40	\$0	49.28	\$0.00
2016	\$40	\$0	45.48	\$0.00

Contact the Treasurer's Office for current property tax amount due. Do not use the figures above to pay outstanding property taxes.

* 2024 assessment values reported above represent the assessor's appraised value less any Legislative discounts applied for SB24-233 & SB24B-1001 - Typically a \$55,000 Residential Actual Value credit and/or a \$30,000 Commercial Improvement Actual Value credit depending on the classification of the property. The 2023 values listed were subject to the same discounts under Legislative bills SB22-238 & SB23B-001.

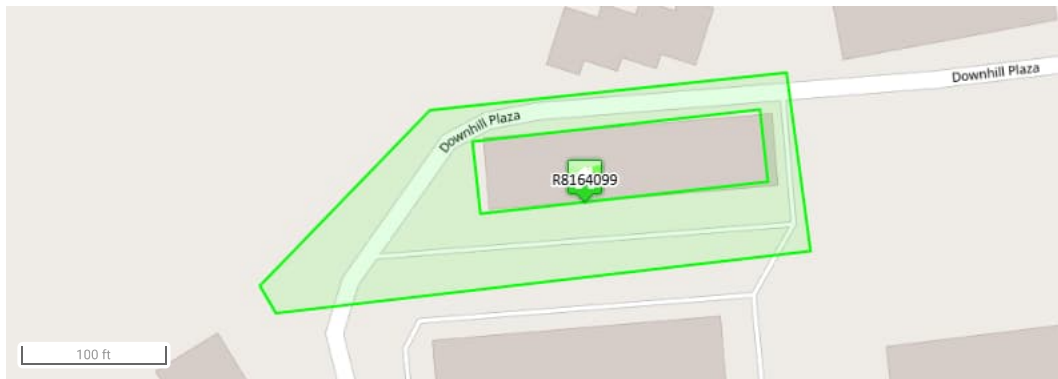

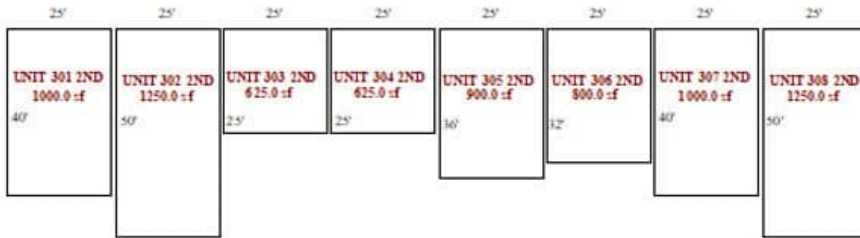
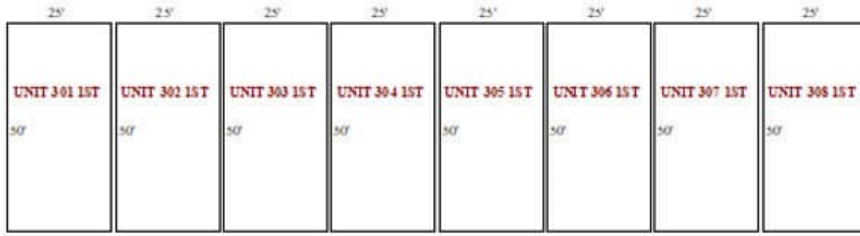

Model by Apex Models of Pro™

Data last updated: 10/24/2025