

CALL UTILITY NOTIFICATION CENTER OF
COLORADO

811

Know what's below.
Call before you dig.

CALL 2 BUSINESS DAYS IN ADVANCE BEFORE YOU
DIG, GRADE, OR EXCAVATE FOR THE MARKING OF
UNDERGROUND MEMBER UTILITIES.

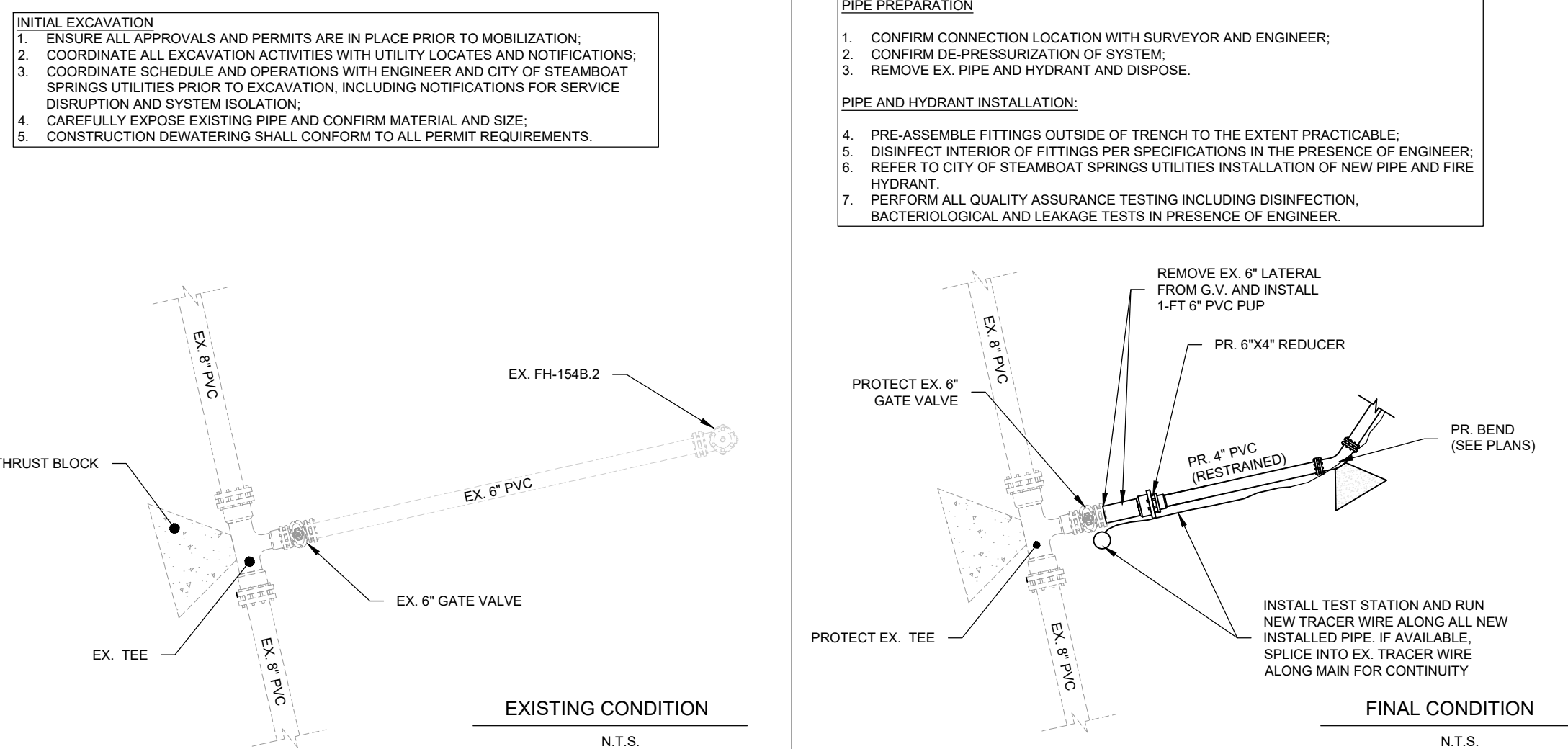
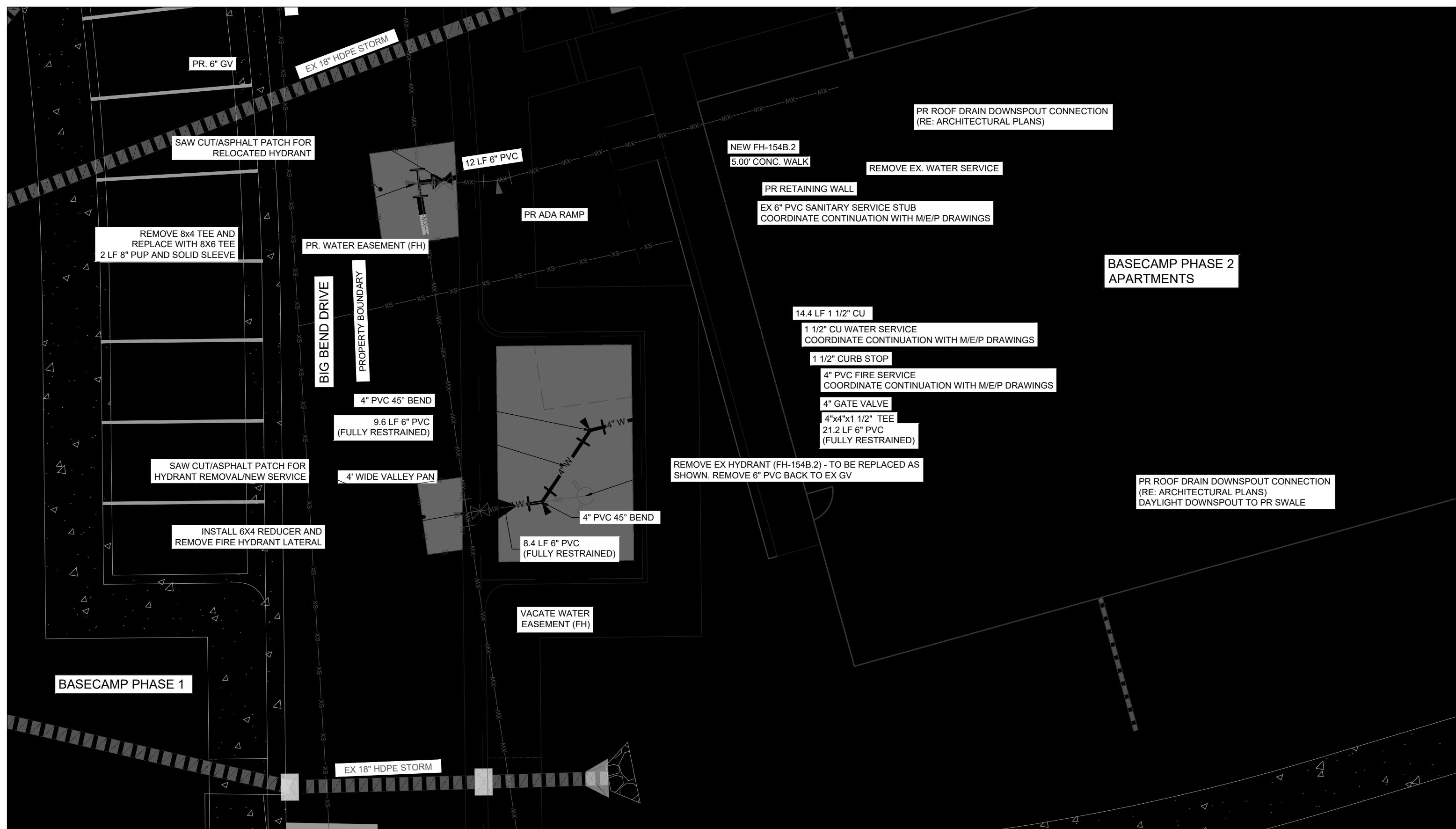

LOT 3 F.H. REMOVAL AND NEW WATER SERVICE EXHIBIT
(NOT INTENDED TO DICTATE CONTRACTOR MEANS & METHODS)



PROPOSED SANITARY SEWER W/ MH & C.O.

PROPOSED WATER

PROPOSED GV, FH & CS

PROPOSED STORM SEWER W/ FLARED END SECTION

PROPOSED STORM INLET (CURB & AREA)

PROPOSED STORM MANHOLE & CLEANOUT

EXISTING MAJOR CONTOUR

EXISTING MINOR CONTOUR

PROPOSED MAJOR CONTOUR

PROPOSED MINOR CONTOUR

PROPOSED SWALE

PROPOSED CURB & GUTTER

PROPERTY BOUNDARY

SPOT ELEVATION

The plan view shows a sanitary sewer line with a manhole (MH) and cleanout (C.O.). The sewer line is shown with a flared end section. The plan also includes property boundaries, existing and proposed contours, and a proposed swale. A spot elevation is shown at the bottom right. The plan is oriented with North at the top.

STORM SEWER FLOW DIRECTION ←

1. THE SIZE, TYPE AND LOCATION OF ALL KNOWN UNDERGROUND UTILITIES ARE APPROXIMATE WHEN SHOWN ON THESE DRAWINGS. IT SHALL BE THE RESPONSIBILITY OF THE DEVELOPER TO VERIFY THE EXISTENCE OF ALL UNDERGROUND UTILITIES IN THE AREA OF THE WORK. BE COMMENCING NEW CONSTRUCTION, THE CONTRACTOR SHALL BE RESPONSIBLE FOR LOCATING ALL UNDERGROUND UTILITIES AND SHALL BE RESPONSIBLE FOR FOR ALL UNKNOWN UNDERGROUND UTILITIES.

2. PROJECT BENCHMARK: A RECOVERED NO 5 REBAR W/ ALUMINUM CAP STAMPED "LS 29039 (HAVING AN ELEVATION OF 6667.80' BASED ON THE NORTH AMERICAN VERTICAL DATUM OF (NAVD88) AS SHOWN HEREON.
3. ELEVATIONS FOR IMPROVEMENTS THAT ARE CONTROLLED BY ADJACENT EXISTING FACILITIES (SUCH AS PROPOSED GUTTERS ALONG EXISTING ASPHALT) MAY REQUIRE ADJUSTMENT TO REFLECT ACTUAL CONDITIONS. COORDINATE WITH ENGINEER TO ENSURE A CONSISTENT SECTION WITHIN EACH TENSILE MEMBER IS NECESSARY.

4. SEE SOILS REPORT FOR PAVEMENT, SUBGRADE AND MATERIAL PREPARATION, DESIGN AND RECOMMENDATIONS.

5. ALL CURB SPOTS SHOWN ARE FLOWLINE ELEVATIONS, UNLESS NOTED OTHERWISE. ALL C

6. EXISTING UNDERGROUND AND OVERHEAD PUBLIC AND PRIVATE UTILITIES AS SHOWN ARE INDICATED ACCORDING TO THE BEST INFORMATION MADE AVAILABLE TO THE ENGINEER. ENGINEER DOES NOT GUARANTEE NOR IS RESPONSIBLE FOR THE ACCURACY OF SUCH INFORMATION. EXISTING UTILITY MAINS AND SERVICES MAY NOT BE STRAIGHT LINES OR INDICATED ON THESE DRAWINGS. CONTRACTOR TO VERIFY EXISTING HORIZONTAL AND VERTICAL LOCATIONS PRIOR TO CONSTRUCTION.

7. ALL SEWER CONSTRUCTION SHALL BE PER CITY OF STEAMBOAT SPRINGS STANDARD SPECIFICATIONS, LATEST EDITION.

8. MAINTAIN 10' HORIZONTAL AND 18" VERTICAL MINIMUM SEPARATION BETWEEN ALL SANITARY SEWER MAINS, WATER MAINS & SERVICES

9. MANHOLES LOCATED OUTSIDE OF THE ROADWAY SHALL PROTRUDE 1' ABOVE EXISTING GROUND SURFACE TO DRAIN AROUND/AWAY FROM MANHOLE RINGS.

10. ALL MANHOLES LOCATED IN THE ROADWAY SHALL HAVE RIM ELEVATIONS ADJUSTED TO 1/2" BELOW FINISHED GRADE. IF NECESSARY, CONE SECTIONS SHALL BE ROTATED TO PREVENT LIDS BEING LOCATED WITHIN VEHICLE OR BICYCLE WHEEL PATHS.

11. SEWER SERVICE SHALL HAVE A MINIMUM OF 4-FT OF COVER.

13. ALL WATER PIPE SHALL BE INSTALLED WITH A #10 SOLID COPPER WIRE COATED WITH 45 M

POLYETHYLENE FOR LOCATING PURPOSES. "GLENN TEST STATIONS" BY VALVCO, INC TR
WIRE TEST STATIONS SHALL BE INSTALLED ADJACENT TO ALL FIRE HYDRANTS. ADDITION
LOCATIONS MAY BE REQUIRED.

14. ALL MATERIALS USED FOR BACKFILL SHALL BE FREE FROM REFUSE ORGANIC MATERIAL, COBBLES, BOULDERS, LARGE ROCKS OR STONES OR FROZEN SOILS GREATER THAN 6-INCH DIAMETER.

15. BEDDING AND SHADING MATERIALS SHALL ONLY BE 3/4-INCH WASHED OR SCREENED ROCK OR 3/4-INCH MINUS, SQUEEGEE OR REJECT SAND, OR CLASS 6 AGGREGATE BASE COURSE IS ALLOWED.



Know what's below.
Call before you dig

CALL 2 BUSINESS DAYS IN ADVANCE BEFORE YOU
DIG, GRADE, OR EXCAVATE FOR THE MARKING OF
UNDERGROUND MEMBER UTILITIES.



SEE SHEET C.200

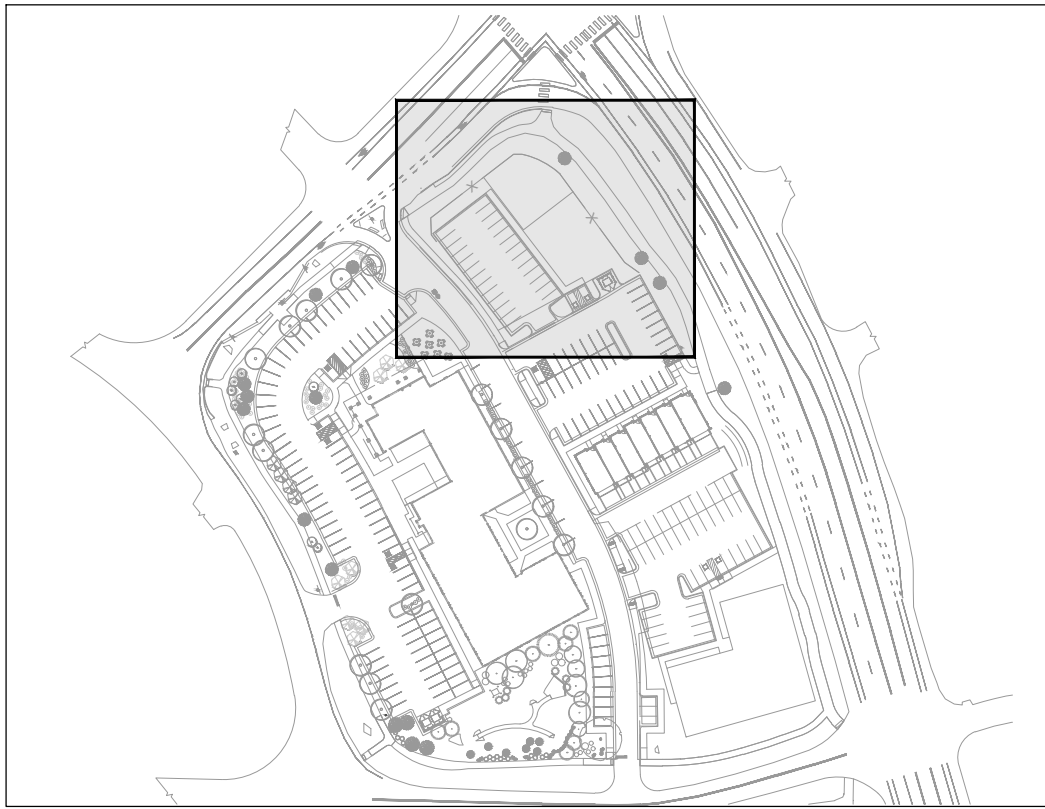
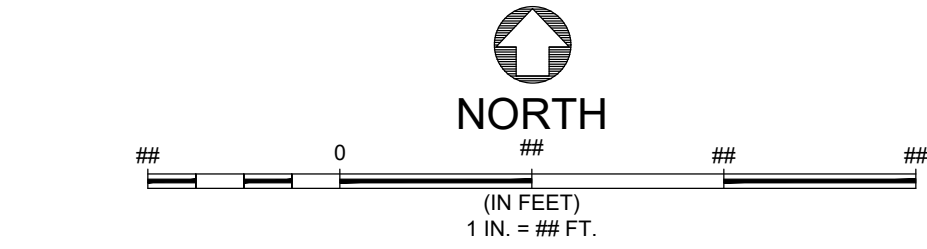
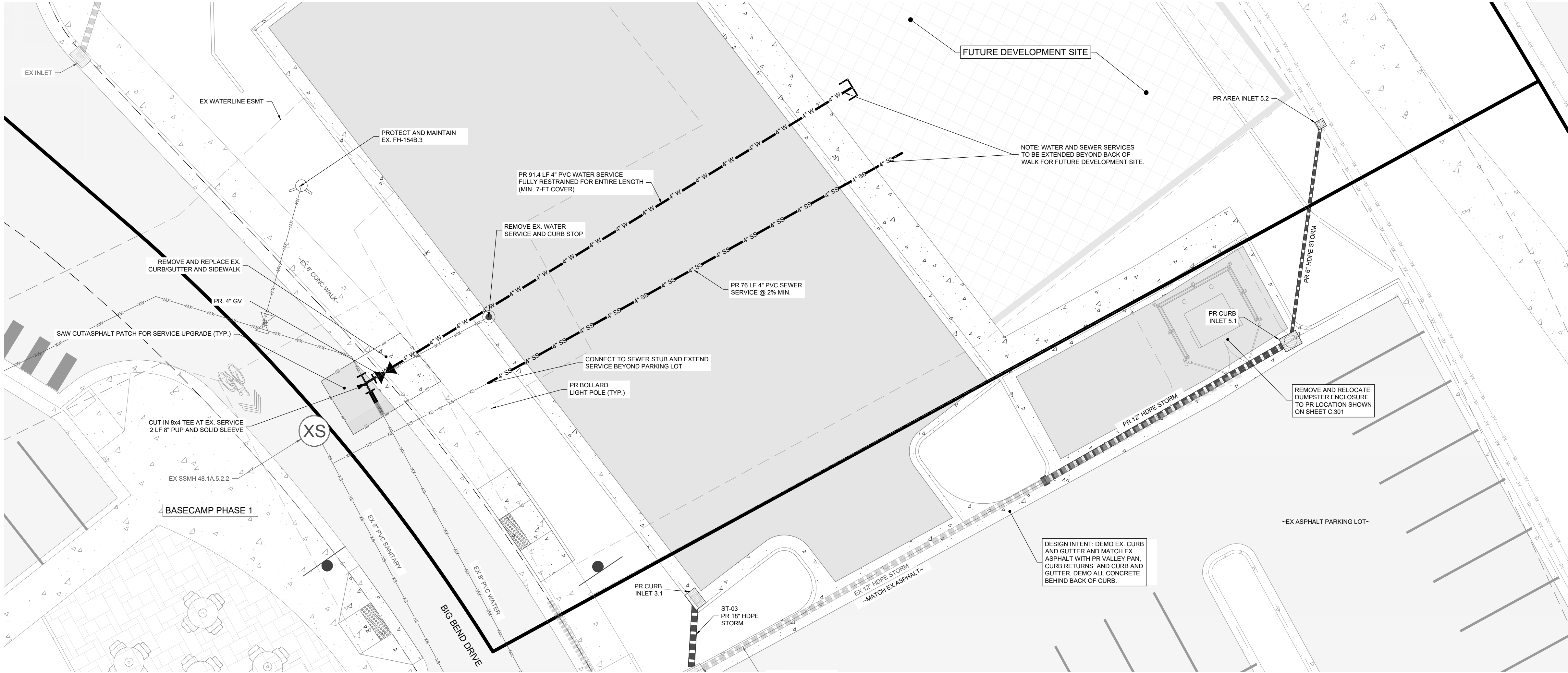

LEGEND:

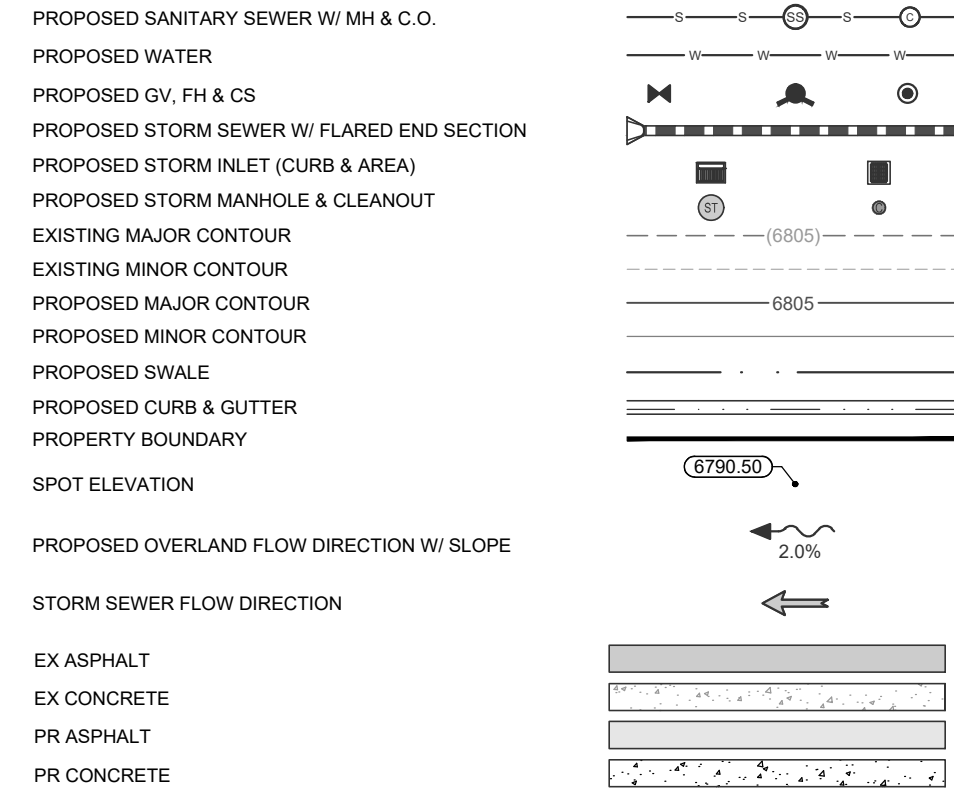

NOTES:

- THE SIZE, TYPE AND LOCATION OF ALL KNOWN UNDERGROUND UTILITIES ARE APPROXIMATE WHEN SHOWN ON THESE DRAWINGS. IT SHALL BE THE RESPONSIBILITY OF THE DEVELOPER TO VERIFY THE EXISTENCE OF ALL UNDERGROUND UTILITIES IN THE AREA OF THE WORK. BEFORE COMMENCING NEW CONSTRUCTION, THE CONTRACTOR SHALL BE RESPONSIBLE FOR LOCATING ALL UNDERGROUND UTILITIES AND SHALL BE RESPONSIBLE FOR ALL UNKNOWN UNDERGROUND UTILITIES.
- PROJECT BENCHMARK: A RECOVERED NO. 5 REBAR W/ ALUMINUM CAP STAMPED "LS 29039" HAVING AN ELEVATION OF 6667.80' BASED ON THE NORTH AMERICAN VERTICAL DATUM OF 1988 (NAVD83) AS SHOWN HEREON.
- ELEVATIONS FOR IMPROVEMENTS THAT ARE CONTROLLED BY ADJACENT EXISTING FACILITIES (SUCH AS PROPOSED GUTTERS ALONG EXISTING ASPHALT) MAY REQUIRE ADJUSTMENT BASED ON ACTUAL CONDITIONS. COORDINATE WITH ENGINEER TO ENSURE A CONSISTENT SECTION WITH SMOOTH TRANSITIONS WHERE NECESSARY.
- SEE SOILS REPORT FOR PAVEMENT, SUBGRADE AND MATERIAL PREPARATION, DESIGN AND RECOMMENDATIONS.
- ALL CURB SPOTS SHOWN ARE FLOWLINE ELEVATIONS. UNLESS NOTED OTHERWISE, ALL OTHER SPOTS ARE FINISHED GRADE ELEVATIONS.
- EXISTING UNDERGROUND AND OVERHEAD PUBLIC AND PRIVATE UTILITIES AS SHOWN ARE INDICATED ACCORDING TO THE BEST INFORMATION MADE AVAILABLE TO THE ENGINEER. THE ENGINEER DOES NOT GUARANTEE NOR IS RESPONSIBLE FOR THE ACCURACY OF SUCH INFORMATION. EXISTING UTILITY MAINS AND SERVICES MAY NOT BE STRAIGHT LINES OR AS INDICATED ON THESE DRAWINGS. CONTRACTOR TO VERIFY EXISTING HORIZONTAL AND VERTICAL LOCATIONS PRIOR TO CONSTRUCTION.
- ALL SEWER CONSTRUCTION SHALL BE PER CITY OF STEAMBOAT SPRINGS STANDARD SPECIFICATIONS, LATEST EDITION.
- MAINTAIN 10' HORIZONTAL AND 18" VERTICAL MINIMUM SEPARATION BETWEEN ALL SANITARY SEWER MAINS, WATER MAINS & SERVICES.
- MANHOLES LOCATED OUTSIDE OF THE ROADWAY SHALL PROTRUDE 1' ABOVE EXISTING GRADE TO REDUCE INFILTRATION. GRADE SURFACE TO DRAIN AROUND/AWAY FROM MANHOLE RIMS.
- ALL MANHOLES LOCATED IN THE ROADWAY SHALL HAVE RIM ELEVATIONS ADJUSTED TO 1" BELOW FINISHED GRADE. IF NECESSARY, CONE SECTIONS SHALL BE ROTATED TO PREVENT LIDS BEING LOCATED WITHIN VEHICLE OR BICYCLE WHEEL PATHS.
- SEWER SERVICE SHALL HAVE A MINIMUM OF 4-FT OF COVER.
- WATER SERVICE SHALL HAVE A MINIMUM OF 7-FT OF COVER.
- ALL WATER PIPE SHALL BE INSTALLED WITH A #10 SOLID COPPER WIRE COATED WITH 48 MIL. POLYETHYLENE FOR LOCATING PURPOSES. "GLEAN" TEST STATIONS BY VALVOO, INC. TRACER WIRE TEST STATIONS SHALL BE INSTALLED ADJACENT TO ALL FIRE HYDRANTS. ADDITIONAL LOCATIONS MAY BE REQUIRED.
- ALL MATERIALS USED FOR BACKFILL SHALL BE FREE FROM REFUSE ORGANIC MATERIAL, COBBLES, BOULDERS, LARGE ROCKS OR STONES OR FROZEN SOILS GREATER THAN 6-INCHES IN DIAMETER.
- BEDDING AND SHADING MATERIALS SHALL ONLY BE 3/4-INCH WASHED OR SCREENED ROCK, 3/4-INCH MINUS, SQUEEGEE OR REJECT SAND, OR CLASS 5 AGGREGATE BASE COURSE IS NOT ALLOWED.

LOT 2 WATER SERVICE REPLACEMENT EXHIBIT
(NOT INTENDED TO DICTATE CONTRACTOR MEANS & METHODS)

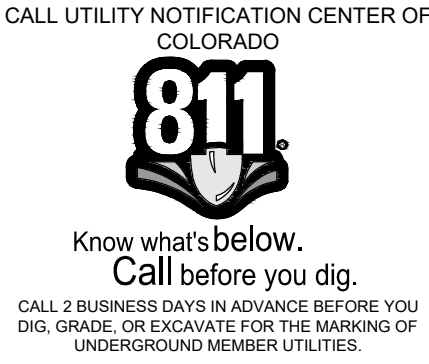
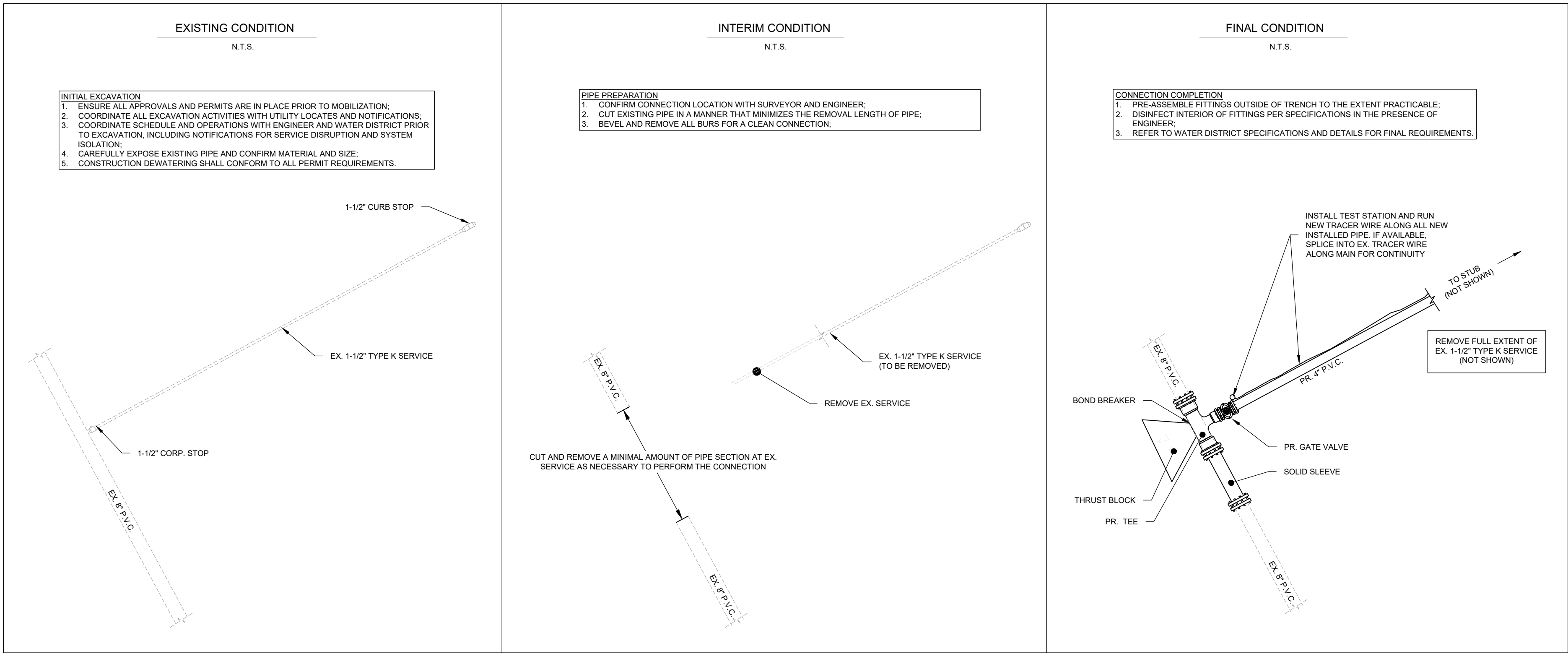

Basecamp Phase 2 Apartments

Lot 2
Water and Sewer Plan

SHEET
C.202

LANDMARK CONSULTANTS, INC.
CIVIL ENGINEERS | SURVEYORS
141 9th Street - P.O. Box 774943, Steamboat Springs, CO 80477
(970) 871-9494 - www.LANDMARK-CO.com

REVIEW SET
NOT FOR CONSTRUCTION

NO.	DATE	BY	DESCRIPTION
1	9/9/25	EG	Addressed DRT Comments
2	9/30/25	EG	Rev. Lot 2, Misc

PROJECT:	2387-008
DATE:	9/30/25
CONTACT:	Erin Giesbrecht
EMAIL:	erag@landmark-co.com

SEE SHEET C.301

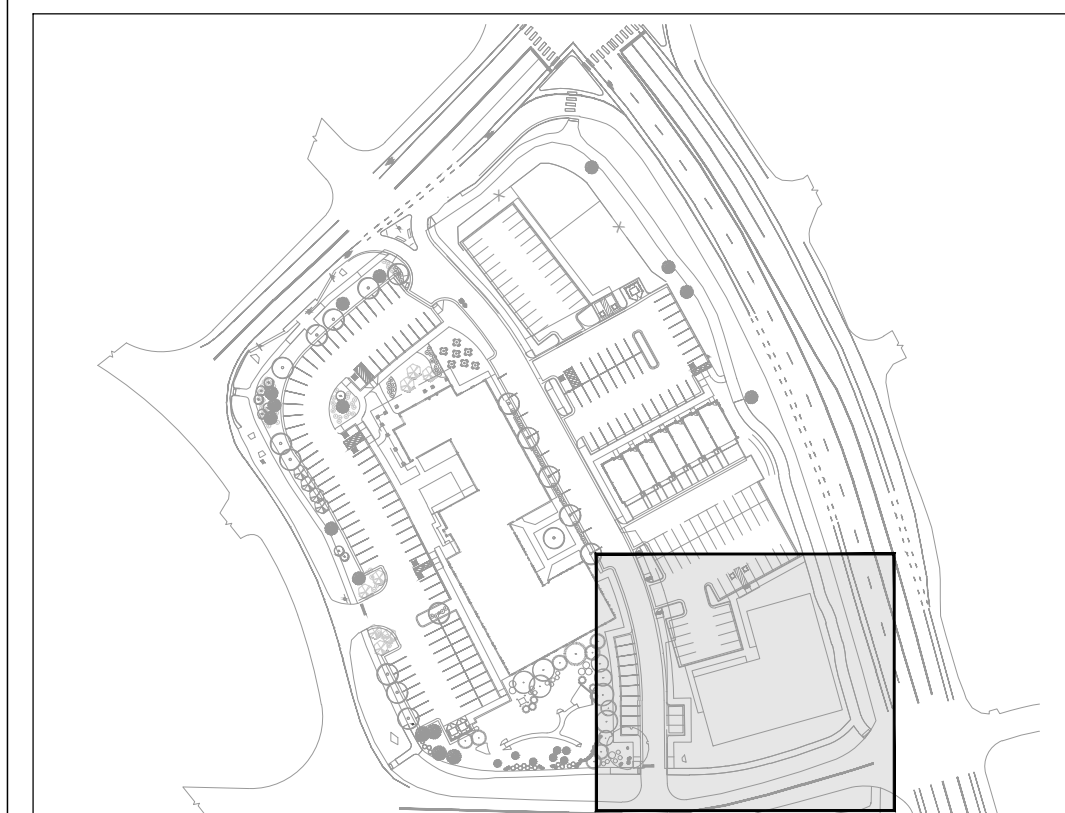
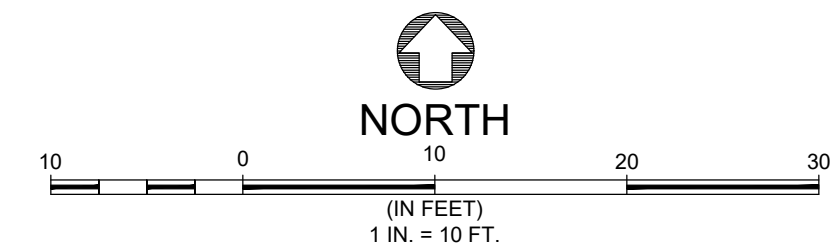
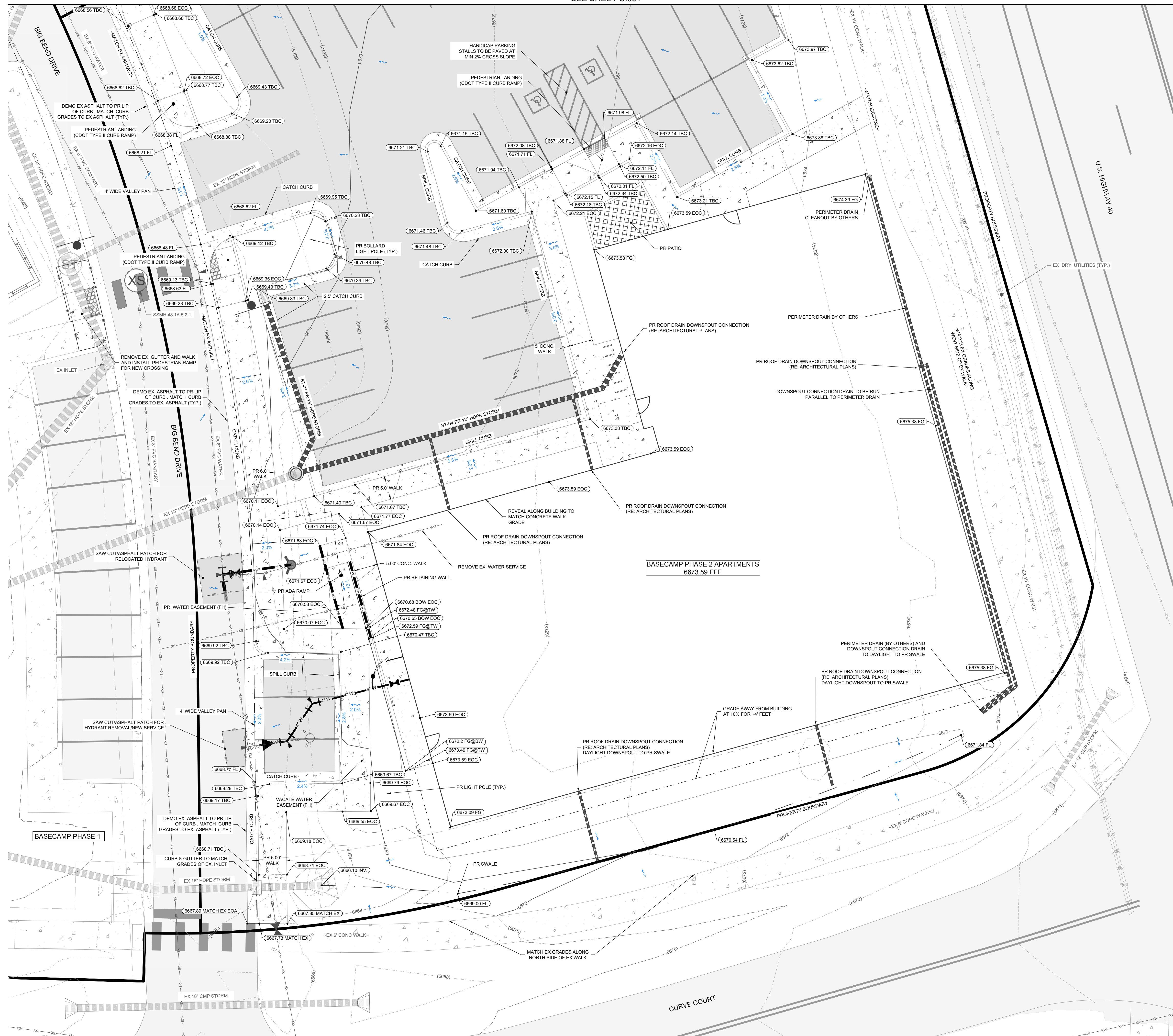

LEGEND:

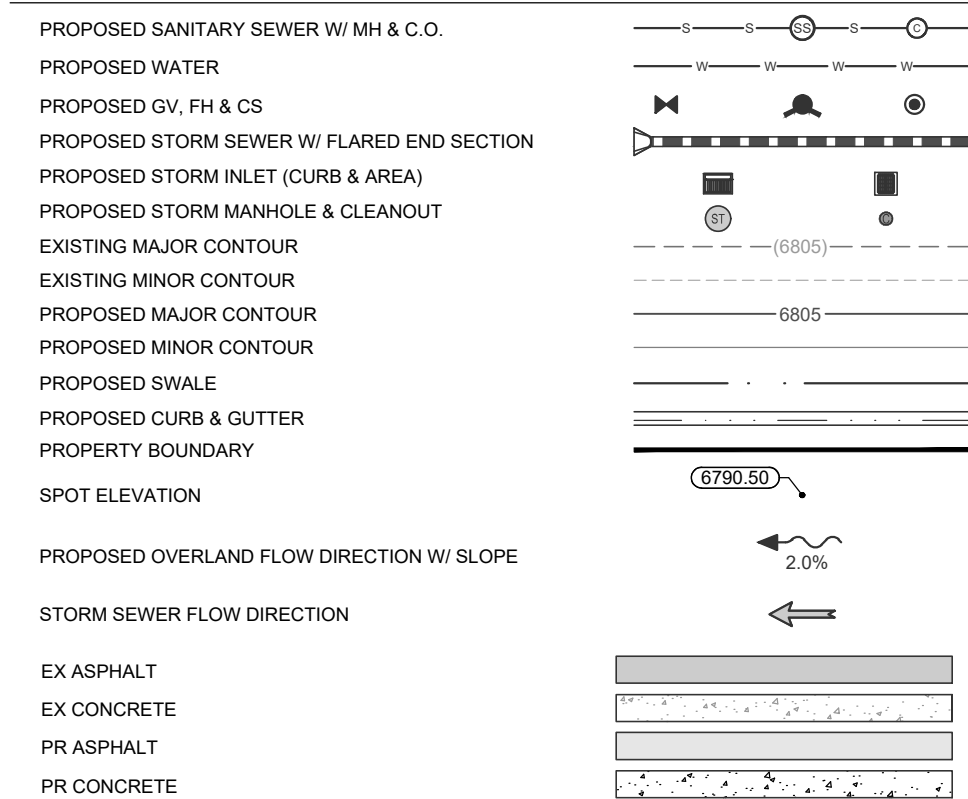

NOTES:

1. THE SIZE, TYPE AND LOCATION OF ALL KNOWN UNDERGROUND UTILITIES ARE APPROXIMATE WHEN SHOWN ON THESE DRAWINGS. IT SHALL BE THE RESPONSIBILITY OF THE DEVELOPER TO VERIFY THE EXISTENCE OF ALL UNDERGROUND UTILITIES IN THE AREA OF THE WORK. BEFORE COMMENCING NEW CONSTRUCTION, THE CONTRACTOR SHALL BE RESPONSIBLE FOR LOCATING ALL UNDERGROUND UTILITIES AND SHALL BE RESPONSIBLE FOR ALL UNKNOWN UNDERGROUND UTILITIES.
2. PROJECT BENCHMARK: A RECOVERED NO. 5 REBAR W/ ALUMINUM CAP STAMPED 'LS 29039' HAVING AN ELEVATION OF 6667.80' BASED ON THE NORTH AMERICAN VERTICAL DATUM OF 1988 (NAVD83) AS SHOWN HEREON.
3. ELEVATIONS FOR IMPROVEMENTS THAT ARE CONTROLLED BY ADJACENT EXISTING FACILITIES (SUCH AS PROPOSED GUTTERS ALONG EXISTING ASPHALT) MAY REQUIRE ADJUSTMENT BASED ON ACTUAL CONDITIONS. COORDINATE WITH ENGINEER TO ENSURE A CONSISTENT SECTION WITH SMOOTH TRANSITIONS WHERE NECESSARY.
4. SEE SOILS REPORT FOR PAVEMENT, SUBGRADE AND MATERIAL PREPARATION, DESIGN AND RECOMMENDATIONS.
5. ALL CURB SPOTS SHOWN ARE FLOWLINE ELEVATIONS. UNLESS NOTED OTHERWISE, ALL OTHER SPOTS ARE FINISHED GRADE ELEVATIONS.
6. EXISTING UNDERGROUND AND OVERHEAD PUBLIC AND PRIVATE UTILITIES AS SHOWN ARE INDICATED ACCORDING TO THE BEST INFORMATION MADE AVAILABLE TO THE ENGINEER. THE ENGINEER DOES NOT GUARANTEE NOR IS RESPONSIBLE FOR THE ACCURACY OF SUCH INFORMATION. EXISTING UTILITY MAINS AND SERVICES MAY NOT BE STRAIGHT LINES OR AS INDICATED ON THESE DRAWINGS. CONTRACTOR TO VERIFY EXISTING HORIZONTAL AND VERTICAL LOCATIONS PRIOR TO CONSTRUCTION.
7. ALL SEWER CONSTRUCTION SHALL BE PER CITY OF STEAMBOAT SPRINGS STANDARD SPECIFICATIONS, LATEST EDITION.
8. MAINTAIN 10' HORIZONTAL AND 18" VERTICAL MINIMUM SEPARATION BETWEEN ALL SANITARY SEWER MAINS, WATER MAINS & SERVICES.
9. MANHOLES LOCATED OUTSIDE OF THE ROADWAY SHALL PROTRUDE 1' ABOVE EXISTING GRADE TO REDUCE INFILTRATION. GRADE SURFACE TO DRAIN AWAY FROM MANHOLE RIMS.
10. ALL MANHOLES LOCATED IN THE ROADWAY SHALL HAVE RIM ELEVATIONS ADJUSTED TO 1/2" BELOW FINISHED GRADE. IF NECESSARY, CONE SECTIONS SHALL BE ROTATED TO PREVENT LIDS BEING LOCATED WITHIN VEHICLE OR BICYCLE WHEEL PATHS.
11. SEWER SERVICE SHALL HAVE A MINIMUM OF 4'-FT OF COVER.
12. WATER SERVICE SHALL HAVE A MINIMUM OF 7'-FT OF COVER.
13. ALL WATER PIPE SHALL BE INSTALLED WITH A #10 SOLID COPPER WIRE COATED WITH 48 MIL POLYETHYLENE FOR LOCATING PURPOSES. 'GLENN TEST STATIONS' BY VALVCO, INC. TRACER WIRE TEST STATIONS SHALL BE INSTALLED ADJACENT TO ALL FIRE HYDRANTS. ADDITIONAL LOCATIONS MAY BE REQUIRED.
14. ALL MATERIALS USED FOR BACKFILL SHALL BE FREE FROM REFUSE ORGANIC MATERIAL, COBBLES, BOULDERS, LARGE ROCKS OR STONES OR FROZEN SOILS GREATER THAN 6-INCHES IN DIAMETER.
15. BEDDING AND SHADING MATERIALS SHALL ONLY BE 3/4-INCH WASHED OR SCREENED ROCK, 3/4-INCH MINUS, SQUEEZES OR REJECT SAND, OR CLASS 5 AGGREGATE BASE COURSE IS NOT ALLOWED.

CALL UTILITY NOTIFICATION CENTER OF COLORADO



Know what's below.
Call before you dig.

CALL 2 BUSINESS DAYS IN ADVANCE BEFORE YOU DIG, GRADE, OR EXCAVATE FOR THE MARKING OF UNDERGROUND MEMBER UTILITIES.

These drawings are instruments of service provided by Landmark Consultants, Inc. and are not to be used for any type of construction or contracting unless signed and sealed by a Professional Engineer in the employ of Landmark Consultants, Inc.

REVIEW SET
NOT FOR CONSTRUCTION

NO.	DATE	BY	DESCRIPTION
1	9/9/25	EG	Addressed DRT Comments
2	9/30/25	EG	Rev. Lot 2, Misc

PROJECT:	2387-008
DATE:	9/30/25
CONTACT:	Erk Gasperling
EMAIL:	eng@landmark-co.com

