

STEAMBOAT OFFICE  
24 5TH STREET, SUITE B  
STEAMBOAT SPRINGS, CO 80487

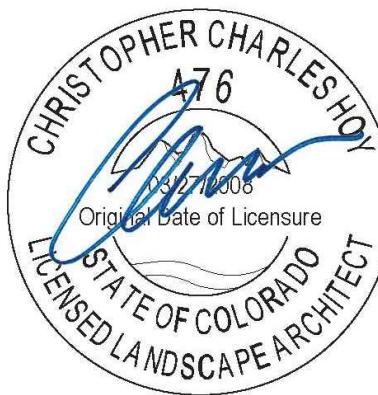

RIVERVIEW - SITE B/E  
322 RIVERVIEW WAY  
STEAMBOAT SPRINGS, COLORADO

| Issue Dates: |             |
|--------------|-------------|
| DATE         | DESCRIPTION |
| 7/18/2025    | ASI 5       |

|              |           |
|--------------|-----------|
| Project No.  | 2000 0622 |
| Plot Date:   |           |
| Drawn by:    | CB/CH     |
| Checked by:  | CH        |
| Approved by: | CH        |

Sheet Title  
LANDSCAPE PLAN -  
BUILDING E

Sheet No.  
LS101



A LANDSCAPE PLAN - BUILDING E  
SCALE: 1/16"=1'

| LEGEND               |  |                             |  |
|----------------------|--|-----------------------------|--|
| CONCRETE PAVING      |  | PROPERTY LINE               |  |
| CRUSHER FINES PAVING |  | LIMITS OF WORK              |  |
| CLAY PAVERS          |  | GUARDRAIL                   |  |
| ROCK MULCH           |  | CONCRETE EDGER              |  |
| ENHANCED CONCRETE    |  | STONE WALL                  |  |
|                      |  | BIKE RACKS                  |  |
|                      |  | TRASH/RECYCLING RECEPTACLES |  |
|                      |  | PET WASTE STATION           |  |
|                      |  | LANDSCAPE BOULDERS          |  |

SITE DETAIL KEYNOTES:

| EXISTING CONDITIONS                           | DETAIL/SHEET/SPEC SECTION |
|-----------------------------------------------|---------------------------|
| 0.0 STREET SIGN                               | RE: CIVIL                 |
| 0.1 FIRE HYDRANT                              | RE: CIVIL                 |
| 0.2 SITE LIGHTING                             | RE: CIVIL                 |
| PAVING & SURFACING                            | DETAIL/SHEET/SPEC SECTION |
| 1.0 STANDARD CONCRETE - BROOM FINISH          | RE: CIVIL                 |
| 1.1 CLAY PAVERS                               | RE: CIVIL                 |
| 1.2 ENHANCED CONCRETE - SANDSCAPE FINISH      | RE: CIVIL                 |
| 1.3 CRUSHER FINES                             | RE: CIVIL                 |
| 1.4 ROCK MULCH                                | RE: CIVIL                 |
| 1.5 FLAGSTONE PAVERS                          | RE: CIVIL                 |
| STEPS & RAMPS                                 | DETAIL                    |
| 2.1 STONE SLAB STEPS                          | RE: CIVIL                 |
| 2.2 TYPE 1/TYPE 2 COMBINATION RAMP            | RE: CIVIL                 |
| WALLS, CURBS & EDGERS                         | DETAIL                    |
| 3.1 ROLL-OVER CURB                            | RE: CIVIL                 |
| 3.2 FLUSH CONCRETE HEADER                     | RE: CIVIL                 |
| 3.3 DECORATIVE LANDSCAPE BOULDER              | RE: CIVIL                 |
| RAILINGS, BARRIERS & FENCING                  | DETAIL                    |
| 4.X NOT USED                                  | RE: CIVIL                 |
| SITE FURNISHINGS & SIGNS                      | DETAIL                    |
| 5.0 BIKE RACK                                 | RE: CIVIL                 |
| 5.1 LITTER & RECYCLING RECEPTACLE - ALTERNATE | RE: CIVIL                 |
| 5.2 PET WASTE STATION                         | RE: CIVIL                 |
| 5.4 ADIRONDACK CHAIR - ALTERNATE              | RE: CIVIL                 |
| 5.6 BENCH - ALTERNATE                         | RE: CIVIL                 |
| DRAINAGE                                      | DETAIL                    |
| 6.X NOT USED                                  | RE: CIVIL                 |
| SITE LIGHTING & ELECTRICAL                    | DETAIL                    |
| 7.0 STREET POLE LIGHT                         | RE: CIVIL                 |
| 7.1 PEDESTRIAN POLE LIGHT                     | RE: CIVIL                 |
| 7.2 CONCRETE TRANSFORMER PAD                  | RE: CIVIL                 |
| PLANTING & LANDSCAPE                          | DETAIL                    |
| 8.0 DECIDUOUS TREE                            | RE: CIVIL                 |
| MISCELLANEOUS                                 | DETAIL                    |
| 9.X NOT USED                                  | RE: CIVIL                 |

KEYMAP:

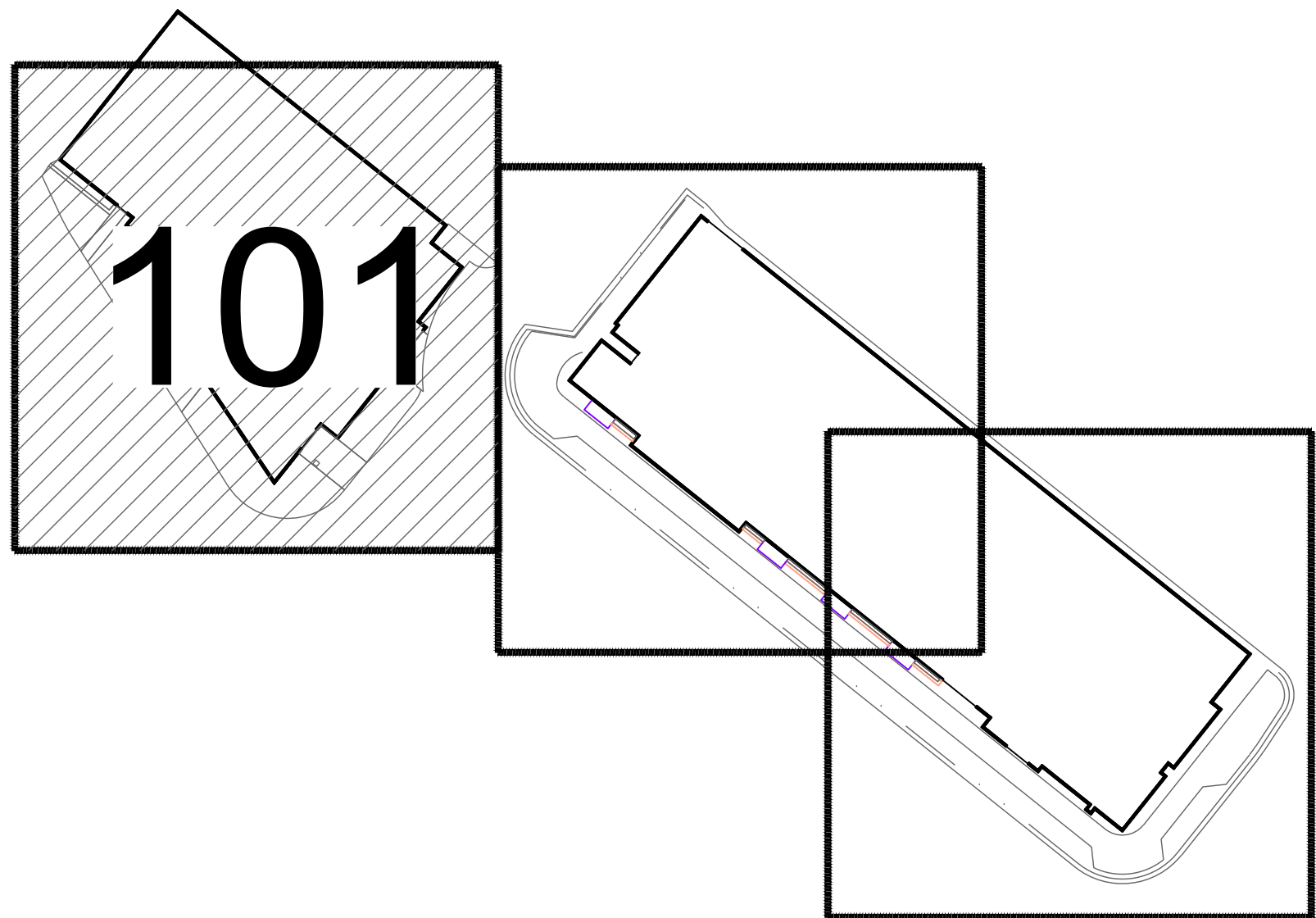

STEAMBOAT OFFICE  
24 5TH STREET, SUITE B  
STEAMBOAT SPRINGS, CO 80487

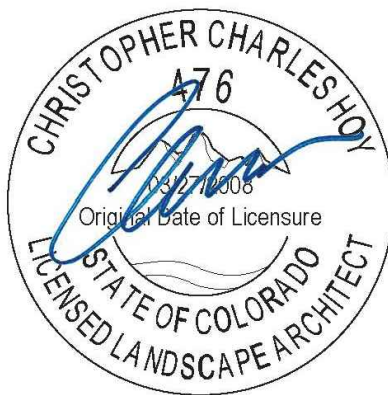

RIVERVIEW - SITE B/E  
322 RIVERVIEW WAY  
STEAMBOAT SPRINGS, COLORADO

|              |             |
|--------------|-------------|
| Issue Dates: |             |
| DATE         | DESCRIPTION |
| 7/18/2025    | ASI 5       |

|              |           |
|--------------|-----------|
| Project No.  | 2000 0622 |
| Plot Date:   |           |
| Drawn by:    | CB/CH     |
| Checked by:  | CH        |
| Approved by: | CH        |

Sheet Title  
PLANTING PLAN -  
BUILDING E

Sheet No.  
LP101

PLANT SCHEDULE

| PLANT TYPE: DECIDUOUS TREES    |     |                |                          |                              |           |          |
|--------------------------------|-----|----------------|--------------------------|------------------------------|-----------|----------|
| Abbr                           | No  | Genus          | Species                  | Common Name                  | Min. Size | Spacing  |
| ANC                            | 17  | Populus        | remuloides               | Quaking Aspen - Clump        | 6' Clump  | Per Plan |
| PLANT TYPE: EVERGREEN TREES    |     |                |                          |                              |           |          |
| Abbr                           | No  | Genus          | Species                  | Common Name                  | Min. Size | Spacing  |
| MOJ                            | 7   | Juniperus      | scoopulorum 'Moonglow'   | Moonglow Juniper             | 5 Gal     | Per Plan |
| PLANT TYPE: SHRUBS             |     |                |                          |                              |           |          |
| Abbr                           | No  | Genus          | Species                  | Common Name                  | Min. Size | Spacing  |
| SSK                            | 2   | Amelanchier    | gibbula                  | Saskatoon Serviceberry       | 5 Gal     | Per Plan |
| MPA                            | 30  | Arctostaphylos | paniculata               | Panicle Manzanita            | 5 Gal     | Per Plan |
| AFD                            | 11  | Cornus         | stolonifera 'Farrow'     | Arctic Fire Dogwood          | 5 Gal     | Per Plan |
| PYG                            | 31  | Potentilla     | fruticosa 'Yellow Gem'   | Yellow Gem Potentilla        | 5 Gal     | Per Plan |
| PBS                            | 4   | Prunus         | besseri 'Pawnee Butter'  | Pawnee Runes Sand Cherry     | 5 Gal     | Per Plan |
| RWO                            | 29  | Rosa           | x woodsii                | Woods Rose                   | 5 Gal     | Per Plan |
| PLANT TYPE: ORNAMENTAL GRASSES |     |                |                          |                              |           |          |
| Abbr                           | No  | Genus          | Species                  | Common Name                  | Min. Size | Spacing  |
| BLO                            | 37  | Bouteloua      | gracilis                 | Bonnie Ambition Blue Grass   | 5 Gal     | Per Plan |
| LBP                            | 110 | Scorzonchium   | scozonum 'Prairie Blues' | Prairie Blues Little Buestem | 1 Gal     | Per Plan |
| PLANT TYPE: PERENNIALS         |     |                |                          |                              |           |          |
| Abbr                           | No  | Genus          | Species                  | Common Name                  | Min. Size | Spacing  |
| WTA                            | 77  | Achillea       | millefolium              | Common White Yarrow          | 1 Gal     | Per Plan |
| COM                            | 85  | Cornopsis      | verticillata 'Moonbeam'  | Moonbeam Cornopsis           | 1 Gal     | Per Plan |
| LBS                            | 53  | Monarda        | raudosa mentrifolia      | Native Lavender Bee-balm     | 1 Gal     | Per Plan |
| PEP                            | 62  | Penstemon      | 'Edin Pink'              | Pink Penstemon               | 1 Gal     | Per Plan |
| PST                            | 12  | Penstemon      | strictus                 | Rocky Mountain Penstemon     | 1 Gal     | Per Plan |
| RGD                            | 25  | Ruthecia       | 'fulgida 'goldsturm'     | Black Eyed Susan             | 1 Gal     | Per Plan |
| SMN                            | 13  | Salvia         | 'sylvestris x 'Mainacht' | May Night Salvia             | 1 Gal     | Per Plan |
| GOL                            | 36  | Solidago       | 'Golden Baby'            | Golden Baby Goldenrod        | 1 Gal     | Per Plan |

LEGEND

ORNAMENTAL TREE

EVERGREEN TREES

SHRUBS

GRASSES

PERENNIALS

STONE WALL

KEYMAP:

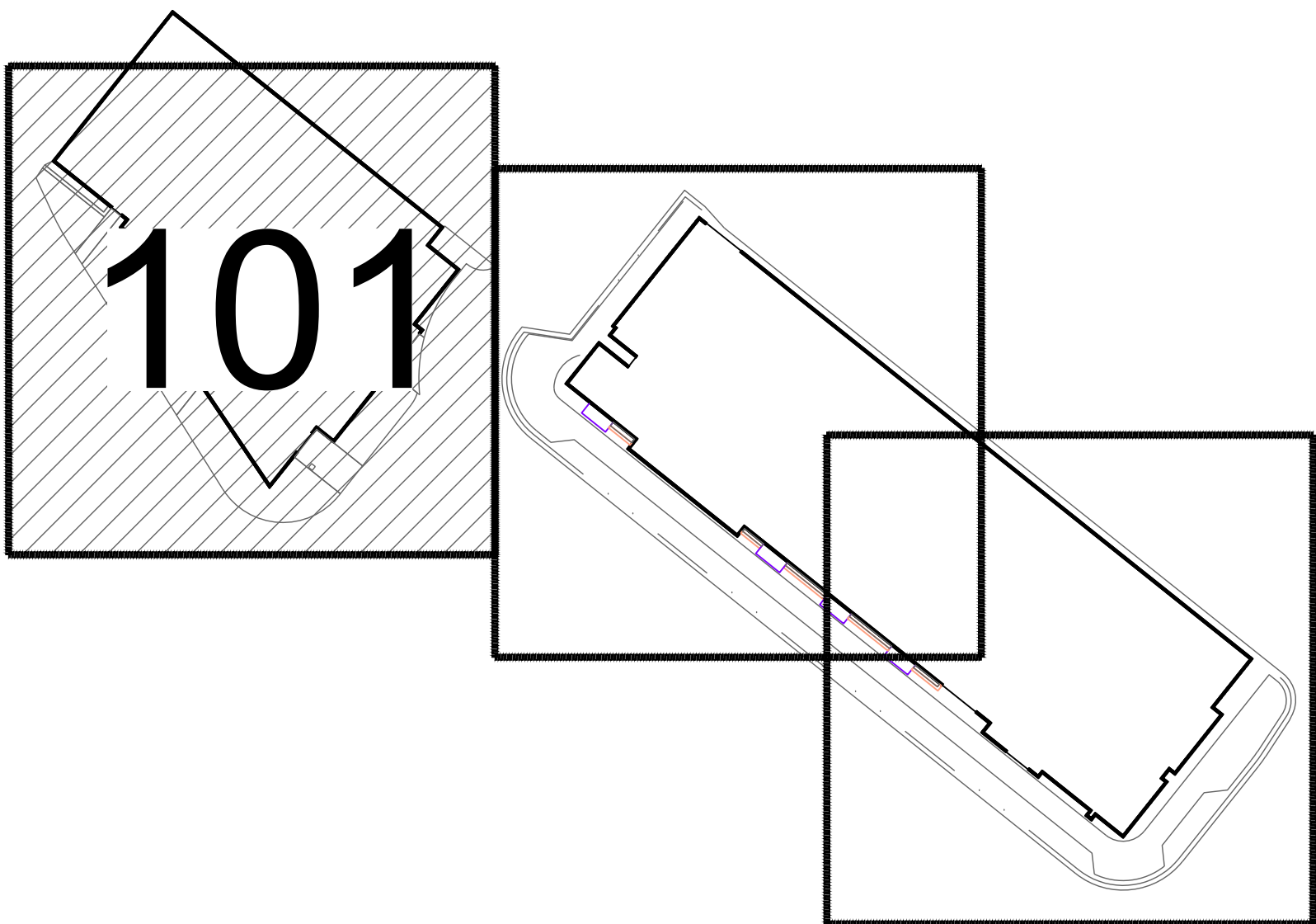

PLANTING PLAN - BUILDING E