



Routt County Assessor's Office, Property Search

Routt County Assessor's Office, Property Search

R8181491

Owner: FV BASECAMP, LLC
7200 WISCONSIN AVE STE 500
BETHESDA, MD 20814

Actual Value
\$819,380

KEY INFORMATION

Account #	R8181491	Parcel #	331900002
Tax Area	27 - *RE2* SS City Limits_Steamboat Basecamp		
Aggregate Mill Levy	41.919		
Neighborhood	WEST HWY40 COMM DIST		
Subdivision	STEAMBOAT BASECAMP		
Legal Desc	LOT 2 STEAMBOAT BASECAMP		
Property Use	COMMERCIAL LAND		
Total Acres	0.69		
Owner	FV BASECAMP, LLC		
Situs Addresses	-		
Total Area SqFt	-		
Business Name	-		

ASSESSMENT DETAILS

	Actual	Assessed
Land Value	\$819,380	\$228,610
Improvement Value	\$0	\$0
Total Value	\$819,380	\$228,610
Exempt Value	-	\$0
Adjusted Taxable Total	-	\$228,610

Most Recent Tax Liability

Current Year	2024	\$9,583.12
Prior Year	2023	\$12,632.56

Contact the Treasurer's Office @ 970-870-5555 for exact amount due. Figures above do not reflect any processing fees, Senior/Vet exemptions, late penalties, interest or liens due. Please confirm all balances with the Treasurer prior to submitting payment, as short payments will be rejected.

PUBLIC REMARKS

PUBLIC REMARK	PUBLIC REMARK DATE
NEW SUBD FROM R8172510/278600001 & R8172151/278600002 TO R8181490/331900001 - R8181492/331900003. PLAT REC#847173 7/28/2023. NO COVS. SUBCODE 3319.	2023-08-01 00:00:00
MAILIN ADDRESS UPDATED PER ONLINE SUBMITTAL FORM FROM TREAS.	2024-01-24 00:00:00
TY23 SU: ALL ABSTRACTS, ACCOUNT DESCRIPTORS & VALUES AS OF 01-01-2023. 23 VALUES HELD USING OVERRIDES. OVERRIDES REMOVED IN 2024.	2023-08-17 00:00:00

LAND DETAILS

LAND OCCURRENCE 1 - COMM LAND

Property Code	-	Economic Area	STEAMBOAT COMM
Super Neighborhood	-	Neighborhood	CURVE
Land Code	WEST HWY 40 < / = 1.00 AC	Land Use	PRIME SITE
Zoning	CS	Site Access	YEAR-ROUND
Road	PAVED	Site View	AVERAGE
Topography	LEVEL	Slope	NOT AFFECTED
Wetness	NOT AFFECTED	Water	COMM/PUBLIC
Utilities	GAS/ELEC	Sewer	COMM/PUBLIC
Acres	0.69	Description	-

BUILDINGS

EXTRA FEATURES / OUTBUILDINGS

No data to display

TRANSFER HISTORY

No data to display

No data to display

TAX AUTHORITIES

TAX AREA	TAX AUTHORITY ENTITY	AUTHORITY TYPE	2024 LEVY BY ENTITY	2024 TAX AREA LEVY	ENTITY % OF TAX BILL	ESTIMATED AD VALOREM TAX
27	CITY OF STEAMBOAT SPRINGS	Home Rule Municipalities	2	41.919	4.77%	\$457
27	COLORADO MOUNTAIN COLLEGE	Local District College	3.23	41.919	7.71%	\$738
27	COLORADO RIVER WATER CONSERVATION DISTRICT	Water Conservancy	0.501	41.919	1.20%	\$115
27	EAST ROUTT REGIONAL LIBRARY DIST	Library Districts	2.798	41.919	6.67%	\$640
27	ROUTT COUNTY GOVERNMENT	County	13.913	41.919	33.19%	\$3,181
27	STEAMBOAT BASECAMP METROPOLITAN DISTRICT	Metropolitan Districts	0	41.919	0.00%	\$0
27	STEAMBOAT SPRINGS CEMETERY DISTRICT	Cemetery Districts	0.063	41.919	0.15%	\$14
27	STEAMBOAT SPRINGS SCHOOL DISTRICT (RE-2)	School Districts	16.594	41.919	39.59%	\$3,794
27	UPPER YAMPA WATER CONSERVATION DISTRICT	Water Conservancy	1.82	41.919	4.34%	\$416
27	YAMPA VALLEY HOUSING AUTHORITY	Housing Authorities (Municipal)	1	41.919	2.39%	\$229

PRIOR YEAR ASSESSMENT INFORMATION

*YEAR	ACTUAL VALUE	ASSESSED VALUE	MILL LEVY	AD VALOREM TAXES
2024	\$819,380	\$228,610	41.92	\$9,583.12
2023	\$500,000	\$139,500	90.56	\$12,632.56

Contact the Treasurer's Office for current property tax amount due. Do not use the figures above to pay outstanding property taxes.

* 2024 assessment values reported above represent the assessor's appraised value less any Legislative discounts applied for SB24-233 & SB24B-1001 - Typically a \$55,000 Residential Actual Value credit and/or a \$30,000 Commercial Improvement Actual Value credit depending on the classification of the property. The 2023 values listed were subject to the same discounts under Legislative bills SB22-238 & SB23B-001.

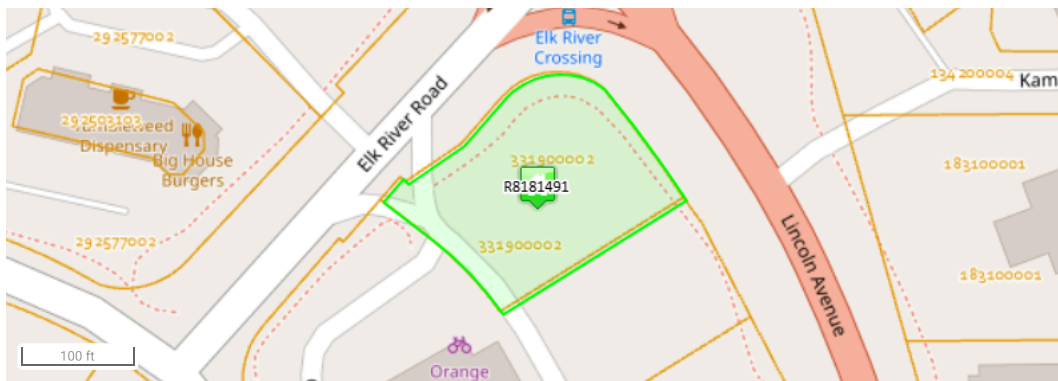

Data last updated: 03/04/2025