

440 S. Lincoln Ave, Suite 4A
P.O. Box 775966
Steamboat Springs, CO 80487
(970)-871-6772
www.fourpointse.com

No.	DATE	REVISIONS	
		DESCRIPTION	BY
1	2/12/2024	DRT REVIEW & RESPONSE	
1	4/18/2024	DRT REVIEW & RESPONSE	

**STEAMBOAT AIRPARK SUBDIVISION
CONSTRUCTION DRAWINGS**
**GLORIA GOSSARD PARKWAY
STEAMBOAT SPRINGS, CO 80487**

Horizontal Scale
1" = 50'
Contour Interval = 2 ft
DATE: 12-1-2023
JOB #: 1670-001
DRAWN BY: MDM
DESIGN BY: MDM
REVIEW BY: WNM

DRAWING:
**SIDEWALK & STORM
SEWER PLAN #2**

SHEET #
C4

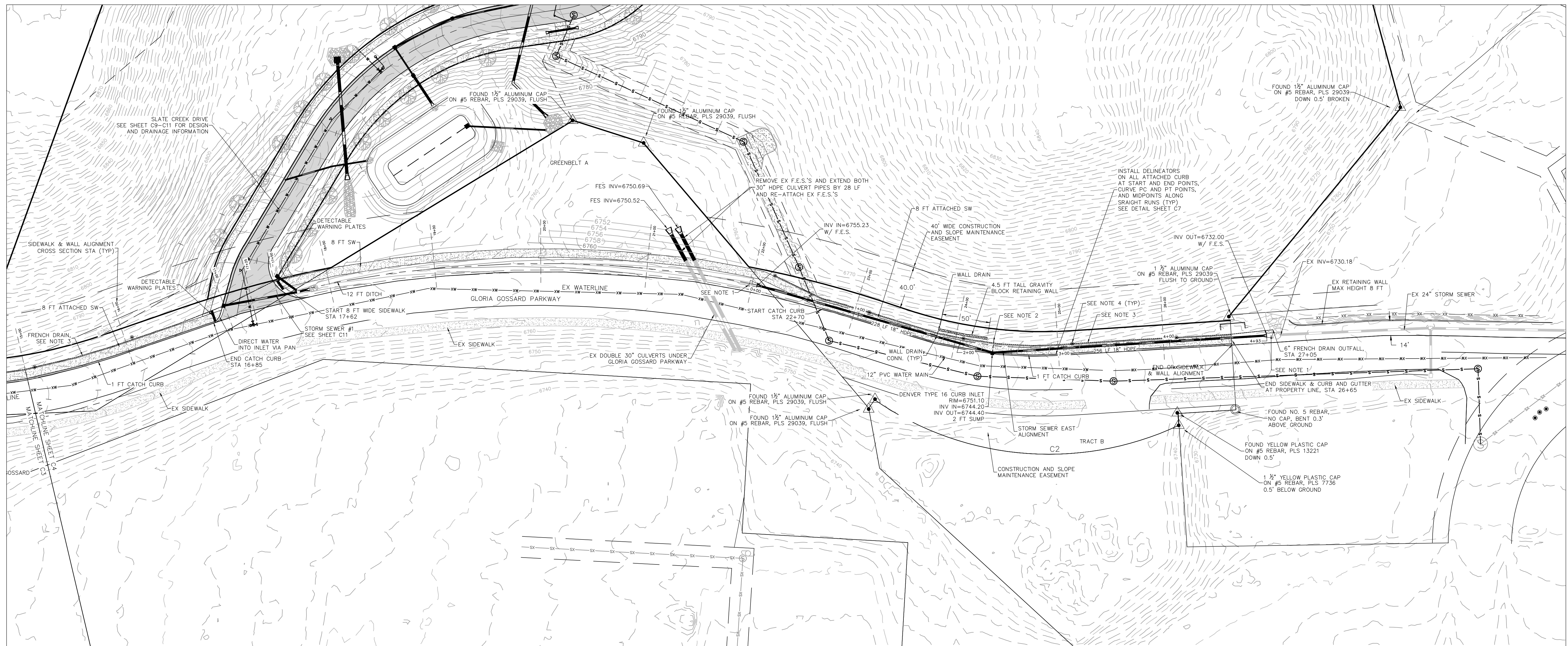

- NOTES**
- PRIOR TO ANY CONSTRUCTION, A SLOPE STABILITY PLAN IS REQUIRED BY A GEOTECHNICAL ENGINEER FOR ALL SLOPES IMPACTED BY THE CONSTRUCTION OF THE SIDEWALK ON THE NORTH SIDE OF GLORIA GOSSARD PARKWAY.
 - EROSION PROTECTION SHALL BE INSTALLED AT ALL STORMWATER PIPE OUTFALLS PER THE DETAIL ON SHEET C7.
 - INSTALL PERVIOUS SIDEWALK SHOULDER FRENCH DRAIN PER DETAIL ON SHEET C8.
 - INSTALL 6" 2-WAY CLEANOUT FOR PERVIOUS SIDEWALK SHOULDER FRENCH DRAIN PER DETAIL ON SHEET C8. 2-WAY CLEANOUTS SHALL BE INSTALLED EVERY 100 FEET.
 - INSTALL A 6" PVC 2-WAY CLEANOUT FOR THE PERFORATED PVC WALL DRAIN.
 - SEE SHEETS C12 AND C13 FOR GLORIA GOSSARD CONSTRUCTION INFORMATION.
 - ALL GRATES INSTALLED SHALL BE BICYCLE SAFE.

