



Routt County Assessor's Office, Property Search

Routt County Assessor's Office, Property Search

R8172286

Owner:
 STEAMBOAT SPRINGS AIRPARK, LLC
 PO BOX 770327
 STEAMBOAT SPRINGS, CO 80477

Actual Value
\$5,013,150

KEY INFORMATION

Account #	R8172286	Parcel #	280600101
Tax Area	20SS - *RE2* SS City Limits_Old Town+Lower Fish/Tamarack Areas & near		
Aggregate Mill Levy	40.556		
Neighborhood	-		
Subdivision	WEST ACRES RANCH SUBD EXEMPTION PLAT		
Legal Desc	PT OF LOT 1 (TA 20SS), WEST ACRES RANCH SUBD EXEMPTION PLAT, 52.77A		
Property Use	COMMERCIAL LAND		
Total Acres	52.77		
Owner	STEAMBOAT SPRINGS AIRPARK, LLC		
Situs Addresses	-		
Total Area SqFt	-		
Business Name	-		

ASSESSMENT DETAILS

	Actual	Assessed
Land Value	\$5,013,150	\$1,398,670
Improvement Value	\$0	\$0
Total Value	\$5,013,150	\$1,398,670
Exempt Value	-	\$0
Adjusted Taxable Total	-	\$1,398,670

PUBLIC REMARKS

PUBLIC REMARK	PUBLIC REMARK DATE
AMENDMENT OF 2004 EASEMENT GRANT & ROW AGRMT REC#802332 8/23/2019: INCLUDES R4779717, R6814853, R8172287, R8172289, R8172282, R8172286	2019-09-03 00:00:00
REC#777773, 3/10/17: ALL UND INT OF GEORGE BLAIR (61.222%) TO ETAL(ALL TRUSTS DATED 7/29/2004)AS FOLLOWS: GEORGE A. BLAIR BLAIR QTIP TRUST FBO JOANNE W. BLAIR - 65.3244% UND INTGEORGE A. BLAIR GST TRUST FBO DONNA L. BLAIR - 8.6689% UND INT GEORGE A.	2017-03-20 00:00:00
1-6-85, 36-7-85	2008-04-02 00:00:00
ETAL: (777773) GEORGE A BLAIR MARITAL QTIP TRUST FBO JOANNE W. BLAIR 7/29/2004 (ETAL) 61.222% UND INT; WILLIAM FAMILY PARTNERSHIPS, LLLP 22.2206% UND INT; STEAMBOAT LLC 9.99975% UND INT; JENNIFER JOHNSON 3.33325% UND INT & CHARLES G. WILLIAMS, JR. 1% UND	2008-04-02 00:00:00
SOA#666886: STEPHANIE JOHNSTON AUTH TO EXECUTE FOR STEAMBOAT, LLC. SF	2008-04-02 00:00:00

LAND DETAILS

LAND OCCURRENCE 1 - COMM LAND

Property Code	-	Economic Area	STEAMBOAT COMM
Super Neighborhood	-	Neighborhood	DOWNHILL - COPPER - ELK
Land Code	CRVE-20MI-DWNHL > 7.00 AC	Land Use	PRIME SITE
Zoning	RE-1 to MF-1	Site Access	YEAR-ROUND
Road	PAVED	Site View	GOOD
Topography	SLOPING	Slope	MODERATE
Wetness	NOT AFFECTED	Water	COMM/PUBLIC
Utilities	ELECTRIC	Sewer	COMM/PUBLIC
Acres	52.77	Description	-

BUILDINGS

EXTRA FEATURES / OUTBUILDINGS

No data to display

TRANSFER HISTORY

[View Recorded Transfer Documents Here](#)

RECORDING DATE	REC. #	BOOK	PAGE	DEED TYPE	SALE DATE	SALE PRICE
+ 06/06/2017	780034	-	-	WD	06/05/2017	\$2,500,000
Appraiser Public Remarks		TA SPLIT, INCLUDES R8172282 R8172286				
Grantor		WILLIAMS FAMILY PARTNERSHIP LLLP (ET AL)				
Grantee		STEAMBOAT SPRINGS AIRPARK, LLC				
+ 03/10/2017	777773	-	-	PRD	08/11/2016	\$0
Appraiser Public Remarks		INCLUDES R8172286 & R8172282: ETAL(ALL TRUSTS DATED 7/29/2004): GEORGE A. BLAIR QTIP TRUST FBO JOANNE W. BLAIR,GEORGE A. BLAIR GST TRUST FBO DONNA L. BLAIR, GEORGE A. BLAIR GST TRUST FBO CARRIE B. BLAIR, GEORGE A. BLAIR GST TRUST FBO GEORGIA A. BLAIR, GEO				
Grantor		JOANNE W. BLAIR, PR ESTATE OF GEORGE A. BLAIR				
Grantee		GEORGE A BLAIR MARITAL QTIP TRUST FBO JOANNE W. BLAIR 7/29/2004 (ETAL)				

TAX AUTHORITIES

TAX AREA	TAX AUTHORITY ENTITY	AUTHORITY TYPE	2023 LEVY BY ENTITY	2023 TAX AREA LEVY	ENTITY % OF TAX BILLS	ESTIMATED AD VALOREM TAX
20SS	CITY OF STEAMBOAT SPRINGS	Home Rule Municipalities	2.0	40.556	4.9%	\$2,797
20SS	COLORADO MOUNTAIN COLLEGE	Local District College	2.977	40.556	7.3%	\$4,164
20SS	COLORADO RIVER WATER CONSERVATION DISTRICT	Water Conservancy	0.5	40.556	1.2%	\$699
20SS	EAST ROUTT REGIONAL LIBRARY DIST	Library Districts	1.803	40.556	4.4%	\$2,522
20SS	ROUTT COUNTY GOVERNMENT	County	13.522	40.556	33.3%	\$18,913
20SS	STEAMBOAT SPRINGS CEMETERY DISTRICT	Cemetery Districts	0.061	40.556	0.2%	\$85
20SS	STEAMBOAT SPRINGS SCHOOL DISTRICT (RE-2)	School Districts	16.873	40.556	41.6%	\$23,600
20SS	UPPER YAMPA WATER CONSERVATION DISTRICT	Water Conservancy	1.82	40.556	4.5%	\$2,546
20SS	YAMPA VALLEY HOUSING AUTHORITY	Housing Authorities (Municipal)	1.0	40.556	2.5%	\$1,399

PRIOR YEAR ASSESSMENT INFORMATION

*YEAR	ACTUAL VALUE	ASSESSED VALUE	MILL LEVY	AD VALOREM TAXES
2023	\$5,013,150	\$1,398,670	40.56	\$56,724
2022	\$2,374,650	\$688,650	55.20	\$38,010
2021	\$5,330	\$1,550	54.62	\$85
2020	\$6,230	\$1,810	54.24	\$98
2019	\$6,230	\$1,810	52.90	\$96
2018	\$7,180	\$2,080	49.90	\$104
2017	\$7,180	\$2,080	49.28	\$103
2016	\$6,860	\$1,990	45.48	\$91

Contact the Treasurer's Office for current property tax amount due. Do not use the figures above to pay outstanding property taxes.

*TY2023 assessment values reported above represent the assessor's appraised value less any Legislative discounts applied for SB22-238 & SB23B-001 – Typically a \$55,000 Residential Actual Value credit and/or a \$30,000 Commercial Improvement Actual Value credit depending on the classification of the property.

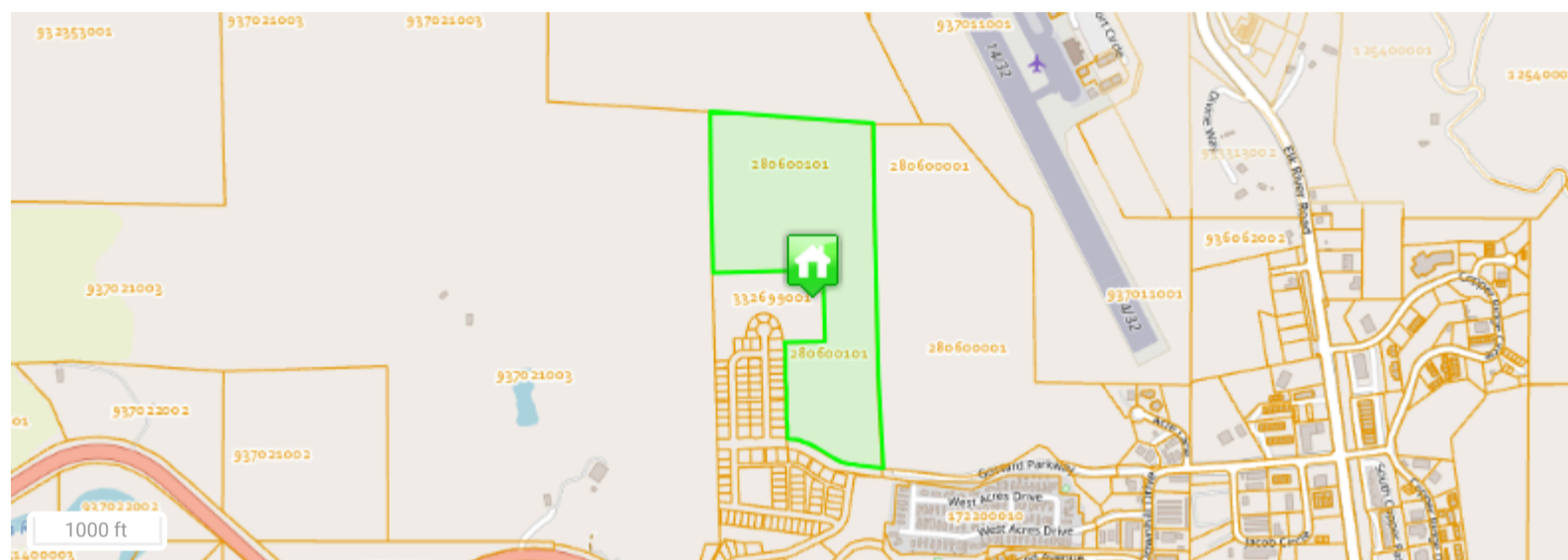

Data last updated: 04/30/2024