



Routt County Assessor's Office, Property Search

R8180870

-

Owner:  
STEAMBOAT SKI & RESORT CORP.  
2305 MT WERNER CIR  
STEAMBOAT SPRINGS, CO 80487-9023

Actual Value

\$24,592,730

KEY INFORMATION

Account #	R8180870	Parcel #	320200001
Tax Area	28 - *RE2* SS City Limits_Ski Resort Base Area (SS Redevelopment Aut		
Aggregate Mill Levy	55.195		
Neighborhood	SKI AREA COMM		
Subdivision	SKI HILL SUBDIVISION, REPLAT OF PARCEL D		
Legal Desc	LOT 1 SKI HILL SUBDIVISION REPLAT PARCEL D		
Property Use	SKI AREA		
Total Acres	1.59		
Owner	STEAMBOAT SKI & RESORT CORP.		
Situs Addresses	-		
Total Area SqFt	48,009		
Business Name	SKI CORP - PROMENADE BASE AREA		

ASSESSMENT DETAILS

	Actual
Land Value	\$7,155,000
Improvement Value	\$17,437,730
Total Value	\$24,592,730
Exempt Value	-
Adjusted Taxable Total	-

PUBLIC REMARKS

PUBLIC REMARK	PUBLIC REMARK DATE
1/4/2021: NEW SUBD FROM R6253787/154900004 TO R8180870/320200001 & R8180871/320200002. FILE#14469 @ REC817319 11/30/2020. NO COVS. SUBCODE 3202. SH	2021-01-04 00:00:00

LAND DETAILS

LAND OCCURRENCE 1 - COMM LAND

Property Code	2125 - RECREATION LAND	Economic Area	STEAMBOAT COMM
Super Neighborhood	-	Neighborhood	SKI AREA
Land Code	MOUNTAIN SKI AREA PREMIER SLOPE LOCATION	Land Use	PRIME SITE
Zoning	OR	Site Access	YEAR-ROUND
Road	PAVED	Site View	GOOD
Topography	SLOPING	Slope	MODERATE
Wetness	NOT AFFECTED	Water	COMM/PUBLIC
Utilities	GAS/ELEC	Sewer	COMM/PUBLIC
Acres	1.59	Description	-

BUILDINGS

COMMERCIAL BUILDING DETAILS

COMMERCIAL IMPRV OCCURRENCE 1

Economic Area	STEAMBOAT COMM	Property Code	2225 - RECREATION-IMPROVE
Neighborhood	Ski Area	Actual Year Built	2021
Building Use	Restaurant	Effective Year Built	2021
Grade / Quality	Excellent	Last Tenant Finish	-
Stories	3	Roof Structure	GABLE
Roof Cover	MEMBRANE	Foundation	CONCRETE
Frame	STEEL	Basement Type	FULL
Interior Condition	Normal	Exterior Condition	Normal
Air Conditioning	NONE	Heating Fuel	GAS
Heating Type	FORCED AIR	Interior Wall Height	11 to 14 feet
Exterior Wall	CONCRETE	Percent Complete	75
Calculation Method	Market	Total SQFT	6,260
Bldg Permit No.	-	Functional Obs	-
Permit Description	PROMENADE BUILDING LEVEL 01 (PLAZA LEVEL)		

COMMERCIAL IMPRV OCCURRENCE 2

COMMERCIAL IMPRV OCCURRENCE 3

COMMERCIAL IMPRV OCCURRENCE 4

COMMERCIAL IMPRV OCCURRENCE 5

COMMERCIAL IMPRV OCCURRENCE 6

EXTRA FEATURES / OUTBUILDINGS

FEATURE 1

Description	CANOPY,W/SLAB	Actual Year Built	2022
Quality	EXCELLENT	Effective Year Built	2022
Condition	EXCELLENT	Actual Area	1,472
Permit No.	SPRNR220115 (COMM IMPRV 5 IS SITUATED BELOW THIS NEW STAGE)	Percent Complete	-
Permit Desc.	STAGE CANOPY		

FEATURE 2

FEATURE 3

TRANSFER HISTORY

No data to display

TAX AUTHORITIES

TAX AREA	TAX AUTHORITY ENTITY	AUTHORITY TYPE	2022 LEVY BY ENTITY	2022 TAX AREA LEVY	ENTITY % OF TAX BILLS	ESTIMATED AD VALOREM TAX
28	CITY OF STEAMBOAT SPRINGS	Home Rule Municipalities	2	55.195	3.62%	\$13,723
28	COLORADO MOUNTAIN COLLEGE	Local District College	4.085	55.195	7.40%	\$28,029
28	COLORADO RIVER WATER CONSERVATION DISTRICT	Water Conservancy	0.501	55.195	0.91%	\$3,438
28	EAST ROUTT REGIONAL LIBRARY	Library Districts	3.075	55.195	5.57%	\$21,099
28	MT WERNER WATER AND SANITATION DISTRICT	Water and Sanitation Districts	0	55.195	0.00%	\$0
28	ROUTT COUNTY GOVERNMENT	County	17.911	55.195	32.45%	\$122,894
28	STEAMBOAT SPRINGS CEMETERY	Cemetery Districts	0.088	55.195	0.16%	\$604
28	STEAMBOAT SPRINGS REDEVOPMENT AUTHORITY	Urban Renewal Authorities	0	55.195	0.00%	\$0
28	STEAMBOAT SPRINGS SCHOOL DISTRICT (RE-2)	School Districts	24.715	55.195	44.78%	\$169,579
28	UPPER YAMPA WATER CONSERVATION DISTRICT	Water Conservancy	1.82	55.195	3.30%	\$12,488
28	YAMPA VALLEY HOUSING AUTHORITY	Housing Authorities (Municipal)	1	55.195	1.81%	\$6,861

PRIOR YEAR ASSESSMENT INFORMATION

YEAR	ACTUAL VALUE	ASSESSED VALUE	MILL LEVY	AD VALOREM TAXES
2022	\$5,171,610	\$1,499,770	55.20	\$82,780
2021	\$5,751,490	\$1,667,930	54.62	\$91,102
2020	\$9,029,270	\$2,618,490	54.24	\$142,022

Contact the Treasurer's Office for current property tax amount due. Do not use the figures above to pay outstanding property taxes.

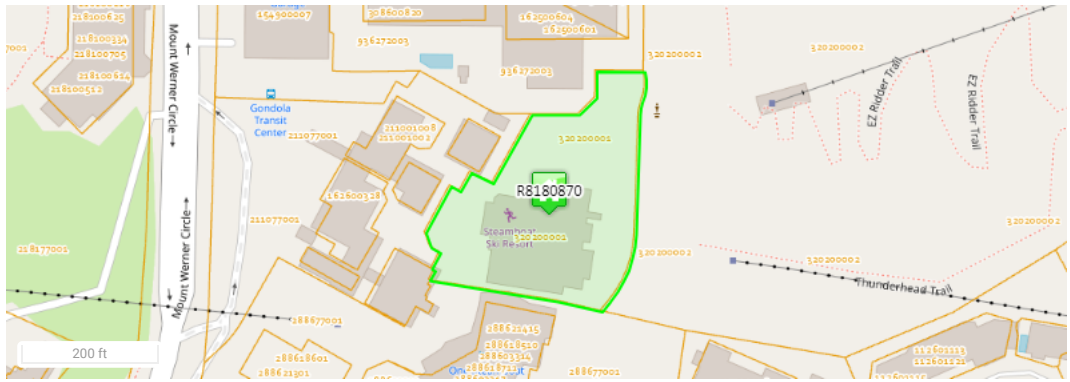

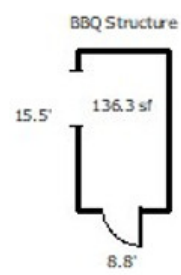
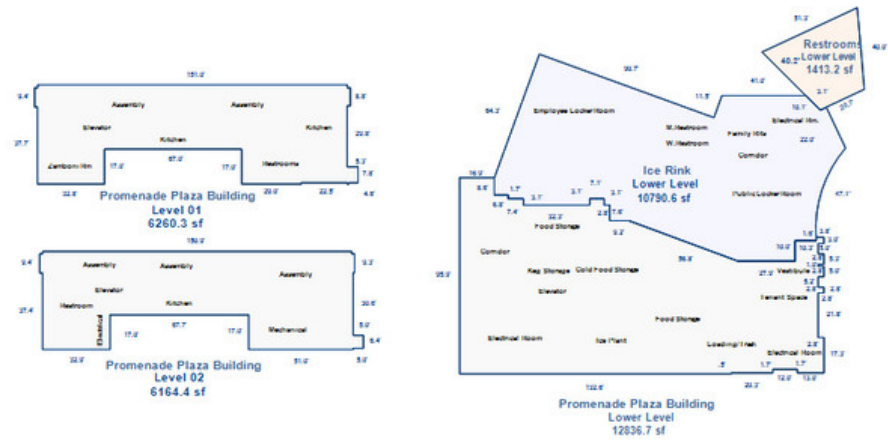

Sketch by Aaron Sklar - 4/1/14

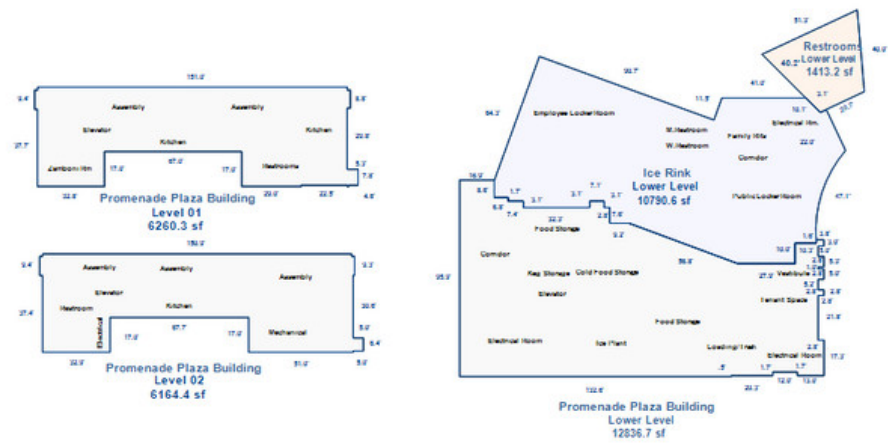

Data last updated: 01/12/2024