

**STEAMBOAT  
GONDOLA TRANSIT  
CENTER**  
Steamboat, CO

These documents are incomplete,  
are released for interim review  
only, and are not intended for  
bidding or construction purposes.  
12/20/23

KEY PLAN:

REVISIONS:		
#	DATE	DESCRIPTION
DRAWN: LM	REVIEWED: EG	

PROJECT NUMBER: 22077/1012-057  
DATE: NOVEMBER 03, 2023

100%  
SCHEMATIC  
DESIGN

## OVERALL UTILITY PLAN

SHEET:

# C.200

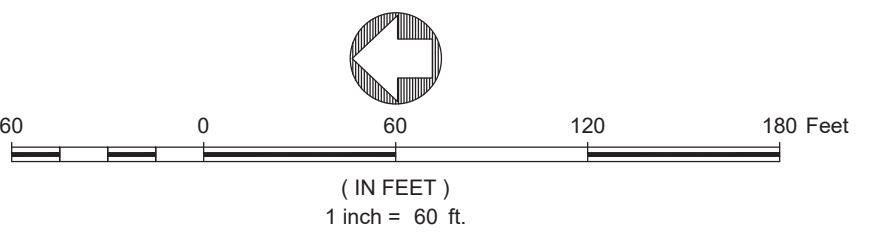

UTILITY PLAN LEGEND:

## WATER AND SEWER

EX SANITARY SEWER W/ MH  
PR SANITARY SEWER W/ MH  
EX WATER  
PR WATER  
EX FITTINGS (FIRE HYDRANT & VALVE)  
PR FITTINGS (FH, VALVE, TEE, BEND, CAP)

## 'DRY' UTILITIES

**EX ELECTRIC**  
**EX ELECTRIC STRUCTURES**  
**PR ELECTRIC**  
**PR ELECTRIC STRUCTURE**  
**EX GAS**  
**PR GAS**  
**EX TELEPHONE LINE AND BOX**  
**PR TELEPHONE LINE AND BOX**  
**EX CABLE TV LINE AND BOX**  
**PR CABLE TV LINE AND BOX**  
**PR DUCT BANK**  
**EX FIBER OPTIC LINE AND PULL BOX**  
**PR FIBER OPTIC LINE AND PULL BOX**  
**EXISTING IRRIGATION**

## STORM DRAINAGE

EX STORM SEWER

EX DRAINAGE STRUCTURES

PR STORM SEWER

PR DRAINAGE STRUCTURES

NOTES:

1. THE SIZE, TYPE AND LOCATION OF ALL KNOWN UNDERGROUND UTILITIES ARE APPROXIMATE WHEN SHOWN ON THESE DRAWINGS. IT SHALL BE THE RESPONSIBILITY OF THE CONTRACTOR TO VERIFY THE EXISTENCE OF ALL UNDERGROUND UTILITIES IN THE AREA OF THE WORK. BEFORE COMMENCING NEW CONSTRUCTION, THE CONTRACTOR SHALL BE RESPONSIBLE FOR LOCATING ALL UNDERGROUND UTILITIES AND SHALL BE RESPONSIBLE FOR ALL UNKNOWN UNDERGROUND UTILITIES.
2. EXISTING UNDERGROUND AND OVERHEAD PUBLIC AND PRIVATE UTILITIES AS SHOWN ARE INDICATED ACCORDING TO THE BEST INFORMATION AVAILABLE TO THE ENGINEER. THE ENGINEER DOES NOT GUARANTEE NOR IS RESPONSIBLE FOR THE ACCURACY OF SUCH INFORMATION. EXISTING UTILITY MAPS AND SERVICES MAY NOT BE STRAIGHT LINES OR AS INDICATED ON THESE DRAWINGS. CONTRACTOR SHALL VERIFY EXISTING HORIZONTAL AND VERTICAL LOCATIONS PRIOR TO CONSTRUCTION.
3. ALL SEWER AND WATER CONSTRUCTION SHALL BE PER MOUNT WERNER WATER STANDARD SPECIFICATIONS, LATEST EDITION.
4. ALL MATERIALS USED FOR BACKFILL SHALL BE FREE FROM REFUSE OR ORGANIC MATERIAL, COBBLES, BOULDERS, LARGE ROCKS OR STONES OR FROZEN SOILS GREATER THAN 6-INCHES IN DIAMETER.
5. BEDDING AND SHADING MATERIALS SHALL ONLY BE 3/4-INCH WASHED OR SCREENED ROCK, 3/4-INCH MINUS, SQUEEGEE OR EXISTING SAND, OR CLASS 6 AGGREGATE BASE COURSE IS NOT ALLOWED.
6. DRY UTILITY MODIFICATIONS REQUIRE UTILITY PROVIDER COORDINATION. ALL DRY UTILITY INFORMATION SHOWN HEREON IS ILLUSTRATIVE ONLY AND SUBJECT TO CHANGE.
7. CONDUIT AND OTHER FEEDS (E.G. SITE LIGHTING POWER AND CONTROLS) ARE NOT SHOWN HEREON.
8. ALL SHOWN HEREON SHOWN HEREON IS SUBJECT TO CHANGE.

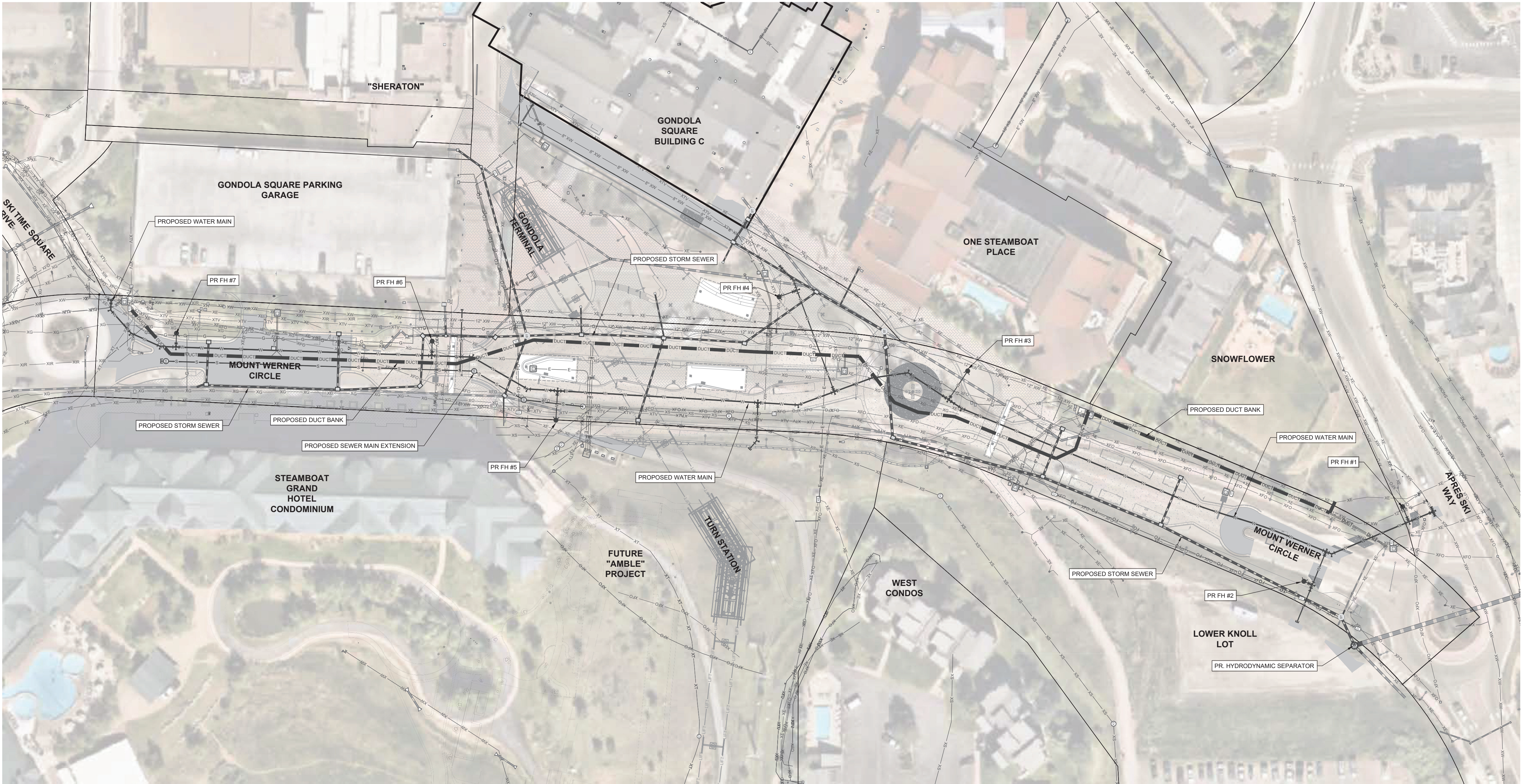



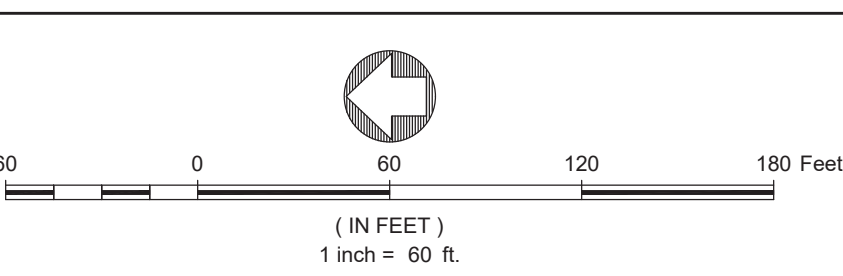
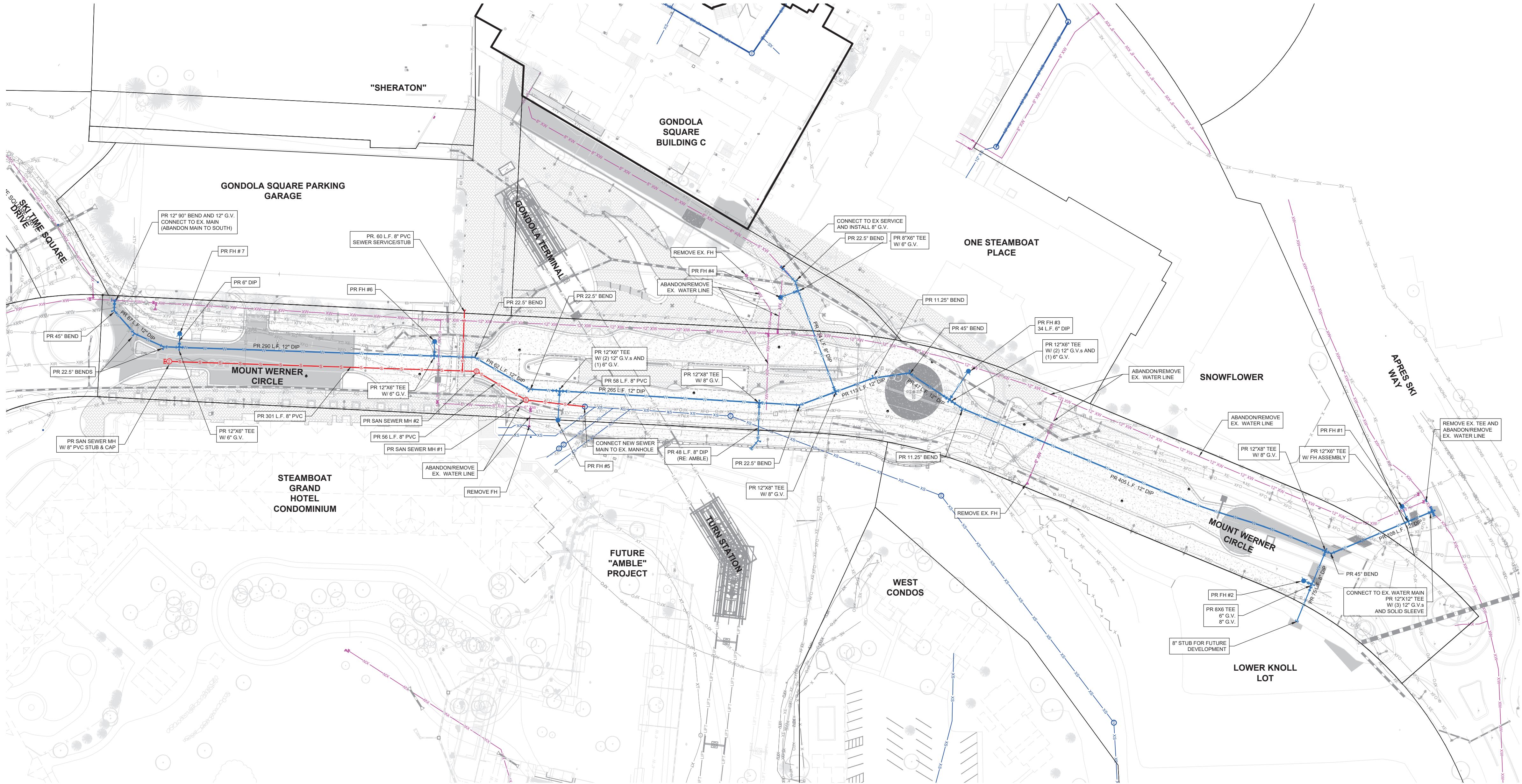

UTILITY PLAN LEGEND:

WATER AND SEWER

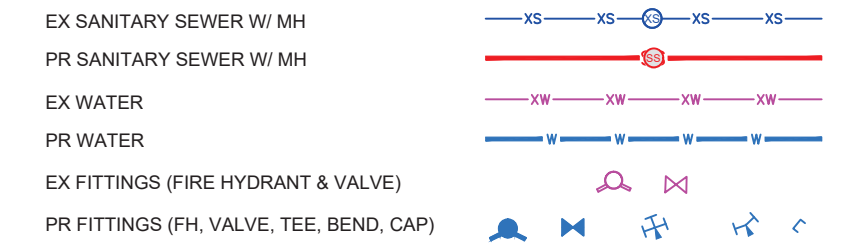

'DRY' UTILITIES

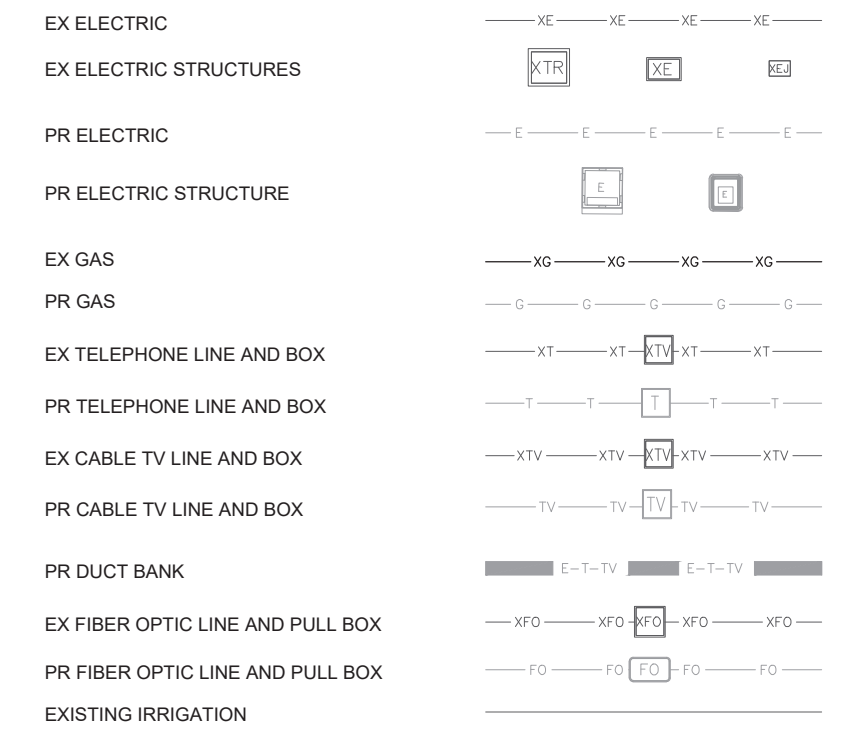

STORM DRAINAGE

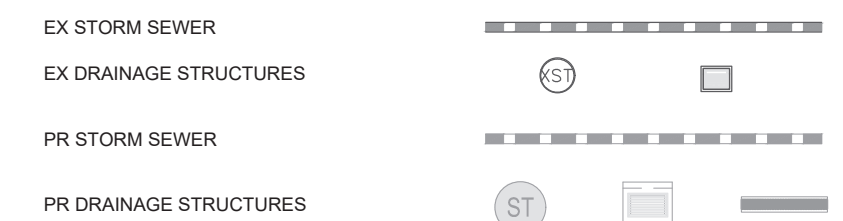

NOTES:

1. THE SIZE, TYPE AND LOCATION OF ALL KNOWN UNDERGROUND UTILITIES ARE APPROXIMATE WHEN SHOWN ON THESE DRAWINGS. IT SHALL BE THE RESPONSIBILITY OF THE CONTRACTOR TO VERIFY THE EXISTENCE OF ALL UNDERGROUND UTILITIES IN THE AREA OF THE WORK. BEFORE COMMENCING NEW CONSTRUCTION, THE CONTRACTOR SHALL BE RESPONSIBLE FOR LOCATING ALL UNDERGROUND UTILITIES AND SHALL BE RESPONSIBLE FOR ALL UNKNOWN UNDERGROUND UTILITIES.
2. EXISTING UNDERGROUND AND OVERHEAD PUBLIC AND PRIVATE UTILITIES AS SHOWN ARE INDICATED ACCORDING TO THE BEST INFORMATION MADE AVAILABLE TO THE ENGINEER. THE ENGINEER DOES NOT GUARANTEE NOR IS RESPONSIBLE FOR THE ACCURACY OF SUCH INFORMATION. EXISTING UTILITY MAINS AND SERVICES MAY NOT BE STRAIGHT LINES OR AS INDICATED ON THESE DRAWINGS. CONTRACTOR TO VERIFY EXISTING HORIZONTAL AND VERTICAL LOCATIONS PRIOR TO CONSTRUCTION.
3. ALL SEWER AND WATER CONSTRUCTION SHALL BE PER MOUNT WERNER WATER STANDARD SPECIFICATIONS, LATEST EDITION.
4. ALL MATERIALS USED FOR BACKFILL SHALL BE FREE FROM REFUSE ORGANIC MATERIAL, COBBLES, BOULDERS, LARGE ROCKS OR STONES OR FROZEN SOILS GREATER THAN 6-INCHES IN DIAMETER.
5. BEDDING AND SHADING MATERIALS SHALL ONLY BE 3/4-INCH WASHED OR SCREENED ROCK, 3/4-INCH MINUS, SQUEEGEE OR REJECT SAND, OR CLASS 6 AGGREGATE BASE COURSE IS NOT ALLOWED.
6. DRY UTILITY MODIFICATIONS REQUIRE UTILITY PROVIDER COORDINATION. ALL DRY UTILITY INFORMATION SHOWN HEREON IS ILLUSTRATIVE ONLY AND SUBJECT TO CHANGE.
7. CONDUIT AND OTHER FEEDS (E.G. SITE LIGHTING POWER AND CONTROLS) ARE NOT SHOWN HEREON.
8. ALL INFORMATION SHOWN HEREON IS SUBJECT TO CHANGE.

STEAMBOAT  
GONDOLA TRANSIT  
CENTER  
Steamboat, CO

REVIEW SET  
NOT FOR CONSTRUCTION

These documents are incomplete,  
are released for interim review  
only, and are not intended for  
bidding or construction purposes.  
12/20/23

KEY PLAN:

REVISIONS:		
#	DATE	DESCRIPTION

DRAWN: LM REVIEWED: EG

PROJECT NUMBER: 22077/1012-057  
DATE: NOVEMBER 03, 2023

100%  
SCHEMATIC  
DESIGN

WATER AND SEWER PLAN

SHEET:

C.210





These documents are incomplete,  
are released for interim review  
only, and are not intended for  
bidding or construction purposes.

12/20/23

KEY PLAN:

#	DATE	DESCRIPTION

DRAWN: LM REVIEWED: EG

PROJECT NUMBER: 22077/1012-05  
DATE: NOVEMBER 03, 2023

100%  
SCHEMATIC  
DESIGN

## RY UTILITY PLAN

HEET:

# C.220

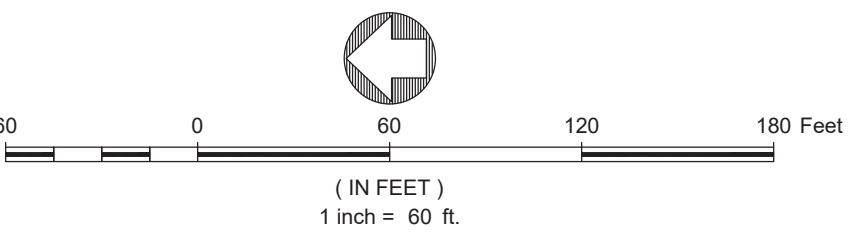

### UTILITY PLAN LEGEND:

## WATER AND SEWER

EX SANITARY SEWER W/ MH	
PR SANITARY SEWER W/ MH	
EX WATER	
PR WATER	
EX FITTINGS (FIRE HYDRANT & VALVE)	
PR FITTINGS (FH, VALVE, TEE, BEND, CAP)	

## DRY' UTILITIES

EX ELECTRIC

EX ELECTRIC STRUCTURES

PR ELECTRIC

PR ELECTRIC STRUCTURE

EX GAS

PR GAS

EX TELEPHONE LINE AND BOX

PR TELEPHONE LINE AND BOX

EX CABLE TV LINE AND BOX

PR CABLE TV LINE AND BOX

PR DUCT BANK

EX FIBER OPTIC LINE AND PULL BOX

PR FIBER OPTIC LINE AND PULL BOX

EXISTING IRRIGATION

Legend symbols:

- EX ELECTRIC: Blue line with 'X' symbols.
- EX ELECTRIC STRUCTURES: Blue line with a box containing 'XTR'.
- PR ELECTRIC: Purple line with 'E' symbols.
- PR ELECTRIC STRUCTURE: Purple line with a box containing 'E'.
- EX GAS: Blue line with 'XG' symbols.
- PR GAS: Green line with 'G' symbols.
- EX TELEPHONE LINE AND BOX: Yellow line with 'XT' symbols.
- PR TELEPHONE LINE AND BOX: Yellow line with a box containing 'T'.
- EX CABLE TV LINE AND BOX: Orange line with 'XTV' symbols.
- PR CABLE TV LINE AND BOX: Orange line with a box containing 'TV'.
- PR DUCT BANK: Red line with 'E-T-TV' and 'E-T-TV' symbols.
- EX FIBER OPTIC LINE AND PULL BOX: Blue line with 'XFO' symbols.
- PR FIBER OPTIC LINE AND PULL BOX: Blue line with 'FO' in a rounded rectangle.
- EXISTING IRRIGATION: Blue line.

## STORM DRAINAGE

EX STORM SEWER

EX DRAINAGE STRUCTURES

PR STORM SEWER

PR DRAINAGE STRUCTURES

NOTES:

- THE SIZE, TYPE AND LOCATION OF ALL KNOWN UNDERGROUND UTILITIES ARE APPROXIMATE WHEN SHOWN ON THESE DRAWINGS. IT SHALL BE THE RESPONSIBILITY OF THE CONTRACTOR TO VERIFY THE EXISTENCE OF ALL UNDERGROUND UTILITIES IN THE AREA OF THE WORK. BEFORE COMMENCING NEW CONSTRUCTION, THE CONTRACTOR SHALL BE RESPONSIBLE FOR LOCATING ALL UNDERGROUND UTILITIES AND SHALL BE RESPONSIBLE FOR ALL UNKNOWN UNDERGROUND UTILITIES.
2. EXISTING UNDERGROUND AND OVERHEAD PUBLIC AND PRIVATE UTILITIES AS SHOWN ARE INDICATED ACCORDING TO THE BEST INFORMATION MADE AVAILABLE TO THE ENGINEER. THE ENGINEER DOES NOT GUARANTEE NOR IS HE RESPONSIBLE FOR THE ACCURACY OF SUCH INFORMATION. EXISTING UTILITIES NAMES AND SERVICES MAY NOT BE STRAIGHT LINES OR AS INDICATED ON THESE DRAWINGS. CONTRACTOR TO CLARIFY EXISTING HORIZONTAL AND VERTICAL LOCATIONS PRIOR TO CONSTRUCTION.
3. ALL SEWER AND WATER CONSTRUCTION SHALL BE PER MOUNT WERNER WATER STANDARD SPECIFICATIONS, LATEST EDITION.
4. ALL MATERIALS USED FOR BACKFILL SHALL BE FREE FROM FROZEN ORGANIC MATERIAL, COBBLES, Boulders, LARGE ROCKS OR STONES OR REFUSE SOLID GREATER THAN 6-INCHES IN DIAMETER.
5. BEDDING AND SHADING MATERIALS SHALL ONLY BE 3/4-INCH WASHED OR SCREENED ROCK. 3/4-INCH MINUS, SQUEEGEE OR REJECT SAND, OR CLASS 6 AGGREGATE BASE COURSE IS NOT ALLOWED.
6. DRY UTILITY MODIFICATIONS REQUIRE UTILITY PROVIDER COORDINATION. ALL DRY UTILITY INFORMATION SHOWN HEREON IS ILLUSTRATIVE ONLY AND SUBJECT TO CHANGE.
7. CONDUIT AND OTHER FEEDS (E.G. SITE LIGHTING POWER AND CONTROLS) ARE NOT SHOWN HEREON.
8. ALL INFORMATION SHOWN HEREON IS SUBJECT TO CHANGE.

