

440 S. Lincoln Ave, Suite 4A
P.O. Box 775966
Steamboat Springs, CO 80487
(970)-871-6772
www.fourpointse.com

No.	DATE	REVISIONS	INT	
			MDM	MDM
1	9/2/2022	DRT REVIEW & RESPONSE		
2	6/16/2023	DRT REVIEW & RESPONSE		

**STEAMBOAT AIRPARK
PRELIMINARY PLAT
LOT 1, WEST ACRES RANCH SUBDIVISION
GLORIA GOSSARD PARKWAY
STEAMBOAT SPRINGS, CO 80487**

Horizontal Scale
1" = 50'
Contour Interval = 2 ft
DATE: 4-22-2022
JOB #: 1670-001
DRAWN BY: MDM/JLW
DESIGN BY: MDM/JLW
REVIEW BY: RL

IF THIS DRAWING IS PRESENTED IN A FORMAT OTHER THAN A3 X 36", THE GRAPHIC SCALE SHOULD BE UTILIZED.

DRAWING:
SIDEWALK & STORM SEWER PLAN #2

SHEET #
PP6

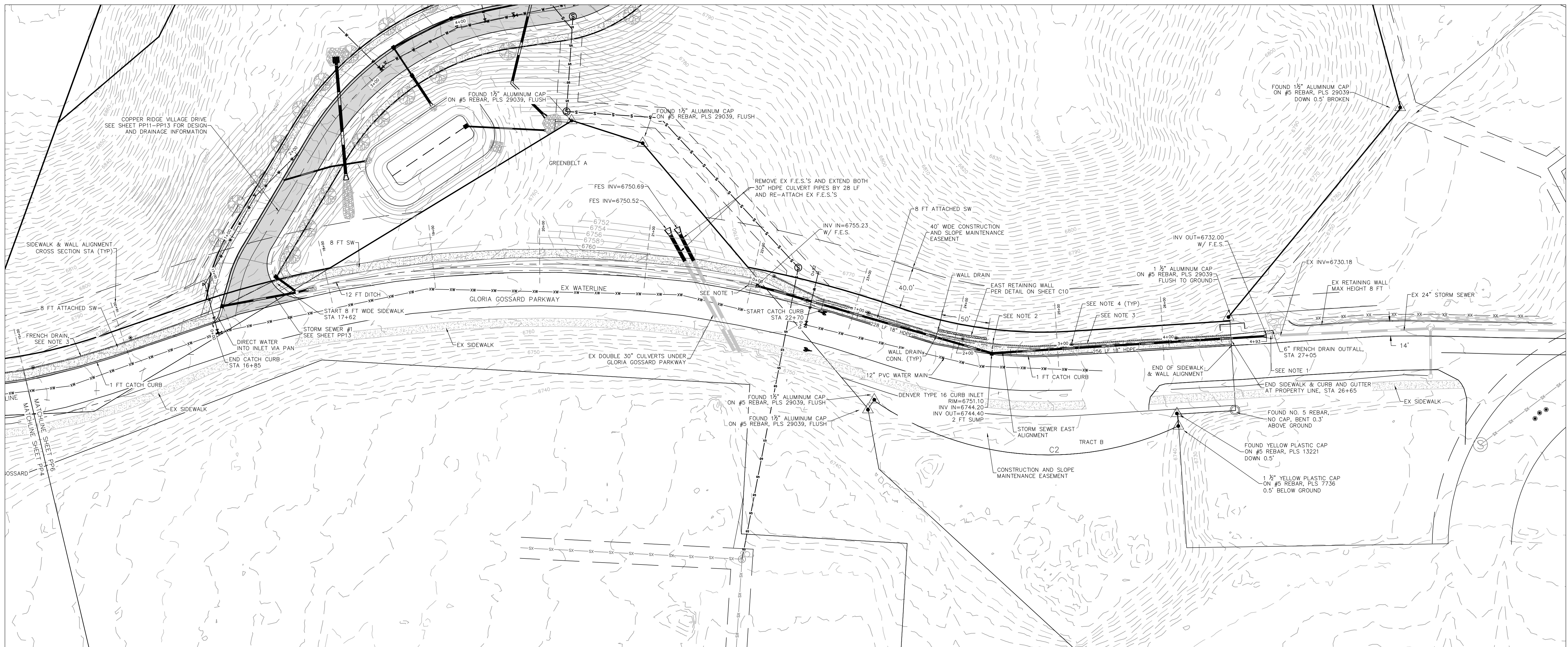

- NOTES**
1. PRIOR TO CONSTRUCTION PLANS, A SLOPE STABILITY PLAN IS REQUIRED BY A GEOTECHNICAL ENGINEER FOR ALL SLOPES IMPACTED BY THE CONSTRUCTION OF THE SIDEWALK ON THE NORTH SIDE OF GLORIA GOSSARD PARKWAY.
 2. EROSION PROTECTION SHALL BE INSTALLED AT ALL STORMWATER PIPE OUTFALLS PER THE DETAIL ON SHEET C6.
 3. PERVIOUS SIDEWALK SHOULDER FRENCH DRAIN. INSTALL 6" TEE AND INSTALL SOLID 6" PVC TO TYPE 16 INLET.
 4. INSTALL PERVIOUS SIDEWALK SHOULDER FRENCH DRAIN PER DETAIL ON SHEET PP10.
 5. INSTALL 6" 2-WAY CLEANOUT FOR PERVIOUS SIDEWALK SHOULDER FRENCH DRAIN PER DETAIL ON SHEET PP10. 2-WAY CLEANOUTS SHALL BE INSTALLED EVERY 100 FEET.

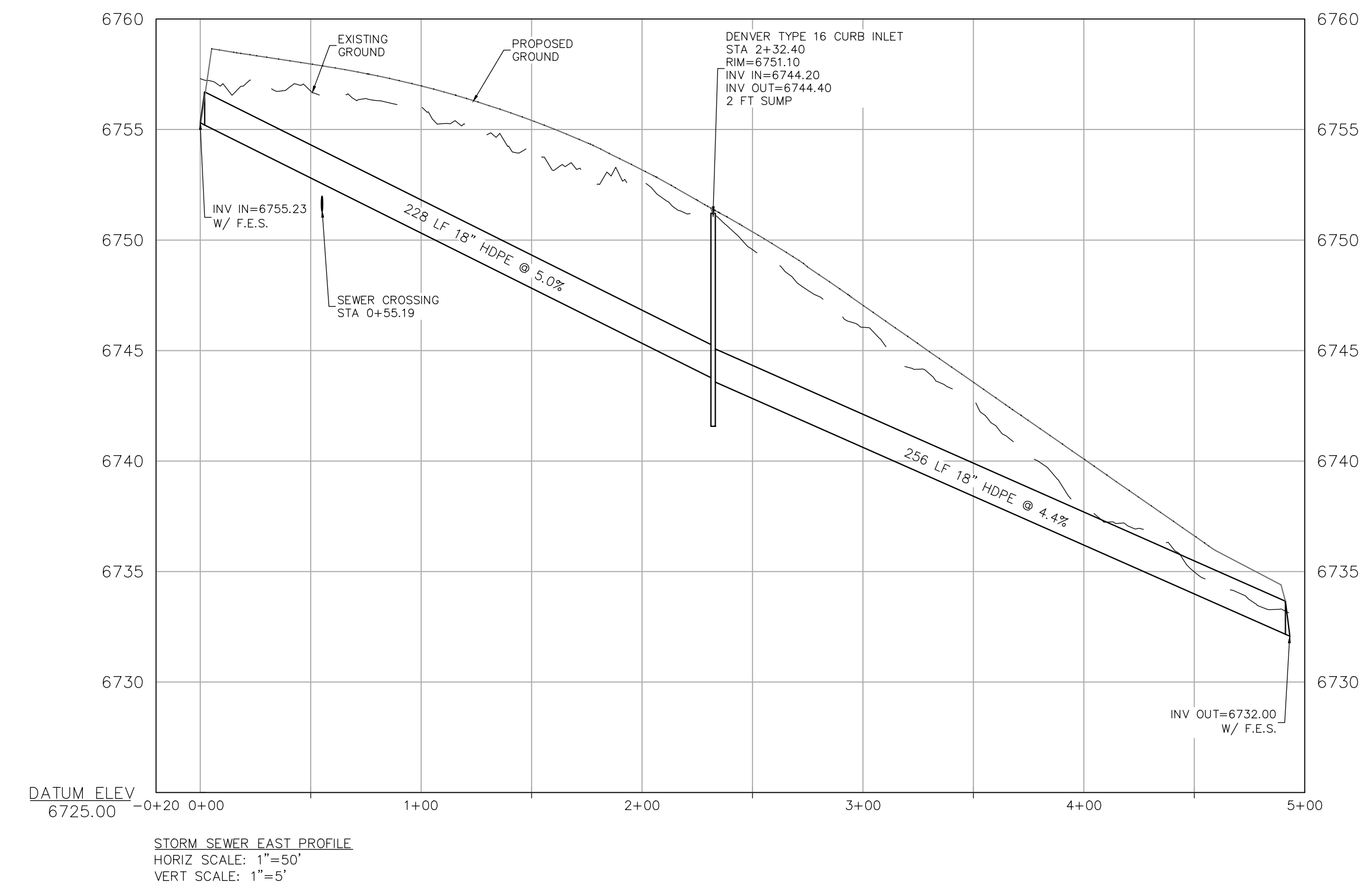
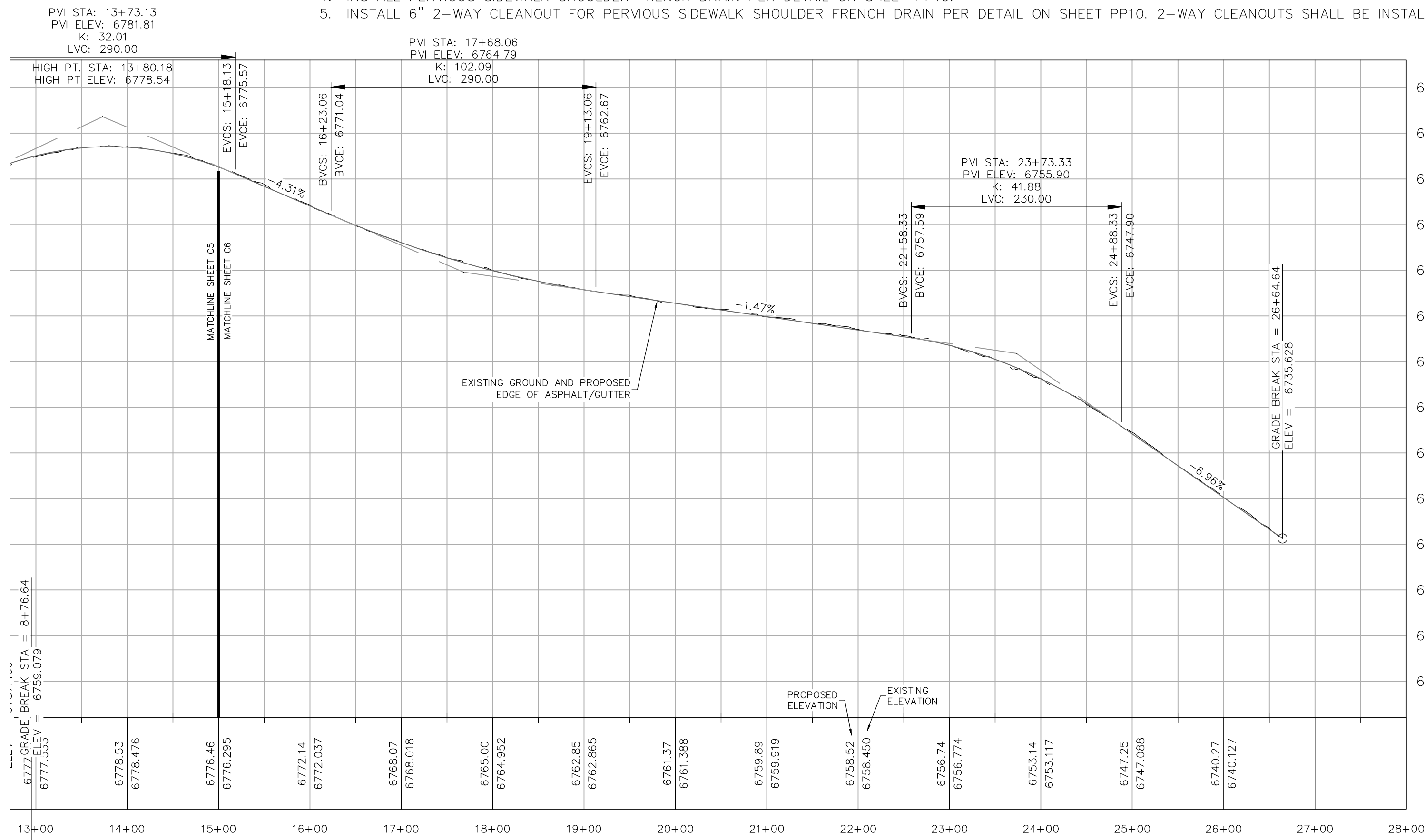

SIDEWALK PROFILE STA 15+00 TO 27+15
HORIZ SCALE: 1"=100'
VERT SCALE: 1"=10'

STORM SEWER EAST PROFILE
HORIZ SCALE: 1"=50'
VERT SCALE: 1"=5'