



633 34 Road  
Clifton, CO 81520  
Office: 970-257-7400

Prepared By:  
Maria Slane ATSSA TCS  
Cert# 489139 Exp: 01/19/2022  
Office: 970 257-7400  
Cell: 970 985-9486



NOT TO SCALE

CONTRACTOR: LUMEN  
PROJECT: 2305 MOUNT WERNER CIR, STEAMBOAT SPRINGS N.945301  
METHOD OF HANDLING TRAFFIC: RIGHT LANE CLOSURE  
DATE: 12/14/2021

#### NOTES:

1. Contractor will require a right lane closure to access existing manhole in the roadway.
2. Signs will be set at 100' spacing.
3. All hazards will be barricaded and lights will be used for safety as needed.
4. All work shall be performed in accordance with the 2009 version of the MUTCD.

#### Legend

-  Work Area  
 Cone

#### DEVICES

- 23 x Cone  
4 x W21-7 utility work ahead  
1 x W20-5 right lane closed ahead  
1 x W4-2 road narrows

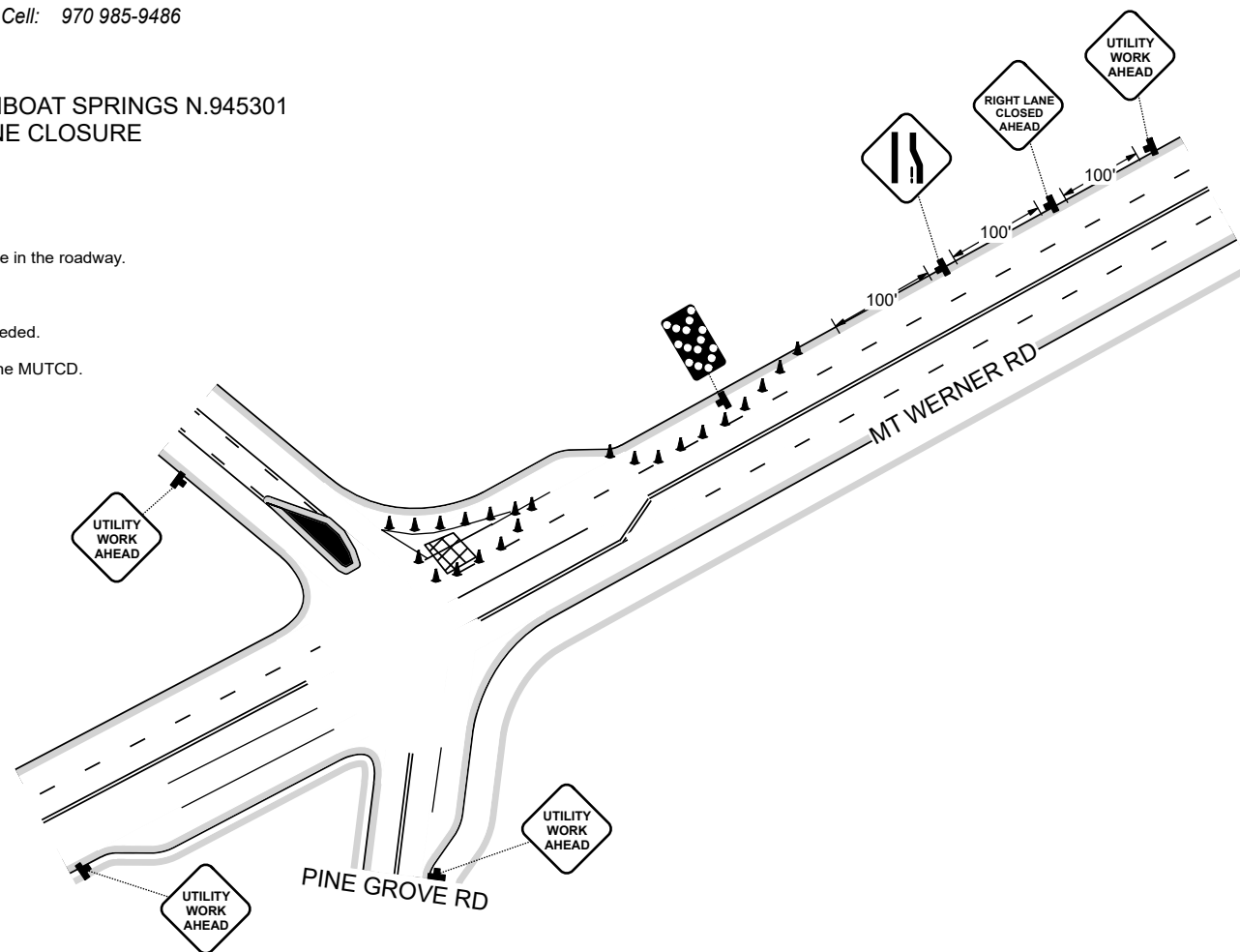

PERMIT NUMBER: \_\_\_\_\_

EXPIRATION DATE: \_\_\_\_\_

TRAFFIC CONTROL SUPERVISOR:   Maria Slane  

DATE: 12/14/2021

PERMITTEE/CONTRACTOR: \_\_\_\_\_ DATE: \_\_\_\_\_

REVIEWED AND ACCEPTED: \_\_\_\_\_ DATE: \_\_\_\_\_



633 34 Road  
Clifton, CO 81520  
Office: 970-257-7400

Prepared By:  
Maria Slane ATSSA TCS  
Cert# 489139 Exp: 01/19/2022  
Office: 970 257-7400  
Cell: 970 985-9486



CONTRACTOR: LUMEN  
PROJECT: 2305 MOUNT WERNER CIR, STEAMBOAT SPRINGS N.945301  
METHOD OF HANDLING TRAFFIC: SHOULDER CLOSURE/SIDEWALK CLOSURE  
DATE: 12/14/2021

#### NOTES:

- Contractor will require a shoulder closure at Montview Lane & Rockies Way and also a shoulder closure with sidewalk closure at Rockies Way & Indian Summer Drive..
- Signs will be set at 100' spacing.
- All hazards will be barricaded and lights will be used for safety as needed.
- All work shall be performed in accordance with the 2009 version of the MUTCD.

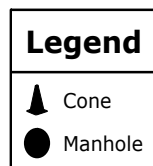

DEVICES
10 x Cone
7 x W21-7 utility work ahead
2 x R9-9 R9-9
2 x W21-5 shoulder work

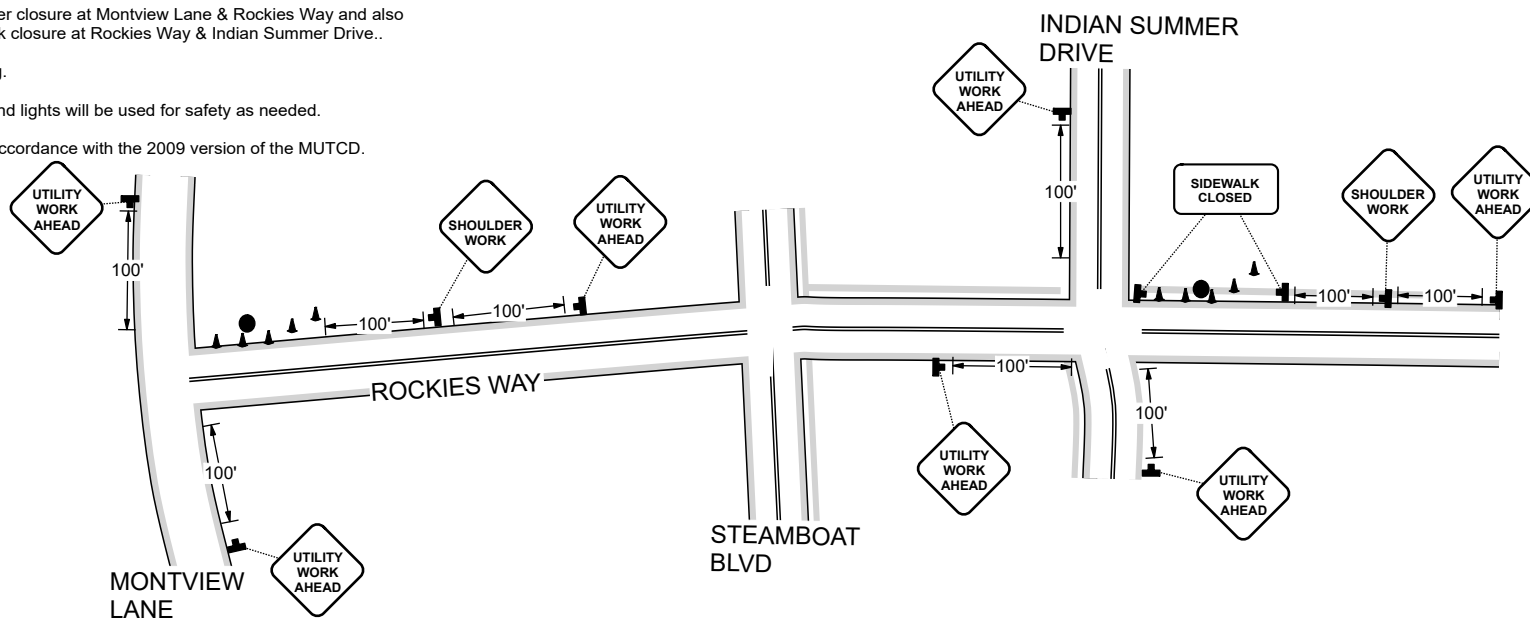

PERMIT NUMBER: \_\_\_\_\_ EXPIRATION DATE: \_\_\_\_\_

TRAFFIC CONTROL SUPERVISOR:   Maria Slane   DATE: 12/14/2021

PERMITTEE/CONTRACTOR: \_\_\_\_\_ DATE: \_\_\_\_\_

REVIEWED AND ACCEPTED: \_\_\_\_\_ DATE: \_\_\_\_\_



633 34 Road  
Clifton, CO 81520  
Office: 970-257-7400

Prepared By:  
Maria Slane ATSSA TCS  
Cert# 489139 Exp: 01/19/2022  
Office: 970 257-7400  
Cell: 970 985-9486



CONTRACTOR: LUMEN

PROJECT: 2305 MOUNT WERNER CIR, STEAMBOAT SPRINGS N.945301

METHOD OF HANDLING TRAFFIC: SHOULDER CLOSURE WITH FLAGGER/SIDEWALK CLOSURE with DETOUR

DATE: 12/14/2021

#### NOTES:

1. Contractor will require a shoulder closure at at the entrance of Highmark (2525 Village Dr) and also a sidewalk closure with detour.
2. A flagger will be utilized to assist vehicles in and out of the driveway and all business access will remain open.
3. Signs will be set at 100' spacing.
4. All hazards will be barricaded and lights will be used for safety as needed.
5. All work shall be performed in accordance with the 2009 version of the MUTCD.

#### Legend



Cone

#### DEVICES

- 9 x Cone
- 2 x W21-7 utility work ahead
- 1 x flagger flagger
- 2 x W20-7a flagger
- 1 x R9-11a(L) Sidewalk Closed, Cross Here R9-11a(L)
- 1 x M4-9 detour (R)
- 1 x M4-9 detour (L)
- 1 x R9-11a(R) Sidewalk Closed, Cross Here R9-11a(R)

PERMIT NUMBER: \_\_\_\_\_

EXPIRATION DATE: \_\_\_\_\_

TRAFFIC CONTROL SUPERVISOR: \_\_ Maria Slane \_\_\_\_\_

DATE: 12/14/2021

PERMITTEE/CONTRACTOR: \_\_\_\_\_ DATE: \_\_\_\_\_

REVIEWED AND ACCEPTED: \_\_\_\_\_ DATE: \_\_\_\_\_

