

Bldgs 1, 2 & 3

6 Units per Building for a total of 18 Units

**STRUCTURES A&C - ELECTRICAL LOAD  
TOTAL (3) OF THIS UNIT TYPE PER BUILDING**

- 40 amp range
- 15 amp dishwasher
- MCA 28.7A outdoor mini-split condenser
- 100 Amp Hot Water Heater
- 5.3A Cove heat in Upstairs Bathroom (1,250 W)
- 10.4A Cove Heat in Living Area (2,500 W)
- 40 Amp EV Charger Outlet
- .33 Amp ERV
- 3 amp fridge
- 12 amp microwave
- 5 amp washer
- 20 amp dryer

**STRUCTURES B&D - ELECTRICAL LOAD  
TOTAL (3) OF THIS UNIT TYPE PER BUILDING**

- 40 amp range
- 15 amp dishwasher
- MCA 28.7A outdoor mini-split condenser
- 100 Amp Hot Water Heater
- 5.3A Cove heat in Upstairs Bathroom (1,250 W)
- 10.4A Cove Heat in Living Area (2,500 W)
- 40 Amp EV Charger Outlet
- .33 Amp ERV
- 3 amp fridge
- 12 amp microwave
- 5 amp washer
- 20 amp dryer
- additional 25 Amp Hot Water Heater
- 5.3A Cove heat in Powder Bathroom (1,250 W)

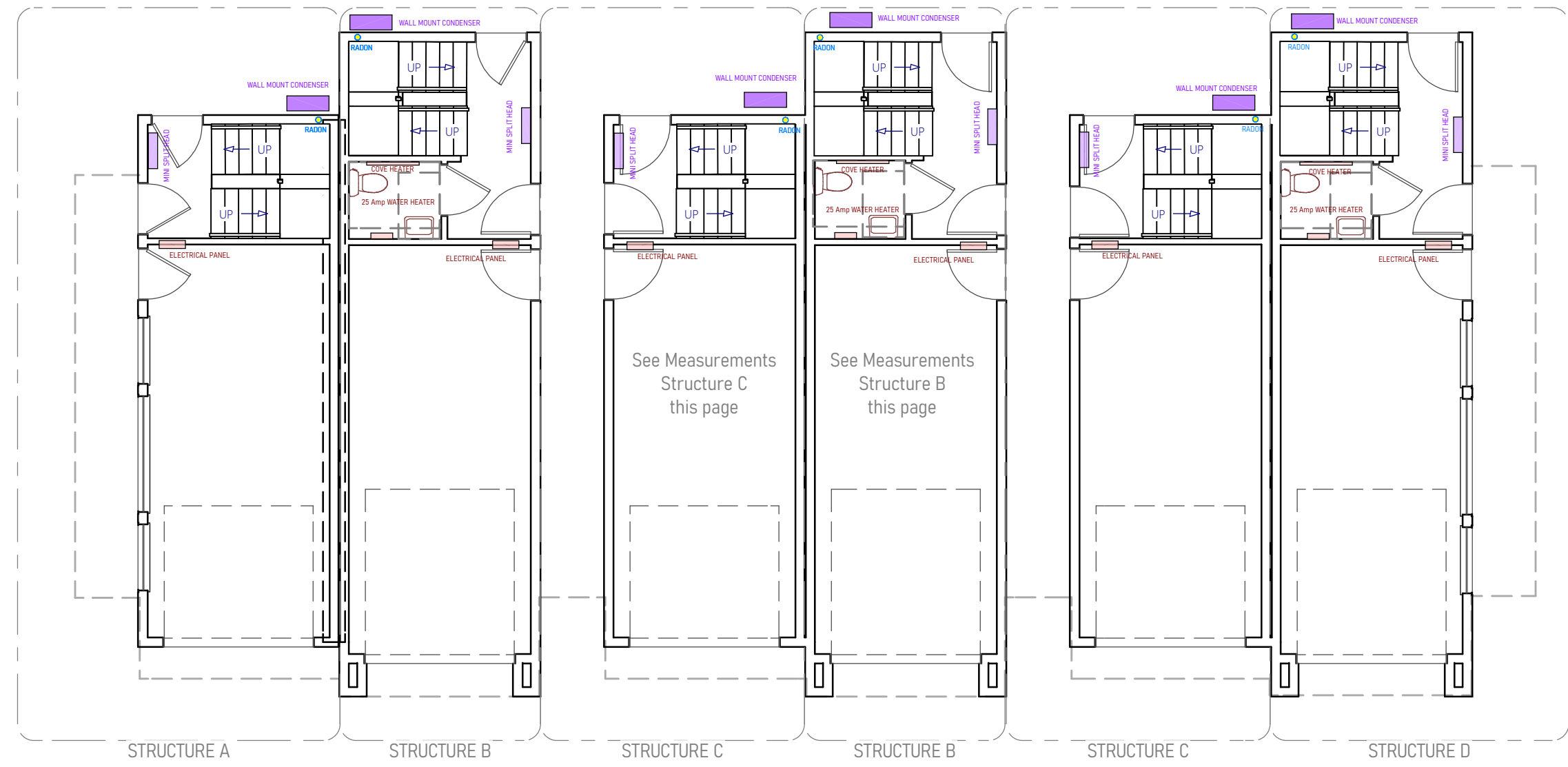

**GROUND STORY HEAT** Scale 1/4" = 1'-0"



**MID STORY HEAT** Scale 1/4" = 1'-0"



**SECOND STORY HEAT** Scale 1/4" = 1'-0"

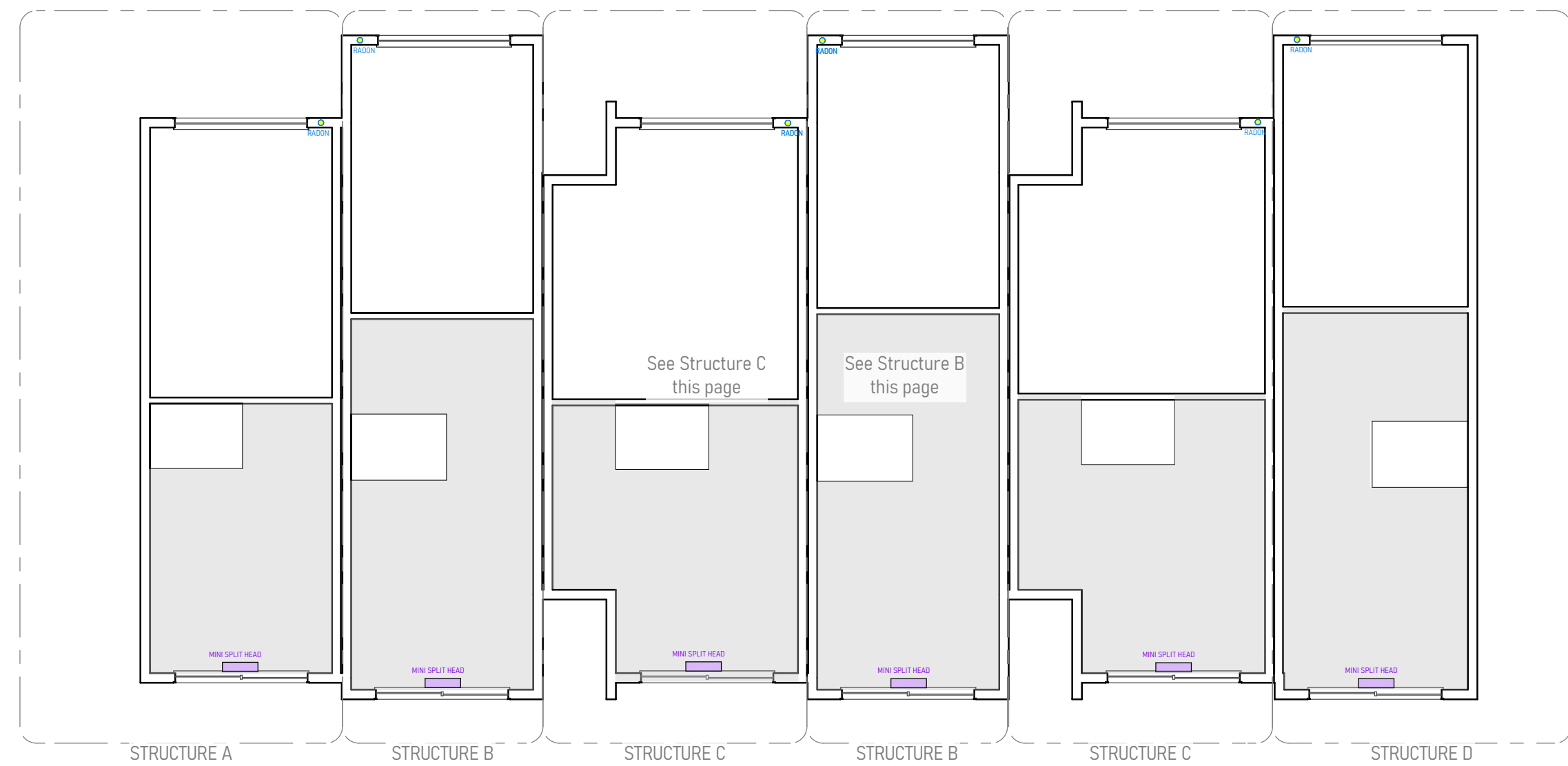

**STORAGE HEAT** Scale 1/4" = 1'-0"

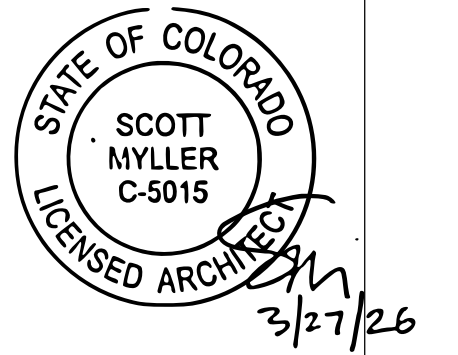

DRAWINGS & DESIGN BY:  
Calais Kruse  
Steamboat Springs  
229-798-2145  
www.calaiskruse.com

DATE REVISIONS REVISOR DESCRIPTION

PROJECT/CLIENT:

"EDDYLINE"  
1940 Bridge Lane, Steamboat  
FUTURE EXPANSION PARCEL, RIVERFRONT PARK F2, 2.17A

Mechanical

SHEET:

M1

DRAWINGS DATED:  
3/26/2026