



CRAIG FRITHSEN
ENGINEERING, LLC

PROFESSIONAL ENGINEERING & DRAFTING SERVICES

PO BOX 772759 | STEAMBOAT SPRINGS, CO 80477

PHONE 970-846-7980 | craigfrithsen@gmail.com

RCRBD
Record Set
TC
11/25/2020

THE STRUCTURAL DETAILS ON THIS AND FOLLOWING PAGES ARE FOR THE PROPOSED NEW DOOR OPENING IN THE BRICK AND CMU BEARING WALL BETWEEN THE LAUNDRY AND CREEKSIDE RESTAURANTS. THESE DETAILS WERE REVISED BASED ON A 11-25 SITE INSPECTION OF THE WALL WITH THE PROPOSED ROUGH OPENING IN PLACE.

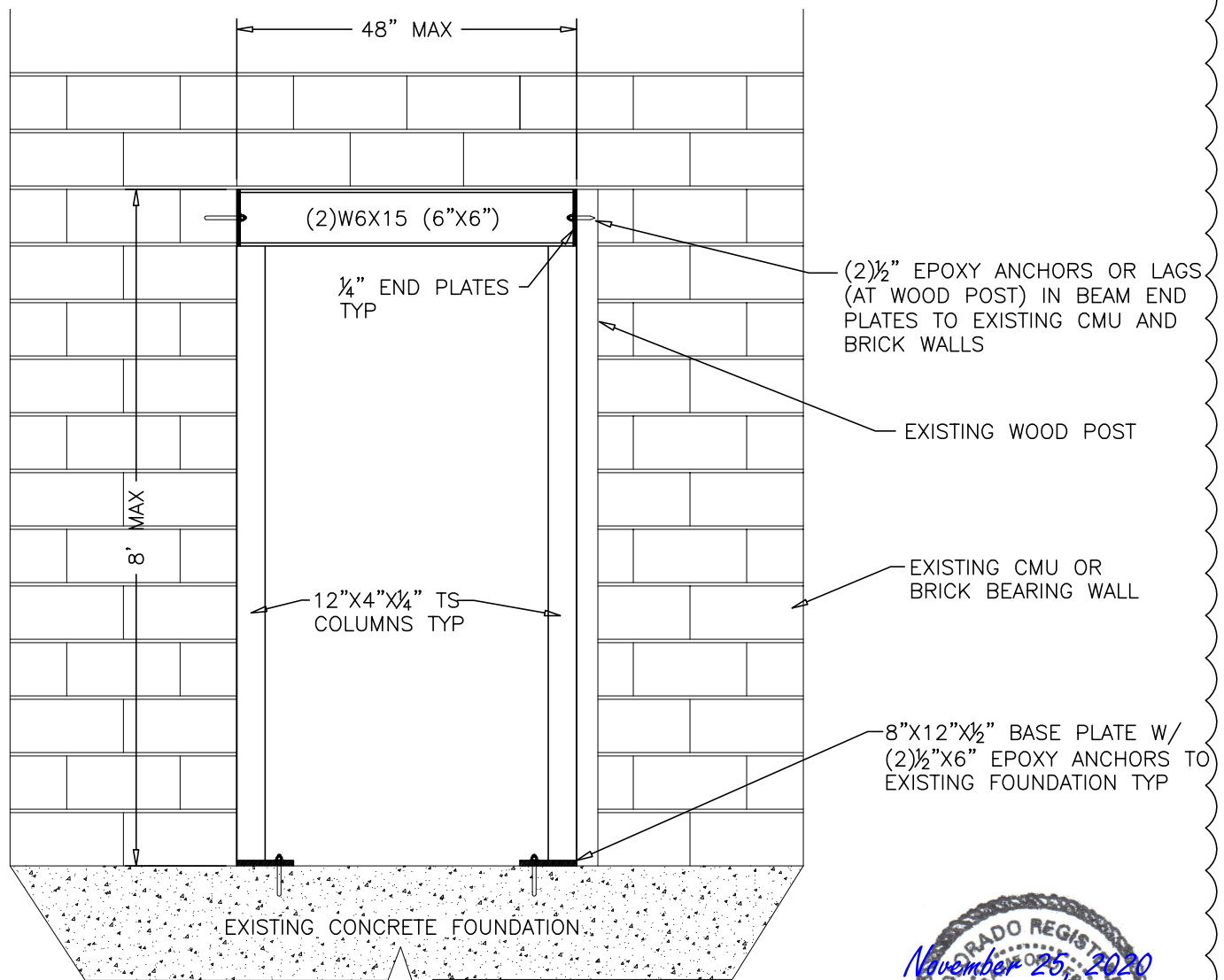

1
S1 HEADER DETAIL
Scale: 1/2" = 1'-0"



CREEKSIDE/LAUNDRY REMODEL

131 11TH STREET
STEAMBOAT SPRINGS, CO



CRAIG FRITHSEN
ENGINEERING, LLC

PROFESSIONAL ENGINEERING & DRAFTING SERVICES

PO BOX 772759 | STEAMBOAT SPRINGS, CO 80477

PHONE 970-846-7980 | craigfrithsen@gmail.com

CRBD
Record Set
TC
11/25/2020

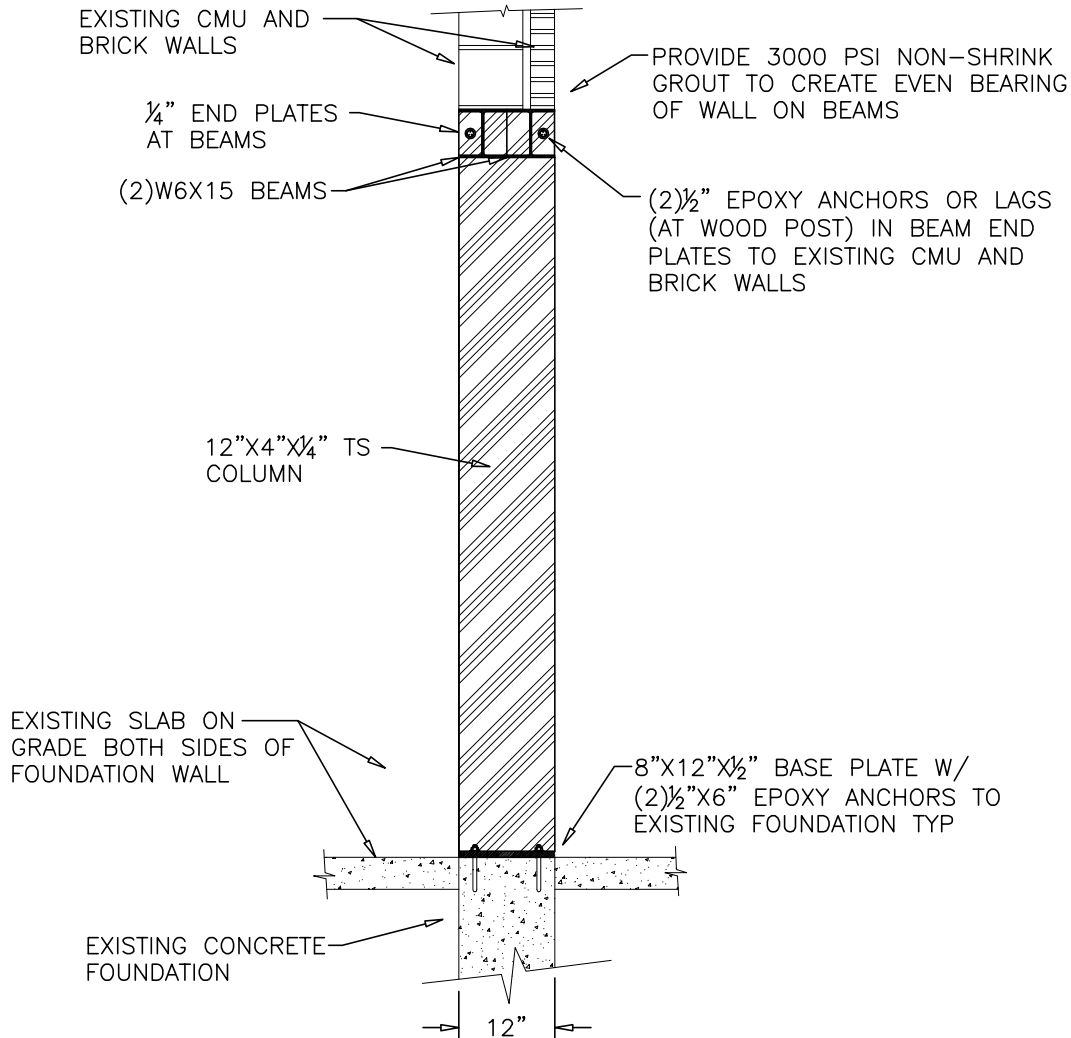

1
S2

HEADER SECTION

Scale: 1/2" = 1'-0"

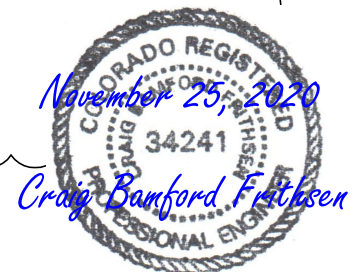

CREEKSIDE/LAUNDRY REMODEL

131 11TH STREET
STEAMBOAT SPRINGS, CO



CRAIG FRITHSEN
ENGINEERING, LLC

PROFESSIONAL ENGINEERING & DRAFTING SERVICES

PO BOX 772759 | STEAMBOAT SPRINGS, CO 80477
PHONE 970-846-7980 | craigfrithsen@gmail.com

CRBD
Record Set
TC
11/25/2020

GENERAL

- DESIGN LIVE LOADS: Snow=75 psf, Floor=50 psf + 20 psf partition (upstairs office loading Laundry building) and 100 psf (main floor slabs Laundry and Creekside buildings), Wind, Vult=115 mph (3 Second Gust), Seismic Zone B
- RESPONSIBILITY: The contractor is responsible for cross referencing all plans and inspecting work placement at the site to assure that no omissions or discrepancies exist that might adversely affect construction or the integrity of the finished product. Job site and construction safety are not addressed in these plans and are the responsibility of the contractor. These responsibilities are industry standard.
- These plans are intended to be in accordance with 2015 IBC codes. All construction to be in conformance with these codes.

FOUNDATION

- Foundation analyzed assuming maximum allowable soil bearing pressure = 2500 psf, no min. We recommend a soils engineer verify that soils types and conditions warrant assumed values. CFE is not responsible for structural issues resulting from improperly assumed soils.

STRUCTURAL STEEL

- All structural steel shall conform to ASTM specifications A36 except pipe columns which shall conform to ASTM A53 Grade B, and steel tube columns which shall conform to ASTM A500 Grade B. Steel to steel member connection bolts shall be A325 steel and miscellaneous wood embedded items shall be A36 steel.
- Steel column base plates shall bear evenly to concrete below via 4000 psi non shrink grout.
- Minimum welds to be per AISC and/or AWS, but not less than 3\16" continuous fillet unless otherwise noted. Welding quality control shall be per AWS. All welders shall have evidence of passing the American Welding Society Standard Qualifications Test as detailed in AWS D1.1.

TYPICAL ABBREVIATIONS

EE = EACH END
ES = EACH SIDE
EW = EACH WAY
OC = ON CENTER
SOG = SLAB ON GRADE
TYP = TYPICAL
UNO = UNLESS NOTED OTHERWISE

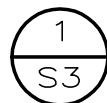
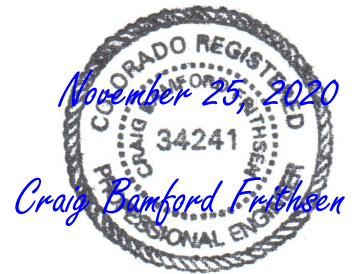

STRUCTURAL NOTES

Scale: NTS

CREEKSIDE/LAUNDRY REMODEL

131 11TH STREET
STEAMBOAT SPRINGS, CO