

Model: SQ-140-VG

Direct Drive Centrifugal Inline Fan

Dimensional	
Quantity	1
Weight w/o Acc's (lb)	102
Weight w/ Acc's (lb)	123
Optional Damper (in.)	20 x 20

Performance	
Requested Volume (CFM)	1,800
Actual Volume (CFM)	1,800
Total External SP (in. wg)	0.7
Fan RPM	1377
Operating Power (hp)	0.41
Elevation (ft)	6,283
Airstream Temp.(F)	70
Air Density (lb/ft3)	0.059
Tip Speed (ft/min)	5,250
Static Eff. (%)	48

Misc Fan Data	
Fan Energy Index (FEI)	1.43
Outlet Velocity (ft/min)	664

Motor	
Motor Mounted	Yes
Size (hp)	1
Voltage/Cycle/Phase	208/60/3
Enclosure	TEFC
Motor RPM	1600
Windings	1
FLA (Amps)	3.6
Min. Circuit Ampacity (MCA)	5
Max. Overcurrent Protection (MOP)	15
Short Circuit Current Rtg (SCCR)	5 kA

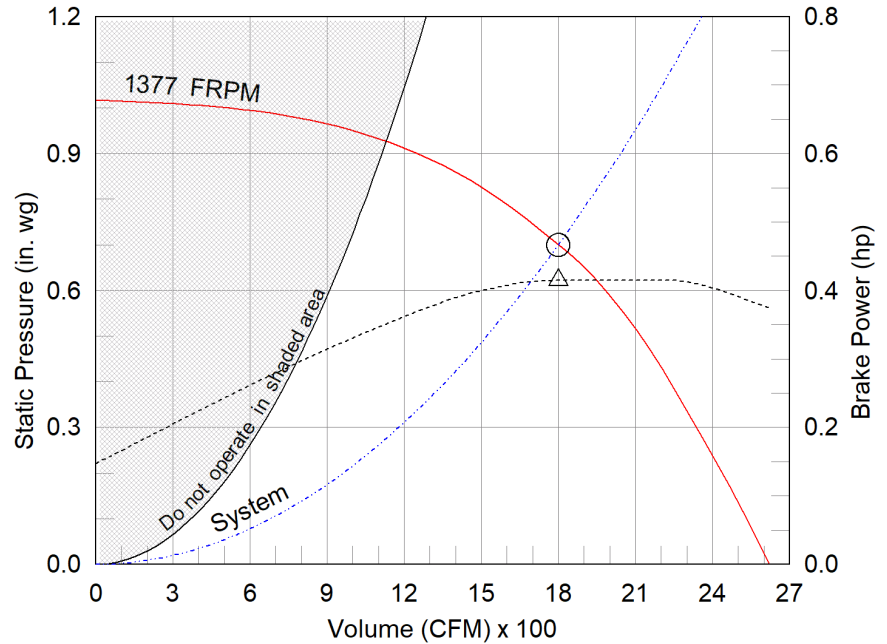

- △ Operating Bhp point
- Operating point at Total External SP
- Fan curve
- - - System curve
- - - Brake horsepower curve

Nameplate Model: SQ-140-VG-X

Sound Power by Octave Band

Sound Data	62.5	125	250	500	1000	2000	4000	8000	LwA	dBA	Sones
Inlet	72	74	79	72	66	64	61	58	75	63	12.3
Radiated	75	75	75	67	58	49	43	42	69	58	8.5

Notes:

All dimensions shown are in units of in.
*Please consult factory for actual motor amp draw
LwA - A weighted sound power level, based on ANSI S1.4
dBA - A weighted sound pressure level, based on 11.5 dB
attenuation per Octave band at 5 ft - dBA levels are not
licensed by AMCA International
Sones - calculated using AMCA 301 at 5 ft



Model: SQ-140-VG

Direct Drive Centrifugal Inline Fan

Greenheck model SQ Mixed Flow meets or exceeds legacy centrifugal models SQ/BSQ in performance and features. SQ Mixed flow is an approved equal and can be considered a direct replacement for these models.

Standard Construction Features:

- Galvanized steel housing - Backward inclined composite (sizes 60-95) or aluminum (sizes 97-160) wheel - Two bolted access panels - Integral duct connection flanges - Ball bearing motors (sizes 97-160 and all vari-green motors), sleeve bearing motors (sizes 60-95) - Corrosion resistant fasteners

Selected Options & Accessories:

Motor with Shaft Grounding

Motor - Vari-Green EC motor

Control - Vari-Green Dial on Exterior of Fan Housing, Mounted and Wired

UL/cUL 705 Listed - "Power Ventilators"

Junction Box Mounted and Wired

Switch, NEMA-1, Toggle, Shipped Separate

Galvanized Housing

Aluminum Centrifugal Wheel

Composite Inlet Cone

Fan: Spring, Hanging, 1 Inch Isolator PN: 850343, Incl. 4 isolators and 4 brackets

Damper Shipped Loose, Inline, WD-330-PB-20X20, Gravity Operated, Not Coated

Unit Warranty: 1 Yr (Standard)

SQ-140-VG

Direct Drive Centrifugal Inline Fan

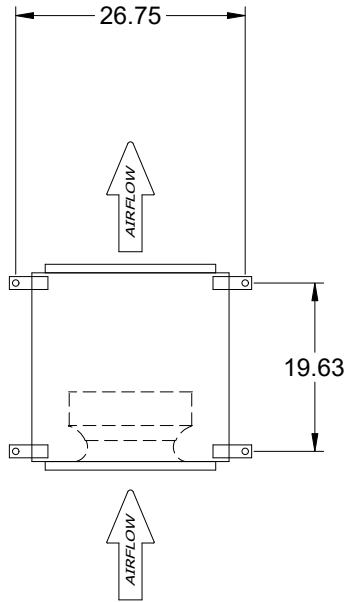

TOP VIEW

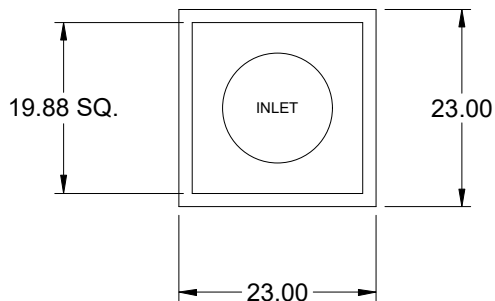

END VIEW

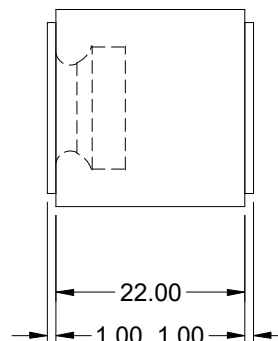

SIDE VIEW

Notes: All dimensions shown are in units of in.

Disconnect Switch

Enclosure Rating: NEMA-1

Standard Construction Features:

Enclosure constructed for indoor use to provide a degree of protection to personnel against incidental contact with the enclosed equipment and to provide a degree of protection against falling dust. This enclosure meets the rod entry and the indoor corrosion protection design tests. The rod entry test is intended to simulate incidental contact with enclosure equipment. Enclosure is equipped with provision to lockout in the off position with customer supplied lock.

Disconnect Switch Configuration

Type:	Toggle	Motor Size:	1 hp	Voltage:	208	UL Listed:	Yes
Manufacturer:	Square D	Cycle:	60	Amperage:	30	CSA Approved:	Yes
Overload Protection:	None	Phase:	3	Switch Pole(s):	3	Rating:	10 hp
Junction Box Mtg.:	Ship Separate	RPM:	1600	Exp. Resist. Wiring:	None		
Switch Mounting:	Shipped Separate						

Electrical Drawing Details

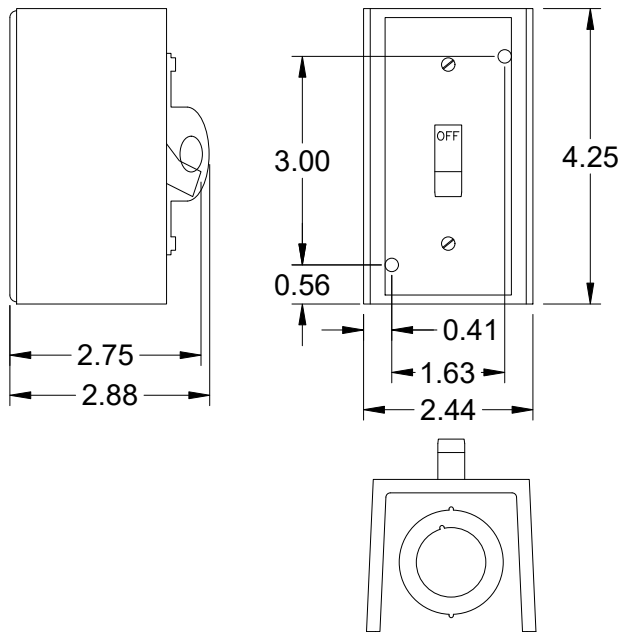

Wiring Schematic

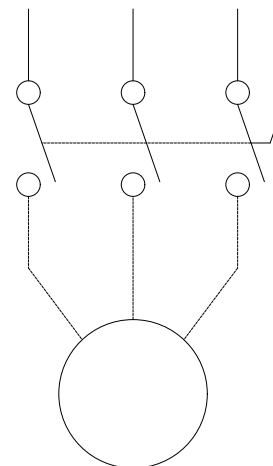

Notes: All dimensions shown are in units of in.

Vari-Green Motor & Control Options

An EC motor that uses AC input power and internally converts it to DC power. Motor accepts a 0-10VDC control signal. Motor is operable in the 2-10VDC range and off while in the 0-1.9VDC range. Vari-Green motors feature a soft-start and inherent thermal and current protection built into each unit. Inrush current at start up is eliminated and the motor will automatically reduce speed or turn off if overloaded or it becomes too hot.

An EC motor that uses AC input power and internally converts it to DC power. Potentiometer (dial) mounted on the fan housing adjusts the speed (RPM) down 80%. Vari-Green motors feature a soft-start and inherent thermal and current protection built into each unit. Inrush current at start up is eliminated and the motor will automatically reduce speed or turn off if overloaded or it becomes too hot.

Motor Configuration

Input Voltage: 208
Speed Reference: 0-10VDC
Permanent Dial: No
Balance Dial Included: No

Control Configuration

Control Type: Dial on Fan
Transformer: None

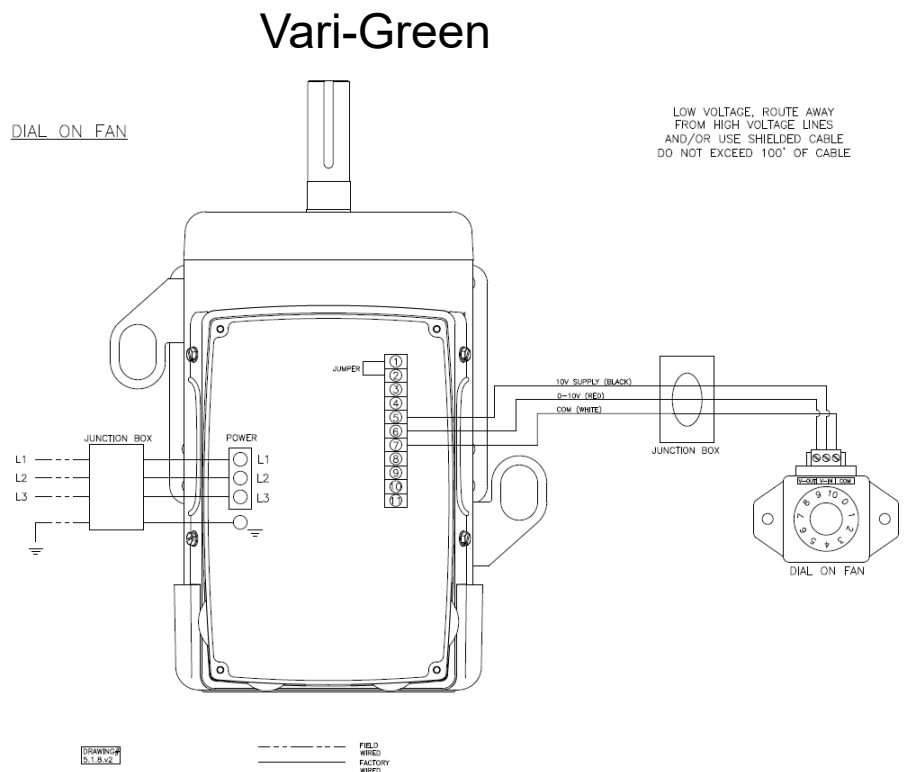

Vertical Mount Exhaust Damper

Model: WD-330

Standard Construction Features:

- Model WD-330 is a vertical mount exhaust damper and is constructed of galvanized steel with pre-punched mounting holes - Damper blades are 0.025 in. roll formed aluminum with vinyl seals on the closing edge - Steel axles are 0.188 in. diameter zinc plated steel - Nylon type bushings

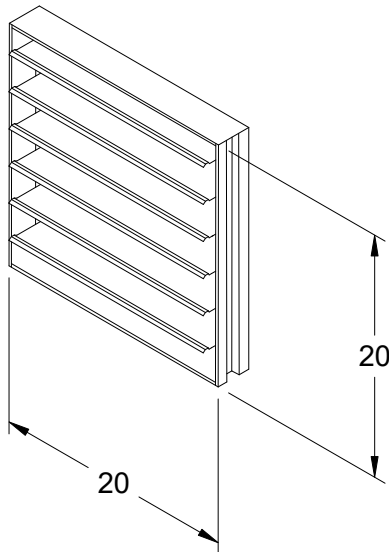

DAMPER

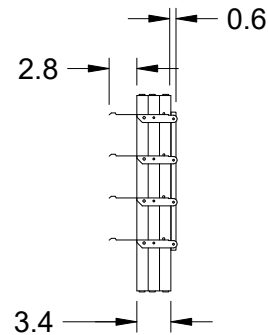

TYP. SECTION VIEW

Notes: All dimensions shown are in units of in.
Width And height furnished approximately 0.125 in. undersize

Fan Isolator

Type: Spring, Hanging, 1 Inch

Standard Construction Features:

The spring hanging isolator is designed to reduce the transmission of vibration and noise produced by suspended equipment and piping. To assure stability, the spring element has a minimum lateral stiffness of 1.0 times the rated vertical stiffness. The hanger will allow a support rod misalignment through a 30 degree arc and the isolation brackets will carry a 500% overload without failure. The isolator has an epoxy powder coated bracket and spring coil which is color coded according to the load capacity and has a noise isolation pad, all which is assembled into a stamped or welded hanger bracket. This part number includes 4 isolators.

Isolator Configuration

Description:	SH-1-35	Color:	Blue
Manufacturer:	Kinetics Noise Control	Mounting:	Hanging
Load Capacity:	35 lb	Kit Part Number:	850343
Deflection at Full Load:	1.52	Selection Deflection (in.):	1.11

Spring, Hanging, 1 Inch Deflection - Vibration Isolator

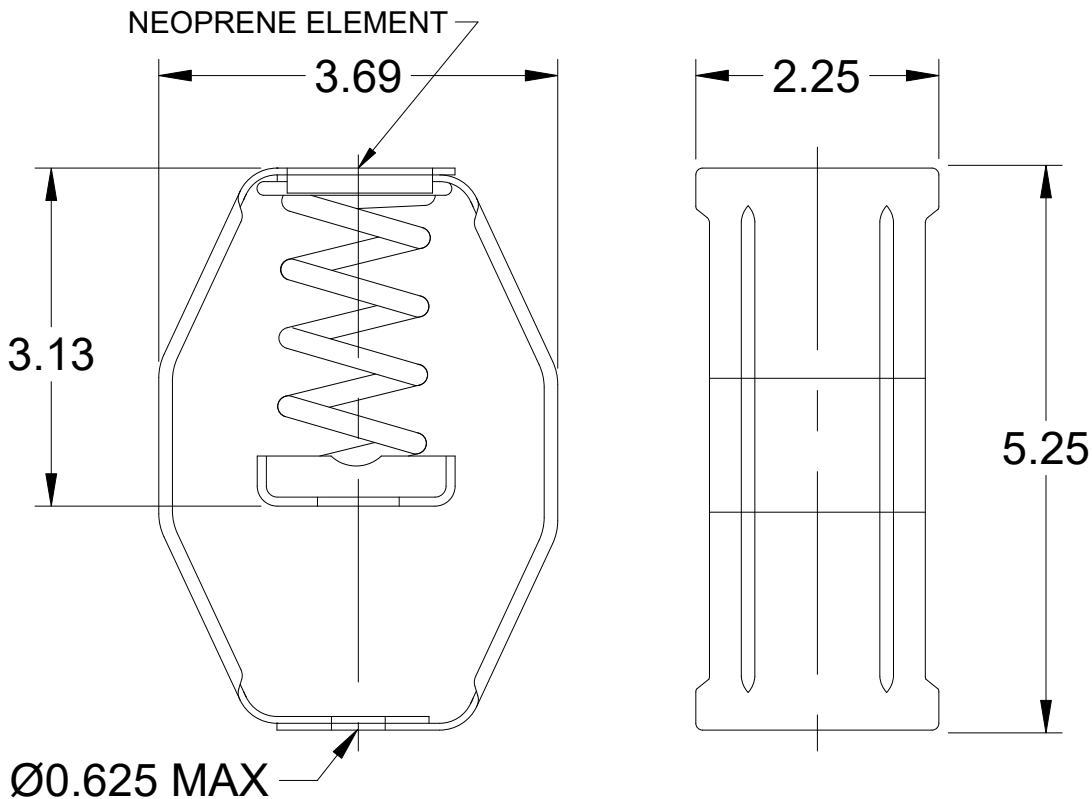

Notes: All dimensions shown are in units of in.

SQ-140-VG

Min/Max Fan Curve

Performance

Requested Volume (CFM)	Actual Volume (CFM)	Total External SP (in. wg)	Fan RPM	Operating Power (hp)
1,800	1,800	0.7	1377	0.41

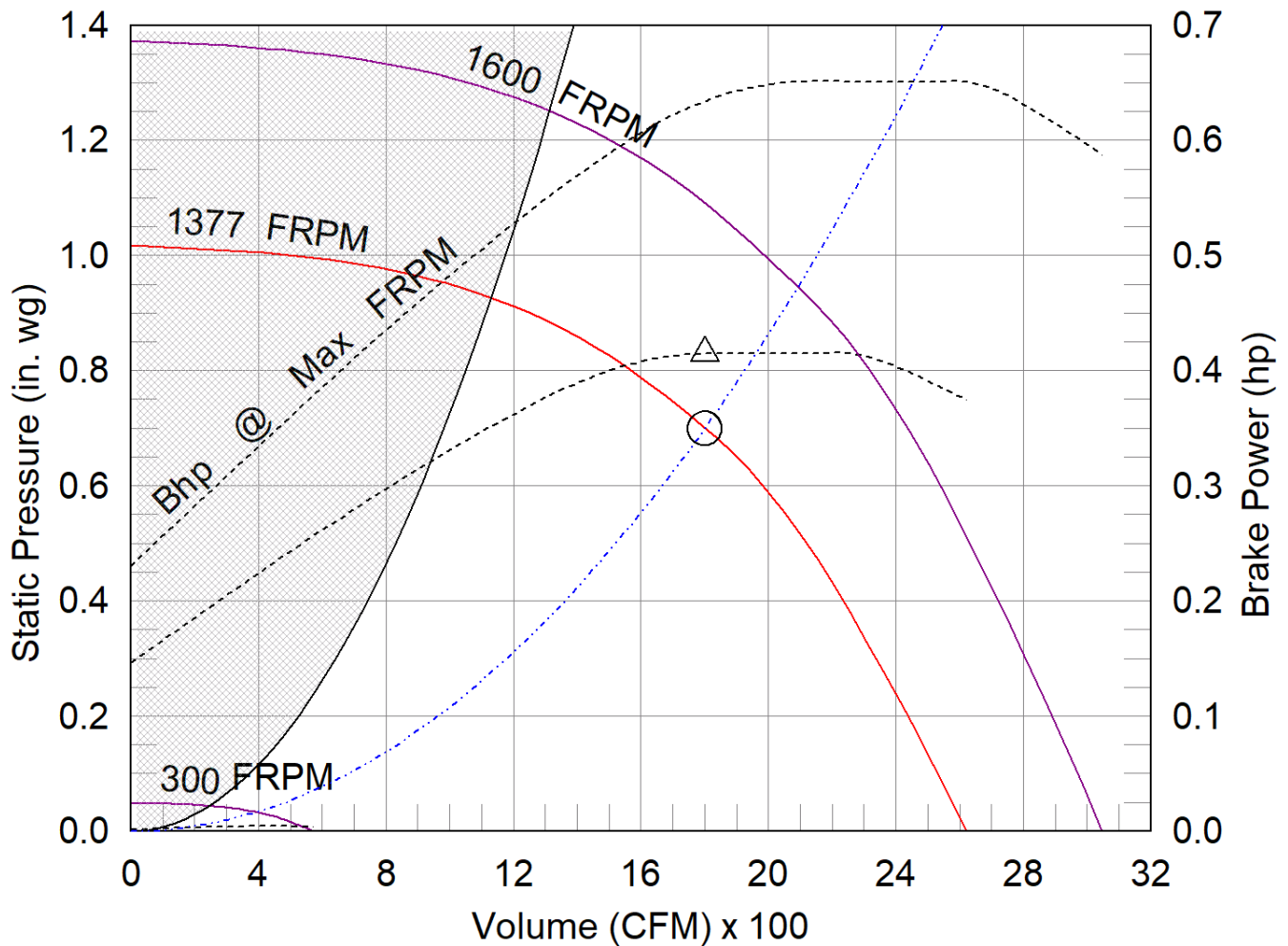

- △ Operating Bhp point
- Operating point at Total External SP
- Construction Limit
- Fan curve
- Min FRPM
- System curve
- Brake horsepower curve

Warranty

1 Yr (Standard)

WARRANTY AND LIABILITY: SELLER warrants to Buyer that products manufactured are free from defects in material and workmanship for a period of 1 Yr (Standard) from the date of shipment. SELLER's obligations and liabilities under this warranty are limited to furnishing FOB factory or warehouse at SELLER's designated shipping point, freight allowed to Buyer's city, (or point of export for shipments outside the conterminous United States) replacement equipment (or at the option of SELLER parts therefore) for all Seller's products not conforming to this warranty and which have been returned to the manufacturer. No liability whatever shall attach to SELLER until said products have been paid for and such liability shall be strictly limited to the purchase price of the equipment shown to be defective. Motors are warranted by the motor manufacturer for a period of one year. Should motors furnished by SELLER prove defective during this period, they should be returned to the nearest authorized motor service station. SELLER will not be responsible for any removal or installation costs. Electrical components, excluding motors, are warranted only to the extent warranted by the original manufacturer. To the extent that SELLER is entitled to pass through a warranty of the original equipment manufacturer of the electrical goods sold, SELLER will pass through such warranties to Buyer. The legal remedies described in this Warranty are the sole exclusive remedy of Buyer. SELLER MAKES NO OTHER WARRANTY, EITHER EXPRESS OR IMPLIED, REGARDING ITS PRODUCTS, OR ITS SELECTION AND APPLICATION, INCLUDING, BUT NOT LIMITED TO, COMPLIANCE WITH BUILDING CODES, SAFETY CODES, LAWS, MERCHANTABILITY OR FITNESS OR A PARTICULAR PURPOSE. This warranty is extended solely to the Buyer. It is nontransferable and non-assignable, and the Buyer shall not permit or authorize its employees, agents, representatives or customers to claim, represent or imply that this limited warranty extends or is available to anyone other than the Buyer. ANY MISUSE, NEGLIGENCE, FAILURE TO FOLLOW INSTRUCTIONS OR MANUALS OF INSTALLATION OF MAINTENANCE REPAIR, SERVICE, RELOCATION OR ALTERATION TO OR OF, OR OTHER TAMPERING WITH, THE PRODUCTS PERFORMED BY ANY PERSON OR ENTITY OTHER THAN SELLER WITHOUT SELLER'S PRIOR WRITTEN APPROVAL OR ANY USE OF REPLACEMENT PARTS NOT SUPPLIED BY SELLER, SHALL IMMEDIATELY VOID AND CANCEL ALL WARRANTIES WITH RESPECT TO THE AFFECTED PRODUCTS. THE WARRANTY AND LIABILITY SET FORTH HEREIN ARE IN LIEU OF ALL OTHER WARRANTIES AND LIABILITIES WHETHER IN CONTRACT OR IN NEGLIGENCE, EXPRESSED OR IMPLIED, IN LAW OR IN FACT, INCLUDING IMPLIED WARRANTIES OF MERCHANTABILITY AND FITNESS FOR A PARTICULAR USE. SELLER PROVIDES NO INDEPENDENT WARRANTY FOR THIRD PARTY PRODUCTS OR COMPONENTS SOLD TOGETHER OR INCORPORATED WITH SELLER'S PRODUCT(S). THE SELLER HAS THE RIGHT TO SETTLE ANY AND ALL DISPUTES REGARDING THE WARRANTY.

AMCA



AMCA Licensed for Sound and Air Performance. Power rating (BHP/kW) does not include transmission losses.

Greenheck Fan Corporation certifies that the model shown herein is licensed to bear the AMCA Seal. The ratings shown are based on tests and procedures performed in accordance with AMCA Publication 211 and AMCA Publication 311 and comply with the requirements of the AMCA Certified Ratings Program. Performance certified is for installation type B: Free inlet, Ducted outlet. Power rating (BHP/kW) does not include transmission losses. Performance ratings do not include the effects of appurtenances (accessories). The inlet sound ratings shown are loudness values in fan sones at 5 ft. (1.5 m) in a hemispherical free field calculated per AMCA Standard 301. Values shown are for installation type B: free inlet hemispherical sone levels. dBA levels are not licensed by AMCA International. The AMCA Certified Ratings Seal applies to inlet sone ratings only. Radiated (casing) sound data is the sound generated through the fan housing when the fan is ducted on both the inlet and outlet.