

DESIGN BASIS:

CODES AND DESIGN LOADS-
THESE PLANS WERE PREPARED BASED ON THE 2021 I-CODES, AS AMENDED BY THE LOCAL JURISDICTION, AND
MOST RECENT VERSIONS OF THE NDS, ACI 318, AND AISC.

SNOW LOADS- $p_g=325$ PSF, $C_e=0.9$, $I_e=1.1$, $C_t=1.2$
WIND LOADS- BASIC WIND SPEED $V=115$ MPH, $V_{350}=90$ MPH, RISK CATEGORY III, EXPOSURE C
SEISMIC LOADS- RISK CATEGORY III, $I_e=1.25$, SITE CLASS D, $S_{DS}=0.525$, SDC D, CANTILEVERED COLUMN
SYSTEM, $V=3.40$ LBS, $C_e=0.44$, $R=1.5$, EQUIVALENT LATERAL FORCE PROCEDURE
FROST DEPTH- 48"

GEOTECHNICAL INFORMATION-
SOIL BRG PRESSURE- 4,000 PSF ALLOWABLE

ALLOWABLE SOIL BEARING PRESSURE WAS ASSUMED BASED ON PRESUMPTIVE LOAD-BEARING VALUES FOR SEDIMENTARY ROCK IN IRC TABLE R401.4.1. WE RECOMMEND AN OPEN-HOLE INSPECTION BE PERFORMED BY THE GEOTECHNICAL ENGINEER OF RECORD PRIOR TO CONSTRUCTION TO CONFIRM SOIL CONDITIONS. STRUCTURAL SUPPORT, LLC SHALL BE NOTIFIED IF SOIL CONDITIONS ARE INCONSISTENT WITH THOSE REFERENCED ABOVE, AND ADDITIONAL EVALUATION OR FOUNDATION REDESIGN MAY BE REQUIRED. ALL FOOTINGS SHOULD BEAR ON NATIVE UNDISTURBED SOIL.

MATERIAL SPECIFICATIONS:

CONCRETE-
CONCRETE SHALL HAVE A MINIMUM 28 DAY COMPRESSIVE STRENGTH OF 4,500 PSI AND SHALL CONTAIN ASTM C595 TYPE IP(MS) TYPE II CEMENT. TOTAL AIR CONTENT SHALL BE 5-7%. AGGREGATE SHALL NOT BE LARGER THAN 1".

REINFORCING-
REINFORCING STEEL BARS SHALL BE GRADE 60 STEEL AND SHALL COMPLY WITH ASTM A615 REQUIREMENTS
COVER AND LAP SPLICES SHALL BE AS SHOWN ON PLANS.

TIMBER-
ALL STRUCTURAL TIMBERS SHALL BE DOUG FIR #1 OR BETTER UNLESS NOTED OTHERWISE ON PLANS
DIMENSIONS SHOWN ON PLANS ARE ROUGH SAWN DIMENSIONS.

STRUCTURAL STEEL-
STRUCTURAL STEEL SHALL CONFORM TO THE FOLLOWING GRADES AND SPECIFICATIONS

STEEL PLATES AND PLATE WASHERS- ASTM A36, MINIMUM YIELD STRESS OF 36 KSI
BOLTS- ASTM F3125 GR. A325, MINIMUM TENSILE STRESS OF 120 KSI
NUTS- ASTM A563 GRADE A HEX NUT
ANCHOR RODS - ASTM F1554 GR. 36, MINIMUM YIELD STRESS OF 36 KSI

ALL STRUCTURAL STEEL PLATES, BOLTS NUTS, AND WASHERS FOR TIMBER BASE CONNECTION SHALL EITHER BE POWDER COATED OR HOT DIPPED GALVANIZED AFTER FABRICATION.

ALL ANCHOR RODS AND ASSOCIATED WASHERS, PLATE WASHERS, AND NUTS SHALL BE HOT DIPPED GALVANIZED.

WELDS-
WELDING SHALL CONFORM TO AWS D1.1 AND SHALL UTILIZE E70XX ELECTRODES.

FOOTINGS AND PADS:

ALL FOOTINGS SHALL BE A MINIMUM OF 48" BELOW GRADE AND SHALL BE PLACED ON NATIVE UNDISTURBED SOIL OR CONTROLLED FILL COMPACTED TO A MINIMUM OF 95% OF STANDARD PROCTOR MAXIMUM DRY DENSITY, AS DETERMINED IN ACCORDANCE WITH ASTM D 698, AT A MOISTURE CONTENT WITHIN 2% OPTIMUM.

LIMITATIONS:

ALL DIMENSIONS SHOWN ON STRUCTURAL DRAWINGS ARE BASED ON THE ARCHITECTURAL PLANS. IT IS THE CONTRACTOR/OWNER'S RESPONSIBILITY TO VERIFY AND COORDINATE ALL DIMENSIONS PRIOR TO CONSTRUCTION. ANY DISCREPANCIES OR CHANGES SHOULD BE BROUGHT TO THE ATTENTION OF THE ENGINEER.

CONTRACTOR SHALL VERIFY ALL EXISTING CONDITIONS PRIOR TO COMMENCING WORK AND SHALL DETERMINE THE LOCATION OF ALL ADJACENT UNDERGROUND UTILITIES PRIOR TO COMMENCING EXCAVATION.

CONTRACTOR SHALL BE RESPONSIBLE FOR ALL SAFETY PRECAUTIONS AND THE METHODS, TECHNIQUES, SEQUENCES, OR PROCEDURES REQUIRED TO PERFORM THE WORK.

RECOMMENDED TESTS AND INSPECTIONS:

QUALITY ASSURANCE OBSERVATIONS AND TESTING SHOULD BE PERFORMED FOR THE FOLLOWING ITEMS IN ADDITION TO ANY INSPECTIONS REQUIRED BY THE LOCAL BUILDING JURISDICTION:

- OPEN-HOLE SOIL VERIFICATION
- FOUNDATION SUBGRADE/COMPACTION
- FOOTING FORMWORK AND REINFORCEMENT
- PILLAR FORMWORK AND REINFORCEMENT
- CONCRETE MATERIAL TESTING
- CAST-IN ANCHOR BOLT INSTALLATION

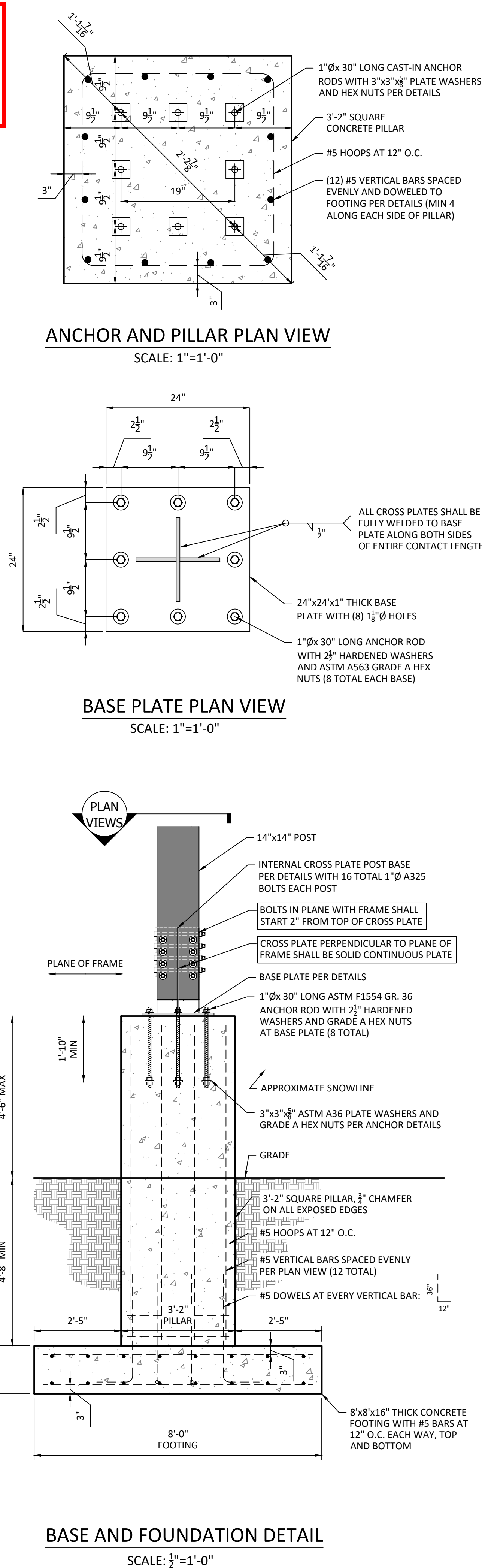
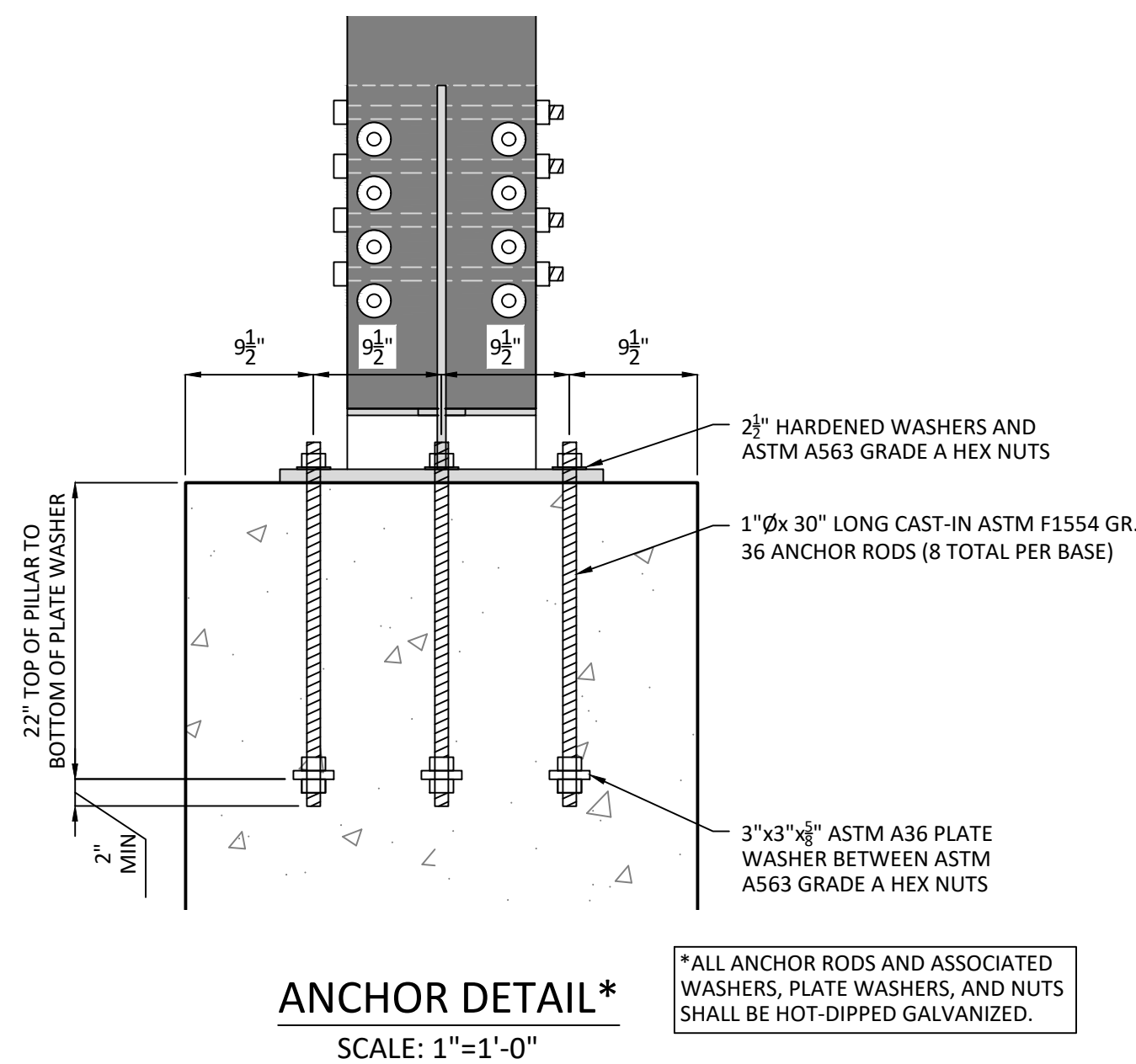
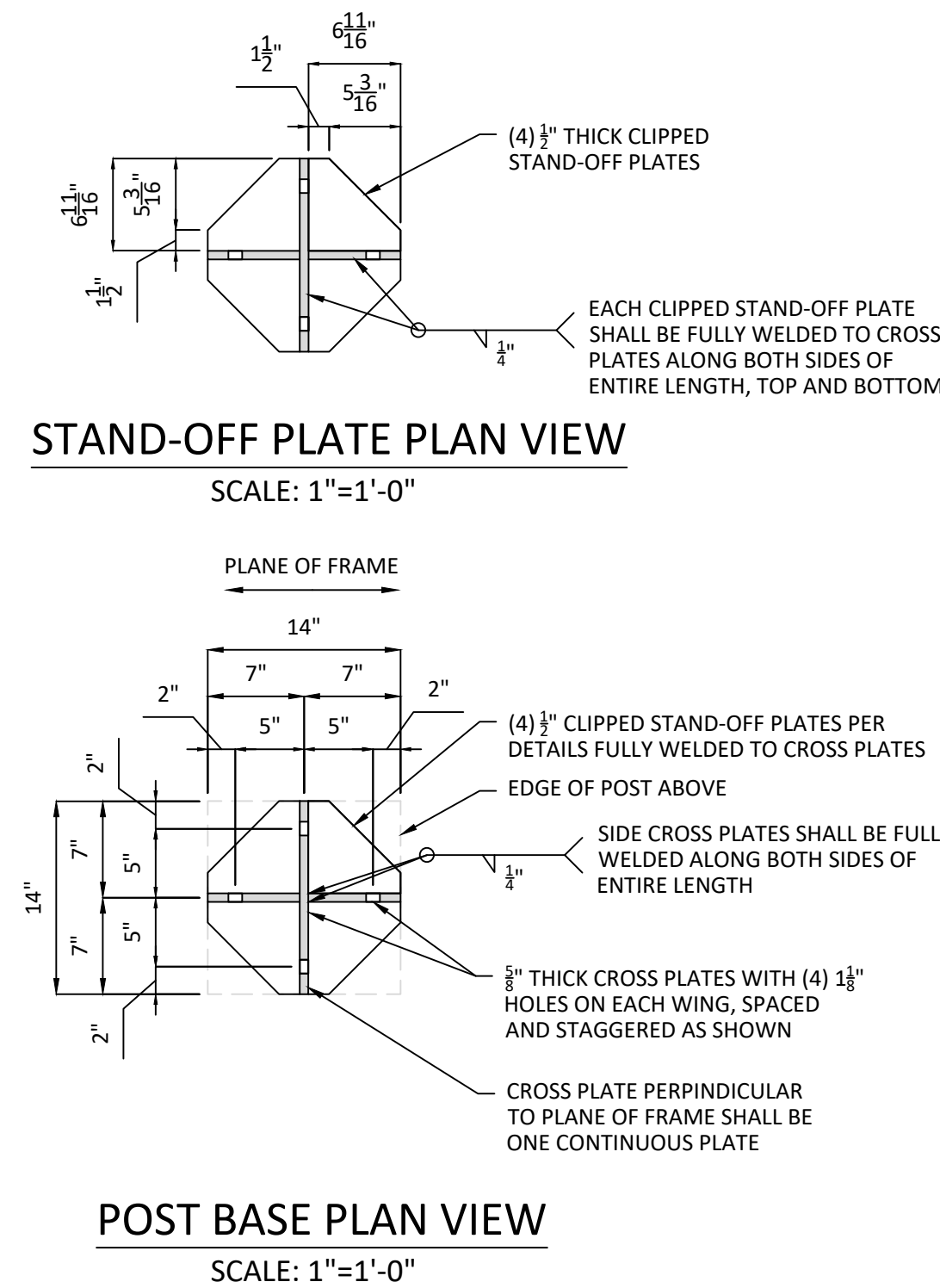
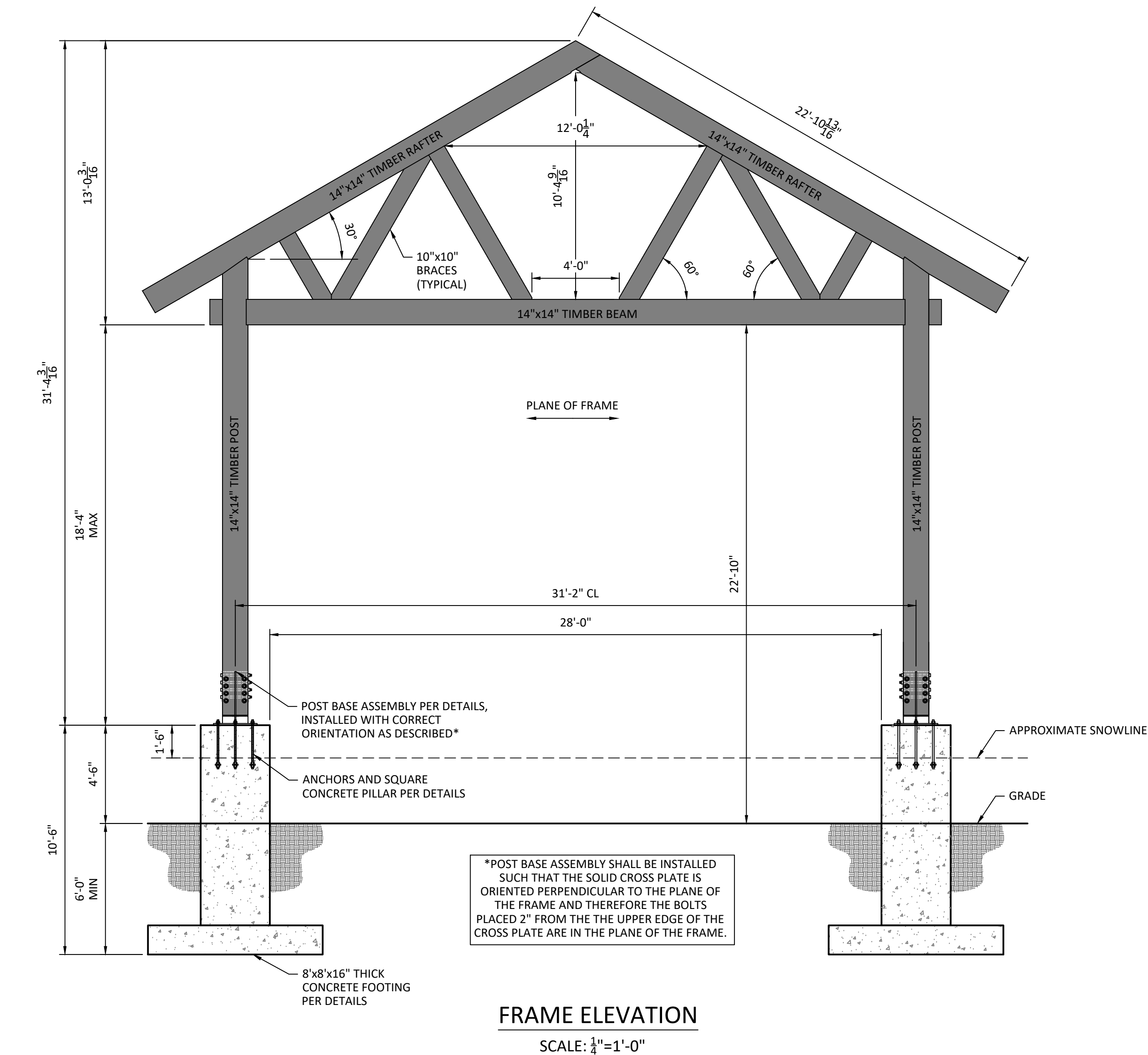
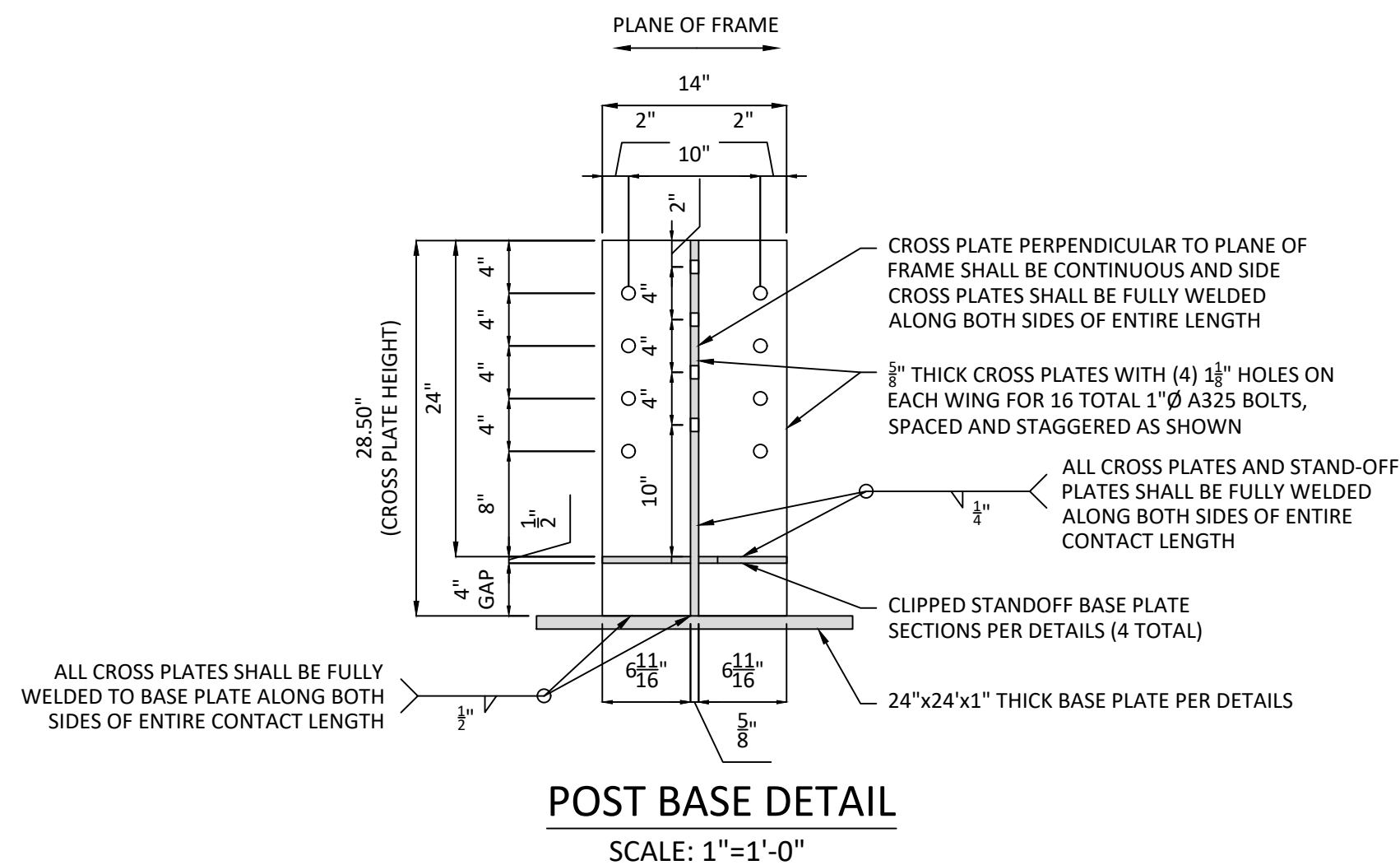

RCRBD
Reviewed
for
Code
Compliance
07/30/2025

TRADITIONAL ROOTS JOINERY, INC.

6633 CR 15 | Fort Collins, Colorado 80524 | Phone: 970-817-0821

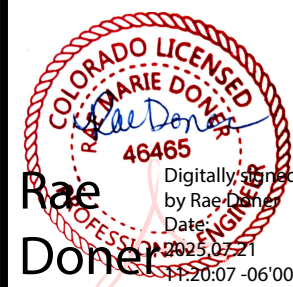

PREPARED FOR:

TEAMBOAT SKI & RESORT CORPORATION
3205 MT. WERNER CIRCLE

303 MI. WERNER CIRCLE
TEAMBOAT SPRINGS, CO 80487

PROJECT INFO:

GREENHORN RANCH ENTRANCE
STEAMBOAT SKI RESORT
STEAMBOAT, COLORADO

STRUCTURAL DETAILS

#	DATE	REVISION
---	------	----------

DESIGN BY: RM
DATE: 9/24/20

SCALE
PER PLAN

SHEET
S1
OF
S1

THESE DRAWINGS AND SPECIFICATIONS ARE THE EXCLUSIVE PROPERTY OF STRUCTURAL SUPPORT CONSULTING ENGINEERS, LLC AND SHALL NOT BE REPRODUCED OR COPIED WITHOUT WRITTEN AUTHORIZATION. THEIR USE AND PUBLICATION SHALL BE RESTRICTED