

SITE OVER VIEW

PARCEL ID: 154900004

OWNER: STEAMBOAT SKI & RESORT

LEGAL DESCRIPTION: LOT D SKI
HILL SUBDIVISION

A-1: SITE PLAN

A-2: ELEVATIONS

S-1: STURCTURAL,
CROSS SECTIONS
& NOTES

APPLICABLE CODES:

IBC 2015
IECC 2015
NEC 2017

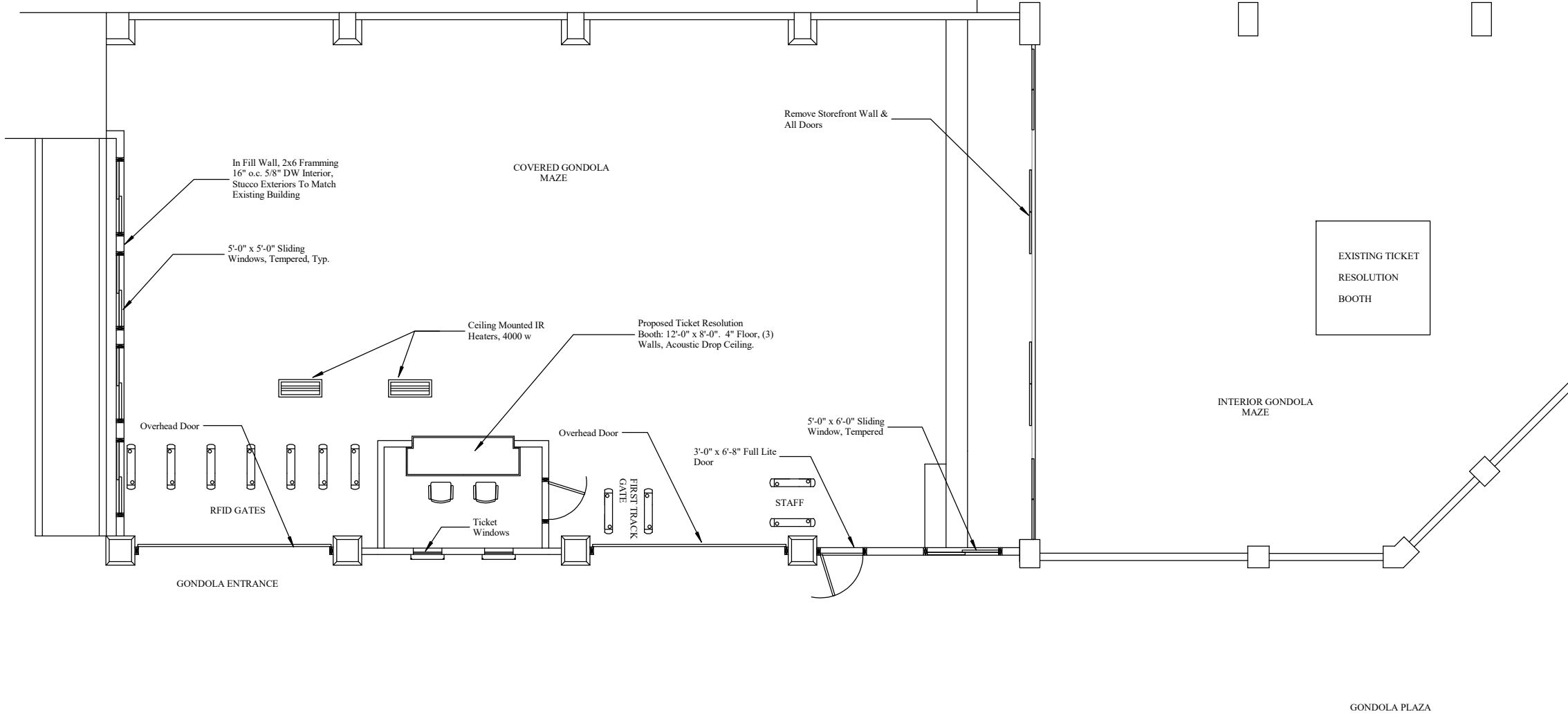

PURPOSE AND SCOPE:

TO RELOCATE RESOLUTION BOOTH & EXISTING STOREFRONT WALL W/ DOORS OUT OF THE INTERIOR MAZE AREA INTO THE COVERED MAZE TO FACILITATE INCREASED FLOW TO MEET CAPACITY DEMANDS OF THE NEW GONDOLA SKI LIFT. CLOSE IN THE COVERED MAZE TO MAINTAIN SECURITY. THE BOOTH & WALLS WOULD BE TEMPORARY IN NATURE, FOR REMOVAL DURING THE NEXT PHASE OF GONDOLA BUILDING REMODEL.

SHEET: 1 of 3

A-1

TITLE:
GONDOLA MAZE CLOSE IN SITE

SCALE:
1/4" = 1'

DESIGNED BY:
VTS

TEXT: 1.000
ARROW: 0.700
OTHER: 0.250

DATE:
FEB 2019

FILE:
resolution2A1.tcw

REVISED DATE:
APR 2019

OCCUPANCY CLASSIFICATION: GROUP B

CONSTRUCTION TYPE: V-A