

TINMAN ROOFING INC.

ESTABLISHED 1979

P.O. 77478

Steamboat Springs, Co. 80477

970-879-2123

Rebecca Duryea
Jim Moss

Proposal 11/5/16

Project: The Lodge A Building

Scope: Re-roof

Base Bid:

- Remove modified Bitumen
- Install 60 ml EPDM

L&M

\$164,000

Extras to base bid:

- Permit Costs: \$ 8,000 (not to exceed \$13,000)
- Install Polyiso Taper System \$ 28,000 (not to exceed \$32,000)
- Install dens-deck over Polyiso system \$ 14,000 (not to exceed \$18,000)
- Upgrade of shingles to Ultra HD Grand Sequoia \$ 22,000 (not to exceed \$27,000)

Total Extras:

\$ 72,000 (not to exceed \$90,000)

Total of new base bid with the above extras: \$236,000 (not to exceed \$254,000)

Possible additional costs:

1. Replace damaged 2x6 L&M \$92/2x6
 2. Install new ¾' Plywood L&M \$92/sheet
 3. Fully adhere all systems L&M \$16,000
 4. Replace damaged substrate plywood L&M \$82/sheet
 5. Weather setup/break down \$100 storm
 6. Snow and frost removal \$55/hr. per man
 7. Paint and replace any siding L&M \$14/board as needed
-

2016 project was Building B & completed in 2014

2017 Project is Building A

Job Dumpster

Job Dumpster

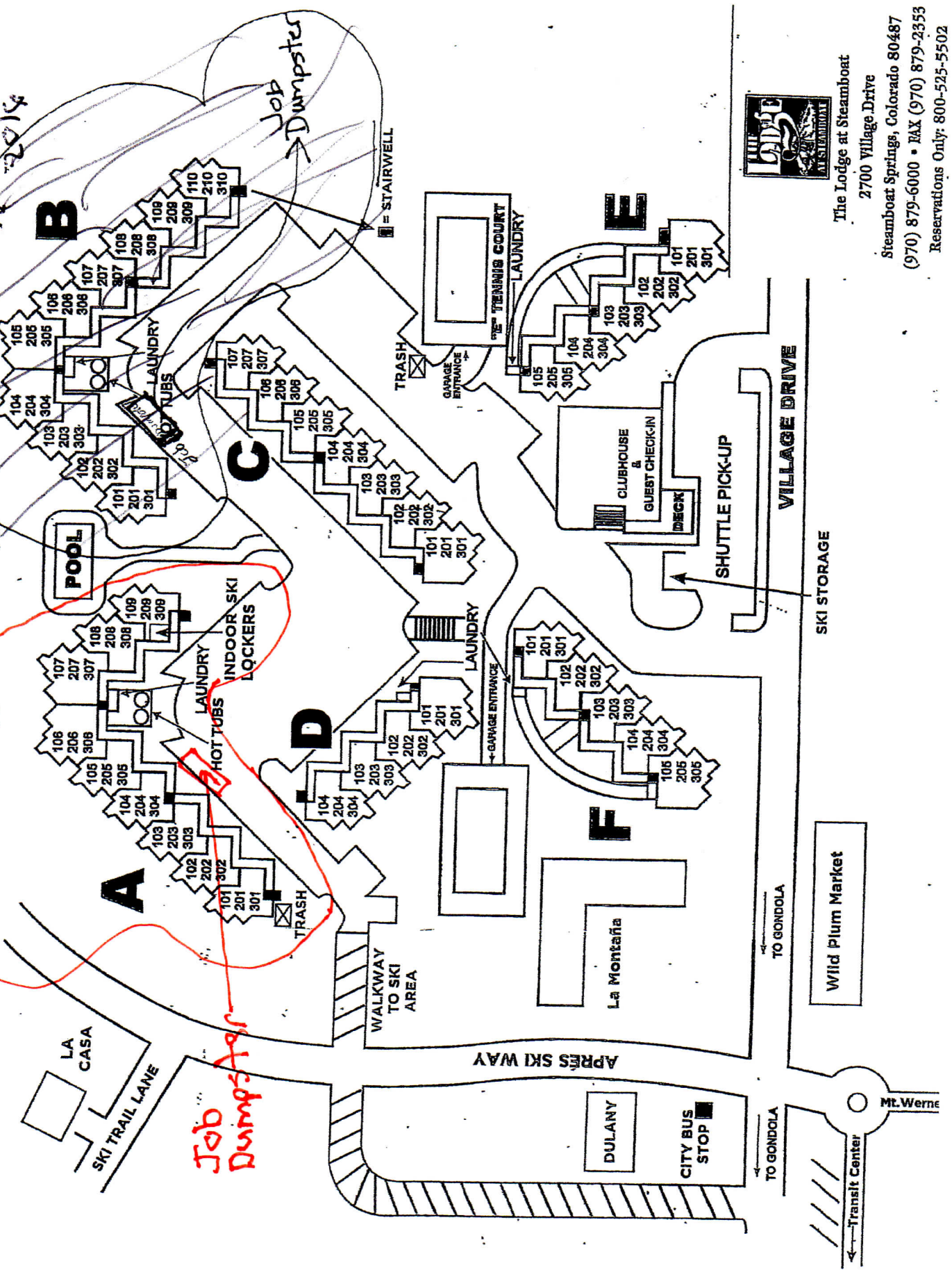

The Lodge at Steamboat
2700 Village Drive

Steamboat Springs, Colorado 80487
(970) 879-6000 • FAX (970) 879-2353
Reservations Only: 800-525-5502

Wild Plum Market

Transit Center

M. Werne

TO GONDOLA

TO GONDOLA

VILLAGE DRIVE

APRES SKI WAY

DULANY

CITY BUS STOP