

1
A552

BEAR CLAW SIGN ELEVATION

1 1/2" = 1'-0"

DATE: 2021-08-03 - SIGN PERMIT (2023-08-24 UPDATED)

NOTICE: DUTY OF COOPERATION

Release of these plans contemplates further cooperation among the owner, his contractor and the architect. Design and construction are complex. Although the architect and his consultants have performed their services with due care and diligence, they cannot guarantee perfection. Communication is imperfect and every contingency cannot be anticipated. Any ambiguity or discrepancy discovered by the use of these plans shall be reported immediately to the architect. Failure to notify the architect compounds misunderstanding and increases responsibility to the architect shall relieve the architect from responsibility for the consequences. Changes made from the plans without consent of the architect are unauthorized and shall relieve the architect of responsibility for all consequences arising out of such changes.

All design, documents and data prepared by Eric Smith Associates, P.C., as instruments of service shall remain property of Eric Smith Associates, P.C., and shall not be copied, changed or disclosed in any form whatsoever without first obtaining the express written consent of Eric Smith Associates, P.C.

Eric Smith Associates, P.C.

BEAR CLAW II
EXTERIOR REMODEL
2420 SKI TRAIL LANE
STEAMBOAT SPRINGS, COLORADO

ES
ERIC SMITH ASSOCIATES, P.C.
1915 SEVENTH STREET
BOULDER, COLORADO, 80502
(303) 442-9486, (303) 442-4748 FAX

Job Number:	17022
Date:	11.2.2020
Drawn By:	Author
Checked By:	Checker
Project Phase	
PERMIT - PORTE-COCHERE SIGN	
Sheet Title	
DETAILS, SIGN PERMIT	
Sheet Number	
A552	

TYPE OF CONSTRUCTION:

TYPE IB (EXISTING SPRINKLERED & NON-SPRINKLERED BUILDING)
TYPE IB (NEW EXTERIOR SIGN CONSTRUCTION)

SIGNS TO BE CONSTRUCTED OF NON-COMBUSTIBLE MATERIALS

- 3/16" METAL BACK & FACE PLATE
- 1-5/8" METAL UNISTRUTS
- HSS TUBE STEEL
- STEEL PLATES
- METAL ATTACHMENTS

APPLICABLE CODES:

2018 I.C.C. MODEL CODE SYSTEM
CITY OF STEAMBOAT SPRINGS BUILDING CODE
AMENDMENTS

ZONING DISTRICT:

RR-2, RESORT RESIDENTIAL TWO MEDIUM DENSITY

STRUCTURAL STEEL:

STRUCTURAL STEEL SHALL BE DETAILED, FABRICATED AND ERECTED IN ACCORDANCE WITH THE "SPECIFICATION FOR STRUCTURAL STEEL BUILDINGS" (AISC 360) AND THE "CODE OF STANDARD PRACTICE FOR STEEL BUILDINGS AND BRIDGES" (AISC 303) BY THE AMERICAN INSTITUTE OF STEEL CONSTRUCTION (AISC).

ALL STRUCTURAL STEEL SHALL CONFORM TO THE ASTM STANDARDS AND GRADES INDICATED BELOW, UNLESS NOTED OTHERWISE ON THE DRAWINGS OR DETAILS.

STRUCTURAL STEEL WIDE FLANGE BEAMS AND WTS:
ROLLED STEEL FLOOR PLATES:
OTHER ROLLED SHAPES, INCLUDING PLATES, CHANNELS, AND ANGLES:
HOLLOW STRUCTURAL SECTION (HSS) RECTANGULAR SHAPES:
HSS ROUND SHAPES:

ASTM A992, 50 KSI YIELD
ASTM A786, COMMERCIAL GRADE
ASTM A36, 36 KSI YIELD
ASTM A500, GRADE B, 46 KSI YIELD
ASTM A500, GRADE B, 42 KSI YIELD

WELDING SHALL BE DONE BY A CERTIFIED WELDER IN ACCORDANCE WITH THE AISC DOCUMENTS LISTED ABOVE, AND THE AMERICAN WELDING SOCIETY (AWS) D1.1: STRUCTURAL WELDING CODE, AND THE RECOMMENDATIONS FOR USE OF E70XX ELECTRODES. WHERE NOT SPECIFICALLY NOTED, MINIMUM WELD SHALL BE 3/16" FILLET BY LENGTH OF CONTACT EDGE.

WIND LOADS (ASCE 7-16)
BASIC WIND SPEED (3-SECOND GUST): 115 MPH ULTIMATE
BUILDING ENCLOSURE CLASSIFICATION: ENCLOSED BUILDING, OPEN PORTE-COCHERE
INTERNAL PRESSURE COEFFICIENT (GCpi): 0.18 ENCLOSED 0.0 OPEN
WIND EXPOSURE: C

COMPONENTS AND CLADDING DESIGN WIND PRESSURE (PSF)(ASCE 7-16)

WIND ZONE (BASED ON 20 SF)
5 WITHIN 6'-4" OF CORNERS: +22.0 PSF, -44.0 PSF
4 INTERNALLY: +22.0 PSF, -22.0 PSF
ROOF ZONE
3 WITHIN 6'-4" OF CORNERS: +16.0 PSF, -69.1 PSF
3' OVERHANGS WITHIN 6'-4" OF CORNERS AND RIDGES: +16.0 PSF, -69.1 PSF
2 WITHIN 6'-4" OF EDGES AND RIDGES: +16.0 PSF, -52.3 PSF
2' OVERHANGS: +16.0 PSF, -51.0 PSF
1 INTERNALLY: +16.0 PSF, -38.5 PSF

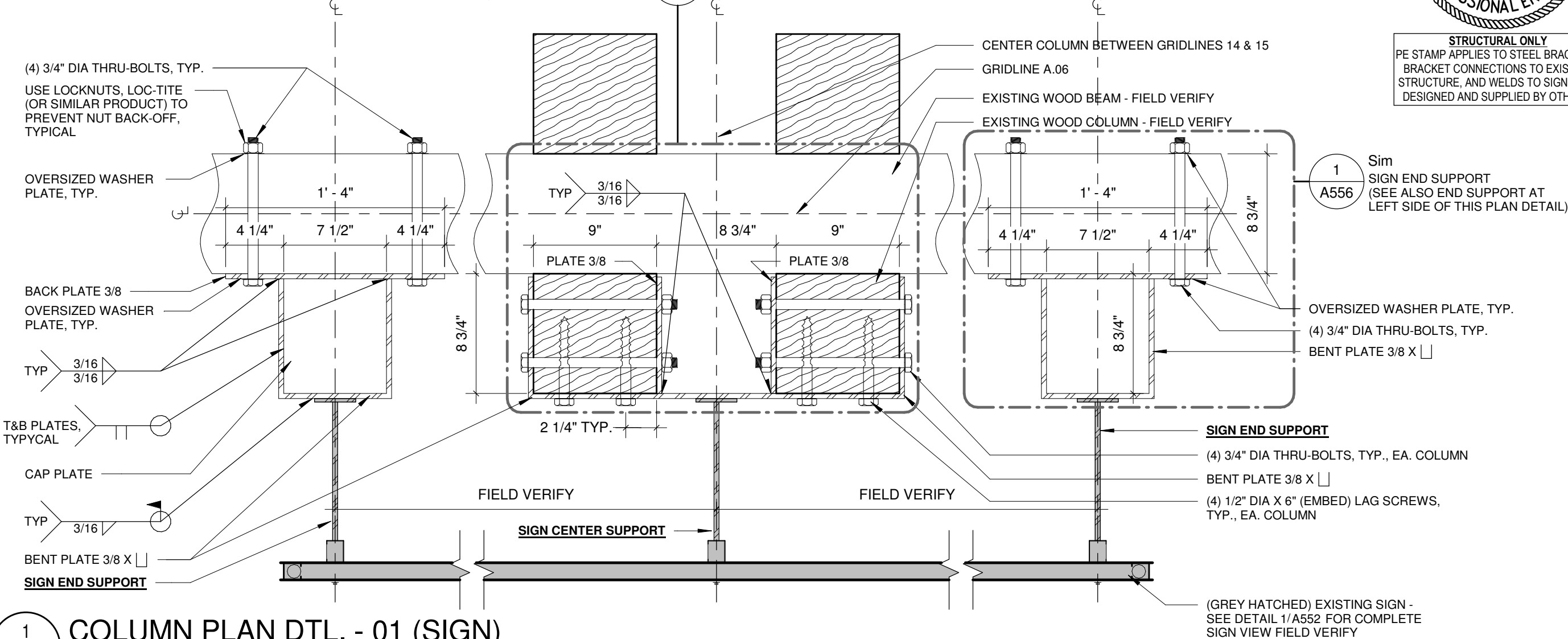

STRUCTURAL ONLY
PE STAMP APPLIES TO STEEL BRACKETS, BRACKET CONNECTIONS TO EXISTING STRUCTURE, AND WELDS TO SIGN. SIGN DESIGNED AND SUPPLIED BY OTHERS.

NOTICE: DUTY OF COOPERATION
Release of these plans contemplates further cooperation among the owner, his contractor and the architect. Design and construction are complex. Although the architect and his consultants have performed their services with due care and diligence, they cannot guarantee perfection. Communication is imperfect and every contingency cannot be anticipated. Any ambiguity or discrepancy discovered by the use of these plans shall be reported immediately to the architect. Failure to notify the architect compounds misunderstanding and increases responsibility to the architect. A failure to cooperate by a simple notice to the architect shall relieve the architect from responsibility for the consequences. Changes made from the plans without consent of the architect are unauthorized and shall relieve the architect of responsibility for all consequences arising out of such changes.
All design, documents and data prepared by Eric Smith Associates, P.C., as instruments of service shall remain property of Eric Smith Associates, P.C., and shall not be copied, changed or disclosed in any form whatsoever without first obtaining the express written consent of Eric Smith Associates, P.C.
Eric Smith Associates, P.C.

BEAR CLAW II
EXTERIOR REMODEL
2420 SKI TRAIL LANE
STEAMBOAT SPRINGS, COLORADO



Job Number: 17022
Date: 11.2.2020
Drawn By: Author
Checked By: Checker

Project Phase
PERMIT - PORTE-COCHERE SIGN
Sheet Title
DETAILS, SIGN PERMIT

Sheet Number
A555

DATE: 2021-08-03 - SIGN PERMIT (2023-08-24 UPDATED)

1
A555
COLUMN PLAN DTL. - 01 (SIGN)
1 1/2" = 1'-0"

1
A556

COLUMN SECTION DTL. - 01 (SIGN)

1 1/2" = 1'-0"

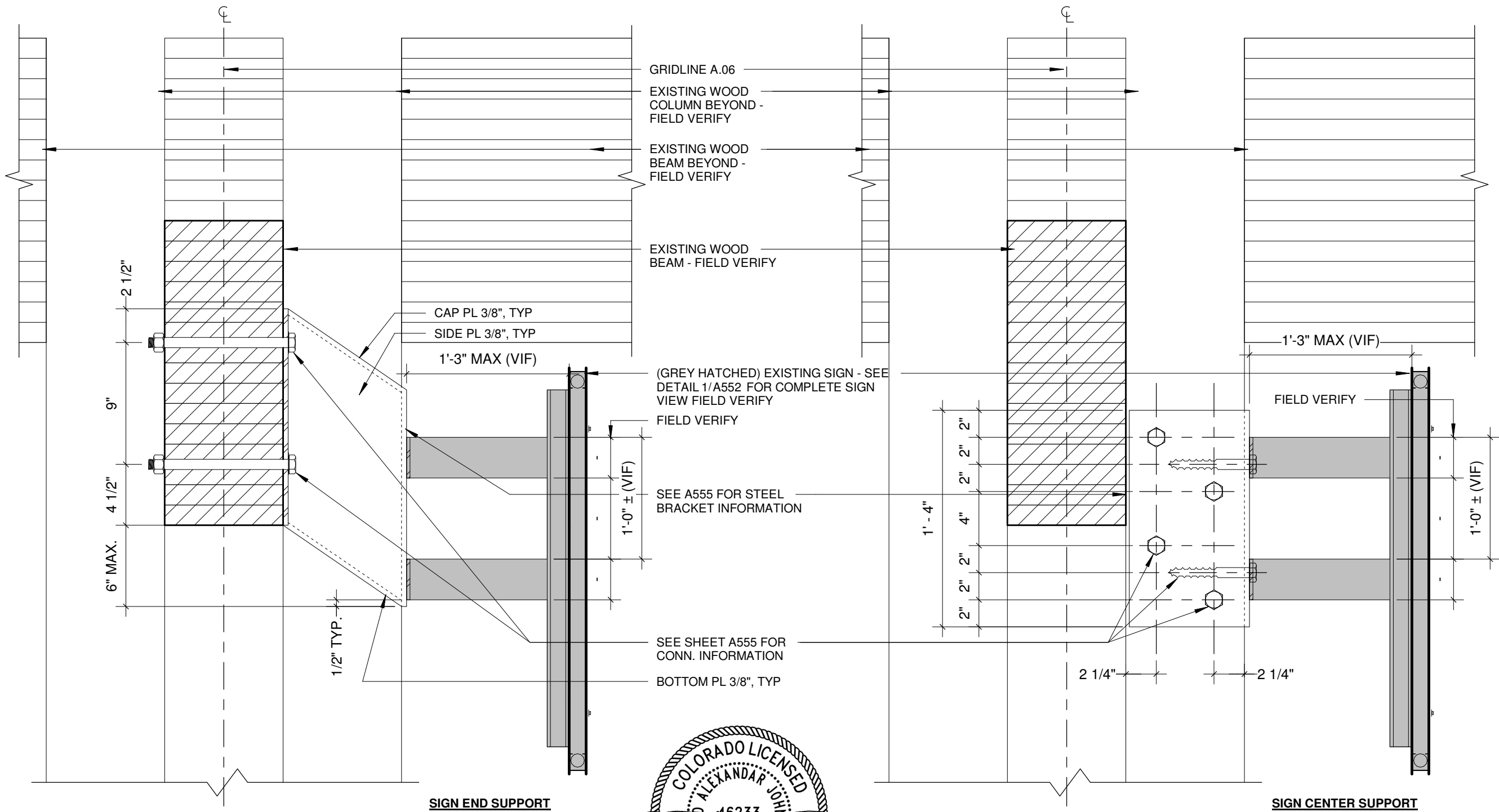

SIGN END SUPPORT

SIGN CENTER SUPPORT



STRUCTURAL ONLY
PE STAMP APPLIES TO STEEL BRACKETS, BRACKET CONNECTIONS TO EXISTING STRUCTURE, AND WELDS TO SIGN. SIGN DESIGNED AND SUPPLIED BY OTHERS.

NOTICE: DUTY OF COOPERATION
Release of these plans contemplates further cooperation among the owner, his contractor and the architect. Design and construction are complex. Although the architect and his consultants have performed their services with due care and diligence, they cannot guarantee perfection. Communication is imperfect and every contingency cannot be anticipated. Any ambiguity or discrepancy discovered by the use of these plans shall be reported immediately to the architect. Failure to notify the architect compounds misunderstanding and increases construction costs. A failure to cooperate by a simple notice to the architect shall relieve the architect from responsibility for the consequences. Changes made from the plans without consent of the architect are unauthorized and shall relieve the architect of responsibility for all consequences arising out of such changes.
All design, documents and data prepared by Eric Smith Associates, P.C., as instruments of service shall remain property of Eric Smith Associates, P.C., and shall not be copied, changed or disclosed in any form whatsoever without first obtaining the express written consent of Eric Smith Associates, P.C.
Eric Smith Associates, P.C.

BEAR CLAW II
EXTERIOR REMODEL
2420 SKI TRAIL LANE
STEAMBOAT SPRINGS, COLORADO



Job Number: 17022
Date: 11.2.2020
Drawn By: Author
Checked By: Checker

Project Phase
PERMIT - PORTE-COCHERE SIGN

Sheet Title
DETAILS, SIGN PERMIT

Sheet Number
A556

DATE: 2021-08-03 - SIGN PERMIT (2023-08-24 UPDATED)