

STANDARD NOTES FOR CONSTRUCTION SITE MANAGEMENT PLANS:

1. THIS PLAN SHALL BE KEPT ON SITE AT ALL TIMES AND UPDATED TO REFLECT ANY CHANGES.
2. CLEARING OR GRADING SHALL NOT BEGIN UNTIL ALL SEDIMENT CONTROL DEVICES HAVE BEEN INSTALLED.
3. ROADSIDE DITCHES AND SLOPES 3:1 OR GREATER SHALL BE STABILIZED WITH TRM OR EROSION CONTROL BLANKETS.
4. CONTRACTOR IS RESPONSIBLE FOR INSTALLING AND MAINTAINING TEMPORARY EROSION AND SEDIMENT CONTROL DURING CONSTRUCTION AND ESTABLISHING ANY REQUIRED PERMANENT CONTROL MEASURES TO PREVENT RELEASE OF POLLUTANTS FROM THE PROJECT SITE.
5. CONTROL MEASURES SHALL BE USED, MODIFIED, AND MAINTAINED WHENEVER NECESSARY TO REFLECT CURRENT CONDITIONS. CONTROL MEASURES SHALL BE INSPECTED WEEKLY AND AFTER EVERY PRECIPITATION EVENT. ACCUMULATED SEDIMENT SHALL BE REMOVED FROM CONTROL MEASURES WHEN THE SEDIMENT LEVEL REACHES  $\frac{1}{2}$  HEIGHT OF THE CONTROL MEASURE.
6. THE CONTRACTOR SHALL PROMPTLY REMOVE ALL SEDIMENT, MUD, AND CONSTRUCTION DEBRIS THAT MAY ACCUMULATE IN THE RIGHT OF WAY, PRIVATE PROPERTY, OR WATERWAYS AS A RESULT OF THE CONSTRUCTION ACTIVITIES.
7. ALL INGRESS AND EGRESS POINTS ON TO THE DISTURBED SITE MUST BE STABILIZED WITH A VEHICLE TRACKING CONTROL PAD. ACCESS SHALL ONLY BE VIA APPROVED LOCATIONS AS SHOWN ON APPROVED CSMP.
8. TEMPORARY SOIL STABILIZATION MEASURES SHALL BE IMPLEMENTED WHERE GROUND DISTURBANCES HAVE TEMPORARILY OR PERMANENTLY CEASED FOR 14 DAYS OR FOR AREAS OF LAND DISTURBANCE WITHIN ONE GROWING SEASON.
9. CONCRETE WASTE AND WASHOUT WATER FROM MIXING TRUCKS SHALL BE CONTAINED ON SITE, REMOVED FROM THE SITE, AND PROPERLY DISPOSED. MATERIALS SHOULD NOT ENTER STATE WATERS.
10. CONTRACTOR IS RESPONSIBLE FOR COMPLYING WITH ALL LOCAL, STATE, AND FEDERAL LAWS. IN ADDITION CONTRACTOR MUST OBTAIN REQUIRED PERMITS.
11. EMERGENCY ACCESS MUST BE KEPT OBSTACLE FREE AND PASSABLE AT ALL TIMES.
12. FOR ANY WORK TO BE DONE IN THE RIGHT OF WAY, COORDINATE WITH THE CITY ROW MANAGER REGARDING SPECIAL PERMITTING. NO WORK SHALL BE CONDUCTED IN THE ROW BETWEEN NOVEMBER 1 AND MAY 1 WITHOUT PRIOR APPROVAL FROM THE DIRECTOR OF PUBLIC WORKS.
13. WHERE REQUIRED AS PART OF THE ROW PERMIT OR WHERE SITE WORK AFFECTS THE PEDESTRIAN OR VEHICLE TRAVEL WAY, TRAFFIC CONTROL SHALL BE INSTALLED. ALL TRAFFIC CONTROL SHALL BE IN ACCORDANCE WITH THE MANUAL ON UNIFORM TRAFFIC CONTROL DEVICES, LATEST EDITION.
14. SIDEWALKS ADJACENT TO CONSTRUCTION SITES SHALL BE MAINTAINED, FOR PUBLIC USE, BY THE CONTRACTOR, IN AREAS WHERE CONSTRUCTION IS TAKING PLACE NEXT TO THE SIDEWALK AND OVERHEAD HAZARDS ARE POSSIBLE, SITE IS RESPONSIBLE FOR INSTALLING AND MAINTAINING SIDEWALK PROTECTION.

ABBREVIATIONS:

AC	ACRES
BLDG	BUILDING
CL	CENTERLINE
CMU	CONCRETE MASONRY UNITS
CO	CLEAN OUT
CONC	CONCRETE
ELEV	ELEVATION
EOC	EDGE OF CONCRETE
EOG	EDGE OF GRAVEL
EX	EXISTING
FFE	FINISHED FLOOR ELEVATION
FND	FOUNDATION
HP	HIGH POINT
INV	INVERT
LF	LINEAR FEET
PR	PROPOSED
SCH	SCHEDULE
SF	SQUARE FEET

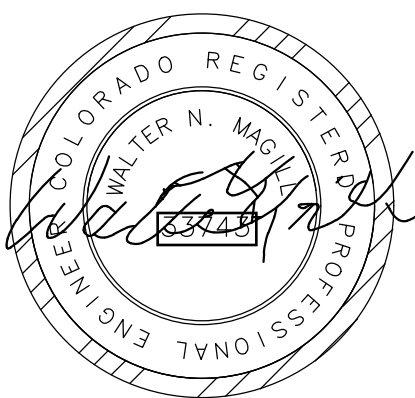
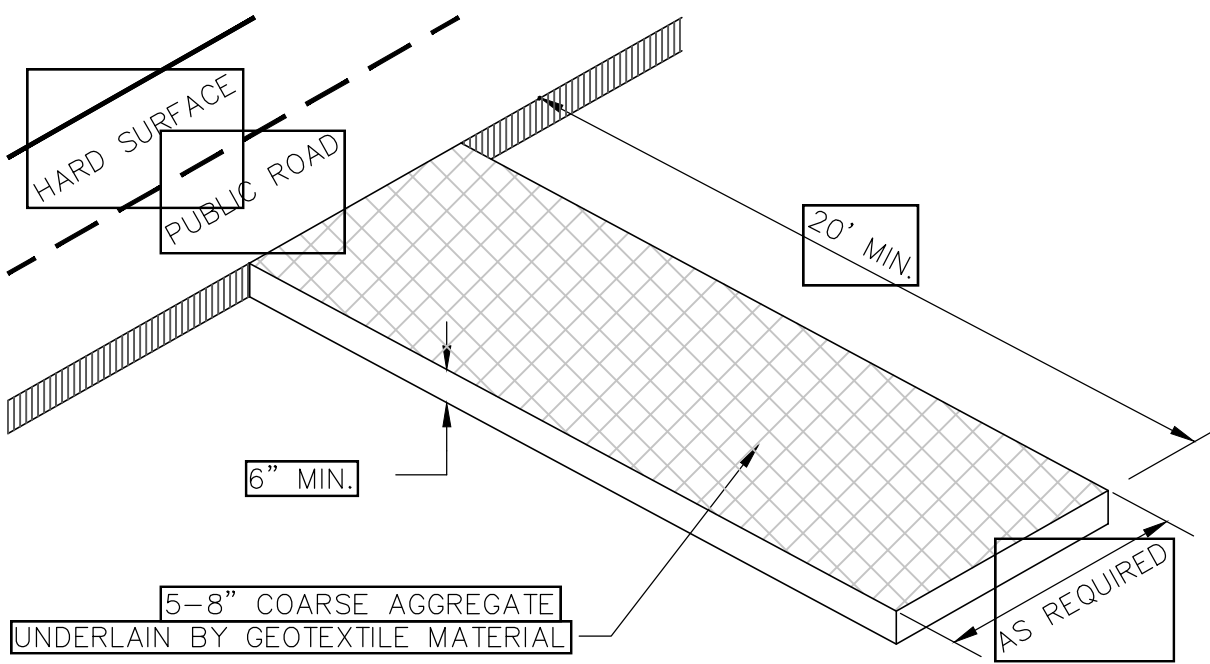
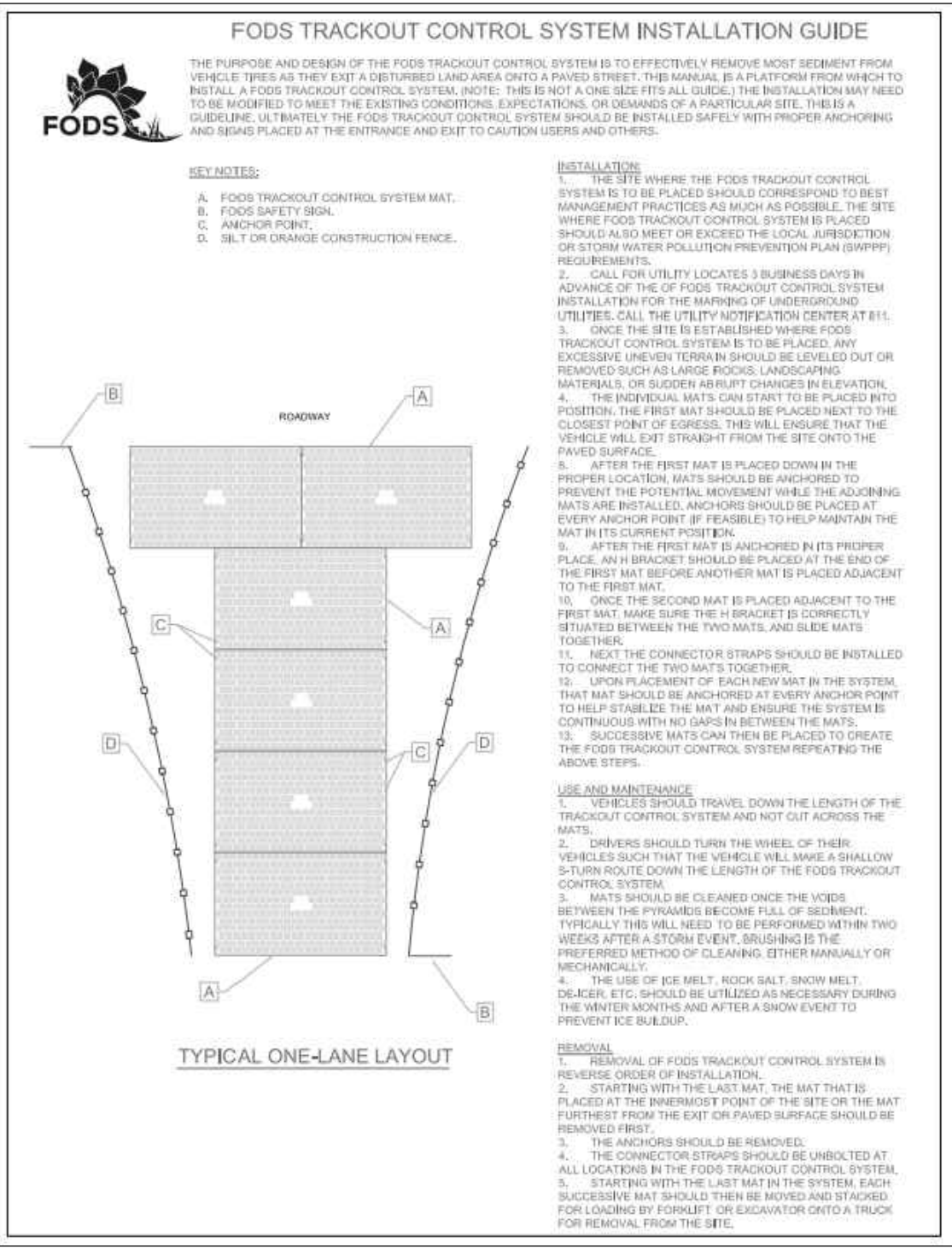

VEHICLE TRACKING CONTROL PAD, FODS OR APPROVED SIMILAR

N.T.S.

PURPOSE

TO REDUCE THE AMOUNT OF MUD TRANSPORTED ONTO PUBLIC ROADS BY MOTOR VEHICLES OR RUNOFF, ROADWAY ADJACENT TO PROJECT AREA SHALL BE MAINTAINED FREE OF MUD AND DIRT AND SWEEPED DAILY AS NEEDED.

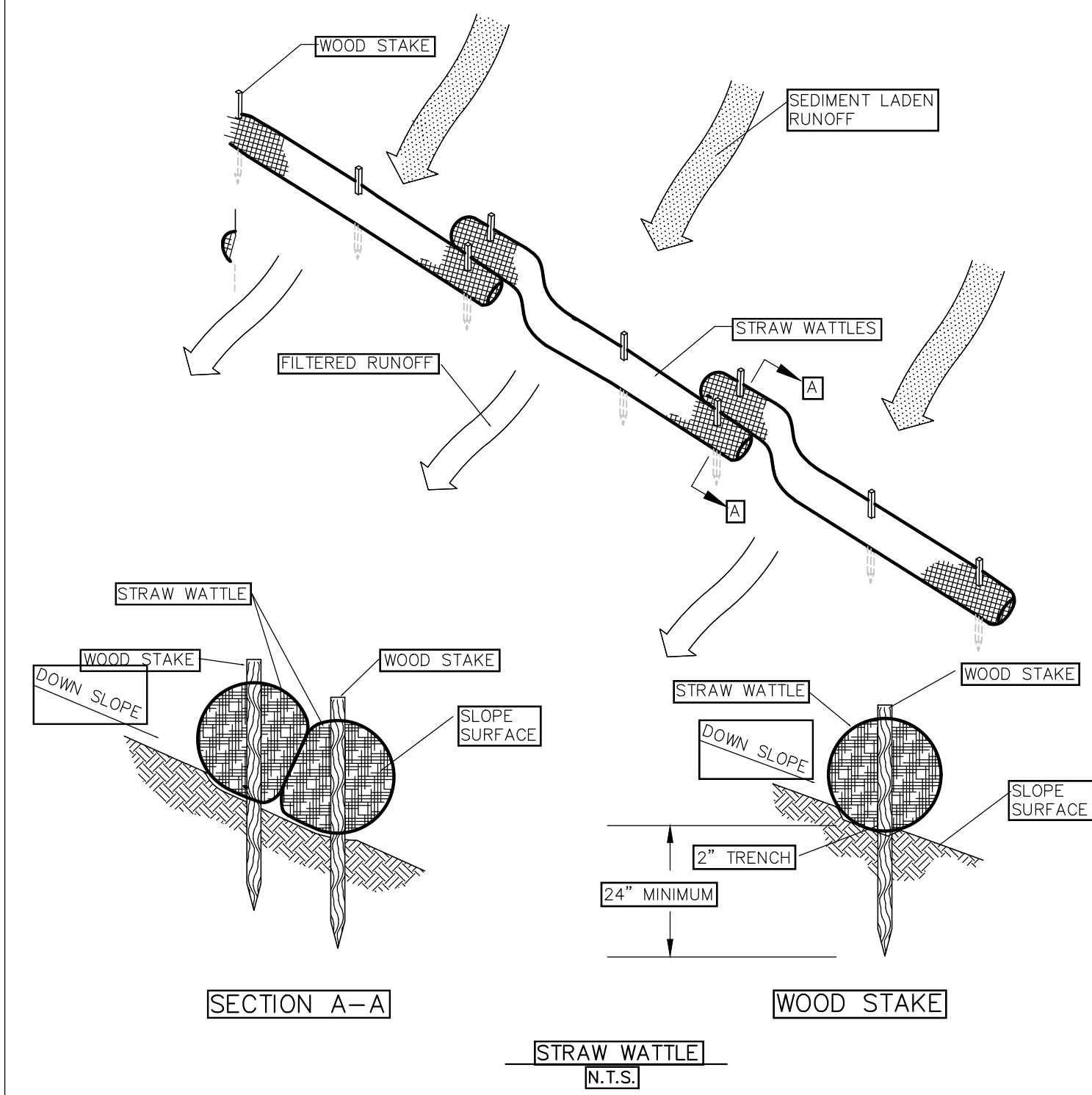

CONCRETE WASHOUT NOTES:

1. ACTUAL LAYOUT TO BE DETERMINED IN THE FIELD.
2. A CONCRETE WASHOUT SIGN SHALL BE INSTALLED WITHIN 30' OF THE TEMPORARY CONCRETE WASHOUT FACILITY.
3. MATERIAL USED TO CONSTRUCT TEMPORARY CONCRETE WASHOUT FACILITIES SHALL BE REMOVED FROM THE SITE AND DISPOSED OF OR RECYCLED.
4. HOLES, DEPRESSIONS OR OTHER GROUND DISTURBANCE CAUSED BY THE REMOVAL OF THE TEMPORARY CONCRETE WASHOUT FACILITIES SHALL BE BACKFILLED, REPAIRED AND STABILIZED TO PREVENT EROSION.
5. CONCRETE WASHOUT MUST BE LOCATED >50 FT AWAY FROM INLETS/WATERWAYS UNLESS THERE IS NO OTHER PRACTICAL ALTERNATIVE.

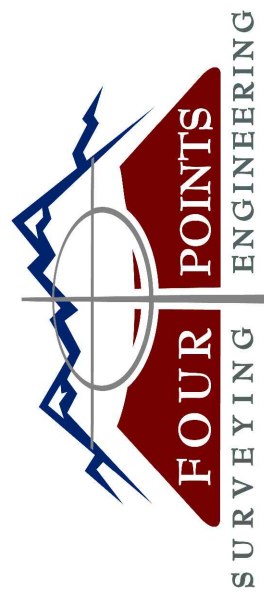

440 S. Lincoln Ave, Suite 4A  
P.O. Box 775966  
Steamboat Springs, CO 80487  
(970)-871-6772  
www.fourpointse.com

Reviewed for  
Code Compliance  
06/07/2022

VILLAGE DR TOWNHOMES  
1805 WALTON CREEK RD  
STEAMBOAT SPRINGS, CO 80487

Horizontal Scale  
0 20' 40'  
SCALE: 1" = 20'  
Contour Interval = 2 ft  
DATE: 5-24-2022  
JOB #: 1849-012  
DRAWN BY: CFB  
DESIGN BY: CFB  
REVIEW BY: FPSE

IF THIS DRAWING IS PRESENTED IN A  
FORMAT OTHER THAN A4 X 36", THE  
GRAPHIC SCALE SHOULD BE UTILIZED.

CONSTRUCTION  
SITE MANAGEMENT  
PLAN

DRAWING:

SHEET #

C1