

CONSTRUCTION SITE MANAGEMENT PLAN NOTES

1. THIS PLAN SHALL BE KEPT ON SITE AT ALL TIMES AND UPDATED TO REFLECT ANY CHANGES.
2. CLEARING OR GRADING SHALL NOT BEGIN UNTIL ALL TEMPORARY EROSION PREVENTION & SEDIMENT CONTROL MEASURES HAVE BEEN INSTALLED.
3. CONTRACTOR IS RESPONSIBLE FOR INSTALLING AND MAINTAINING TEMPORARY EROSION AND SEDIMENT CONTROL MEASURES DURING CONSTRUCTION AND ESTABLISHING ANY REQUIRED PERMANENT CONTROL MEASURES TO PREVENT RELEASE OF POLLUTANTS FROM THE PROJECT SITE.
4. CONTROL MEASURES SHALL BE USED, MODIFIED, AND MAINTAINED WHENEVER NECESSARY TO REFLECT CURRENT CONDITIONS. CONTROL MEASURES SHALL BE INSPECTED WEEKLY AND AFTER EVERY PRECIPITATION EVENT. ACCUMULATED SEDIMENT SHALL BE REMOVED FROM CONTROL MEASURES WHEN THE SEDIMENT LEVEL REACHES 1/2 THE HEIGHT OF THE CONTROL MEASURE.
5. DISTURBED SOILS ON SLOPES GREATER OR EQUAL TO 3:1 (HORIZONTAL TO VERTICAL) MUST BE STABILIZED WITH EROSION CONTROL BLANKET OR TURF REINFORCEMENT MATTING.
6. THE CONTRACTOR SHALL PROMPTLY REMOVE ALL SEDIMENT, MUD, AND CONSTRUCTION DEBRIS THAT MAY ACCUMULATE IN THE RIGHT OF WAY, PRIVATE PROPERTY, OR WATER WAYS AS A RESULT OF THE CONSTRUCTION ACTIVITIES, WITH NO ADDITIONAL COSTS TO THE OWNER OR OWNER'S REPRESENTATIVE.
7. ALL INGRESS AND EGRESS ACCESS POINTS ON TO THE DISTURBED SITE MUST BE STABILIZED WITH A VEHICLE TRACKING CONTROL PAD. ACCESS SHALL ONLY BE VIA APPROVED LOCATIONS AS SHOWN ON APPROVED CSMP. FODS VEHICLE TRACKING PADS MAY BE USED AS A SUITABLE ALTERNATIVE TO THE GRAVEL VEHICLE TRACKING CONTROL PAD SHOWN IN PLAN VIEW.
8. TEMPORARY SOIL STABILIZATION MEASURES SHALL BE IMPLEMENTED WHERE GROUND DISTURBANCES HAVE TEMPORARILY OR PERMANENTLY CEASED FOR 14 DAYS OR FOR AREAS OF LAND DISTURBANCE WITHIN ONE GROWING SEASON.
9. CONCRETE WASTE AND WASHOUT WATER FROM MIXING TRUCKS SHALL BE CONTAINED ON SITE, REMOVED FROM THE SITE, AND PROPERLY DISPOSED. MATERIALS SHALL NOT BE ALLOWED TO ENTER LOCAL OR STATE WATERS.
10. CONTRACTOR IS RESPONSIBLE FOR COMPLYING WITH ALL LOCAL, STATE, AND FEDERAL LAWS. IN ADDITION CONTRACTOR MUST OBTAIN REQUIRED PERMITS.
11. EMERGENCY ACCESS MUST BE KEPT OBSTACLE FREE AND PASSABLE AT ALL TIMES. REMOVE EXCESS VEGETATION THAT MAY PROHIBIT EASE OF ACCESS TO THE SITE.
12. CONTRACTOR SHALL PROVIDE ADEQUATE WASTE MANAGEMENT INCLUDING BUT NOT LIMITED TO A REGULARLY MAINTAINED ON SITE DUMPSTER AND PORTA-POTTY.
13. CONTRACTOR SHALL BE RESPONSIBLE FOR INSTALLING REQUIRED TRAFFIC CONTROL SIGNAGE ON 12TH STREET AND OAK STREET IN CONFORMANCE WITH THE CITY OF STEAMBOAT SPRINGS, ROAD AND BRIDGE STANDARDS, LATEST ADDITION AND/OR THE MANUAL ON UNIFORM TRAFFIC CONTROL DEVICES (MUTCD) (WHICHEVER GOVERNS).
14. FINAL STABILIZATION IS THE CONDITION REACHED WHEN ALL GROUND SURFACE DISTURBING ACTIVITIES AT THE SITE HAVE BEEN COMPLETED, AND FOR ALL AREAS OF GROUND SURFACE DISTURBING ACTIVITIES A UNIFORM VEGETATIVE COVER HAS BEEN ESTABLISHED WITH AN INDIVIDUAL PLANT DENSITY OF AT LEAST 70 PERCENT OF PRE-DISTURBANCE LEVELS, OR EQUIVALENT PERMANENT, PHYSICAL EROSION REDUCTION METHODS HAVE BEEN EMPLOYED.
15. CONTRACTOR TO VERIFY ADDITIONAL UTILITY CONNECTIONS TO THE EXISTING STRUCTURE PRIOR TO COMMENCING EARTHWORK ACTIVITIES AND DEMOLITION. THE PROJECT ENGINEER SHALL BE NOTIFIED IMMEDIATELY OF ANY ADDITIONAL UTILITY CONNECTIONS THAT ARE NOT DISPLAYED ON THIS PLAN.

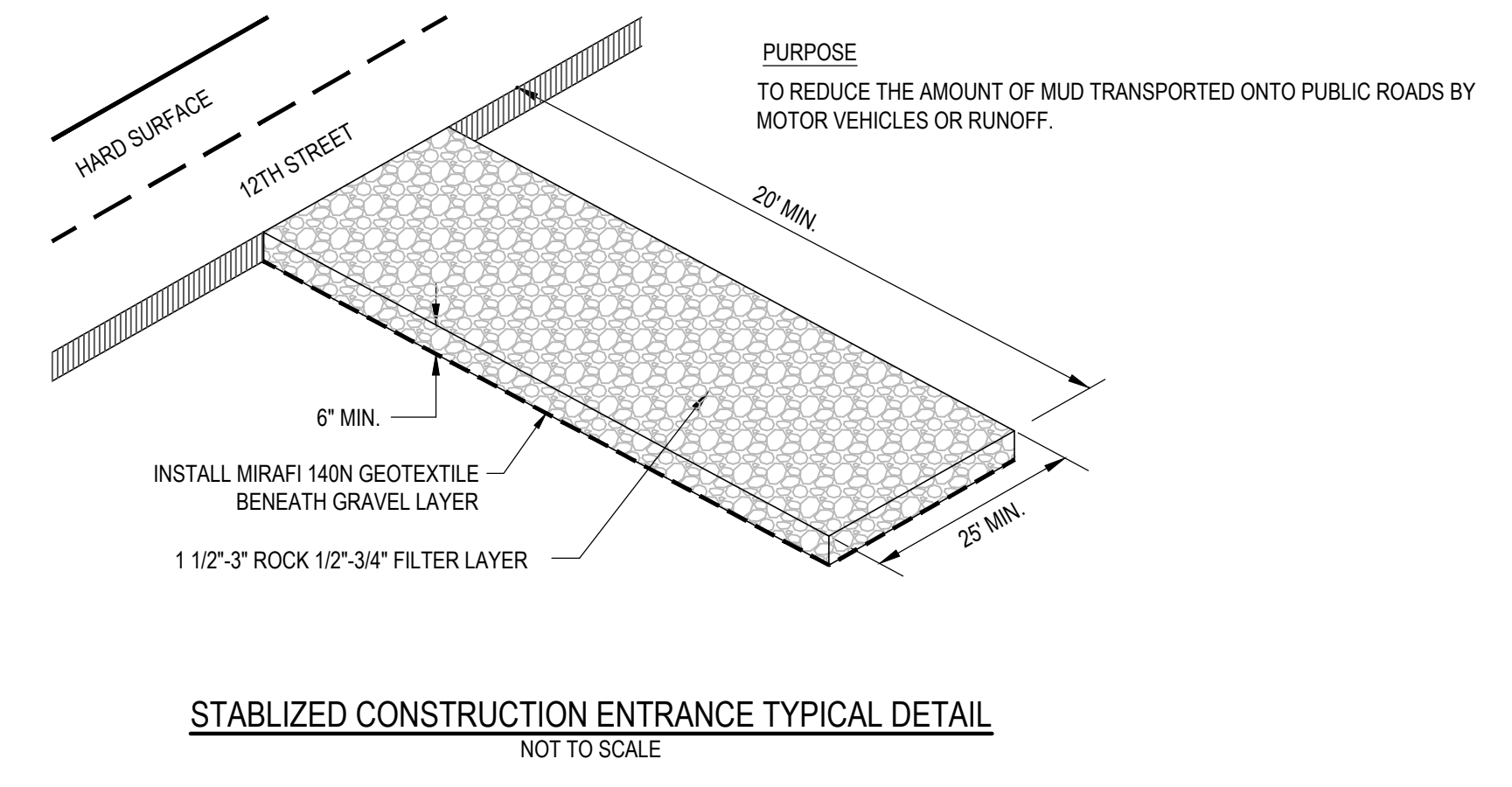
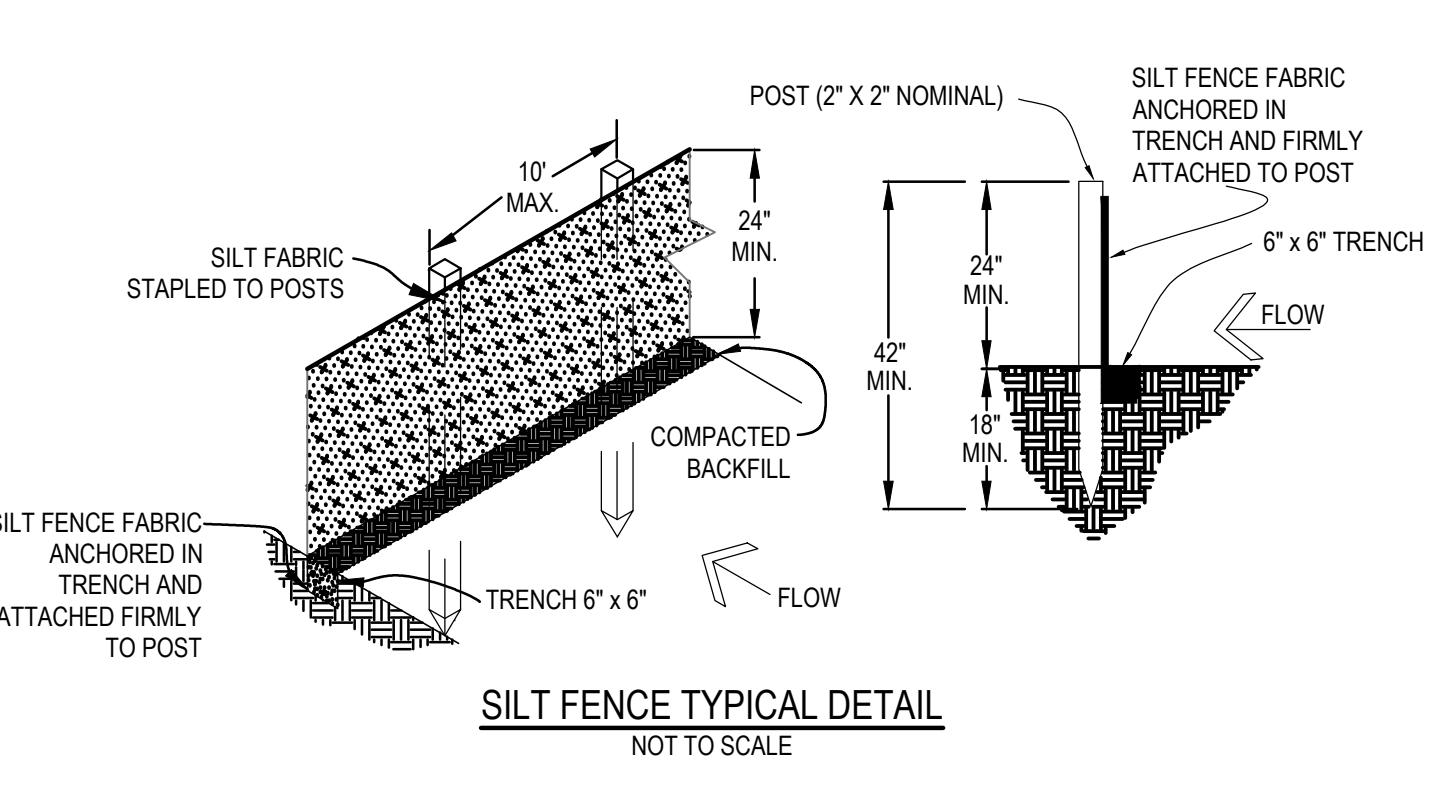
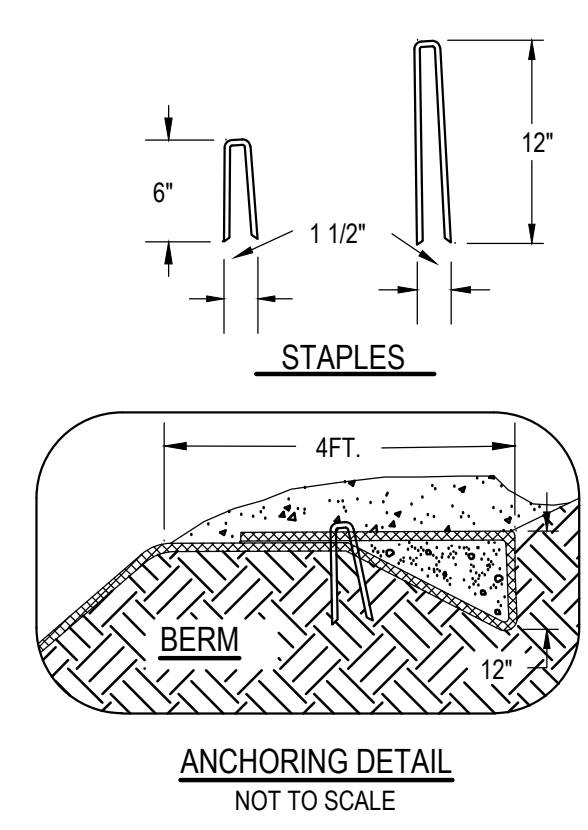
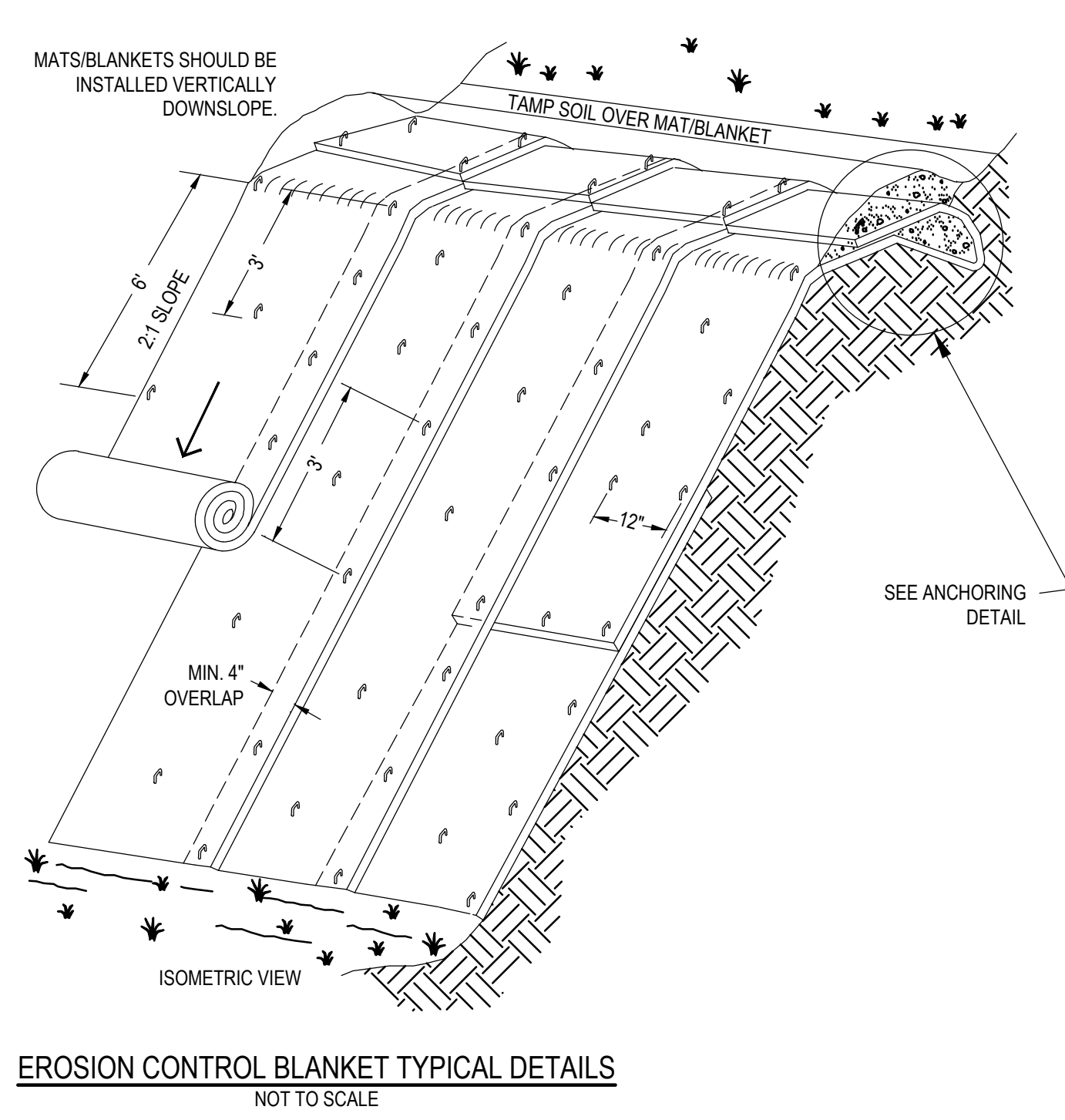
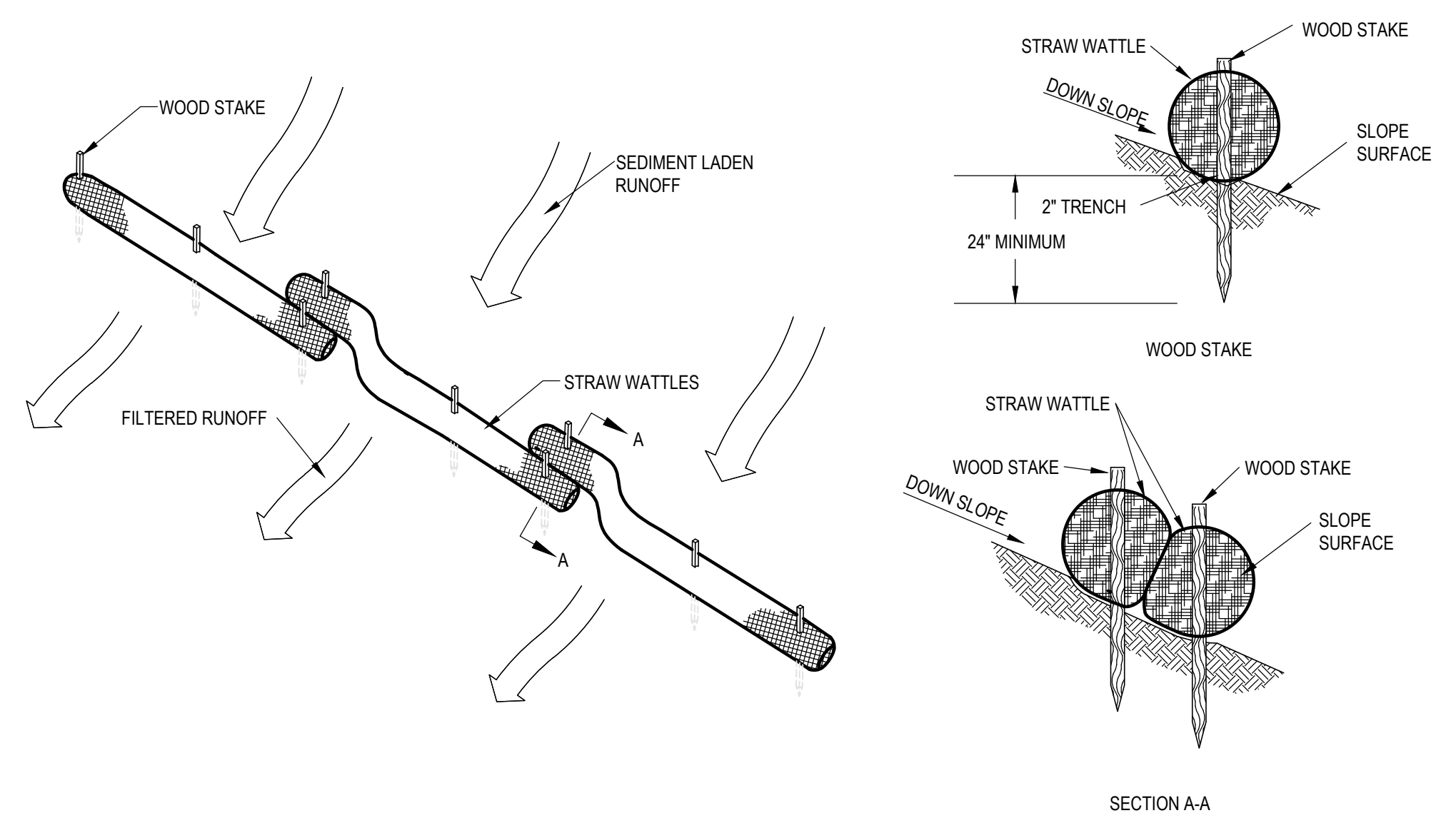

440 S. Lincoln Ave, Suite 4A
P.O. Box 775966
Steamboat Springs, CO 80487
(970)-871-6772
www.fourpointse.com

NO.	DATE	REVISIONS	INT

LOTS 5-8, BLOCK 12
STEAMBOAT SPRINGS, CO 80487

Horizontal Scale

SCALE: 1" = 20'

Contour Interval = 1 ft

DATE: 04/11/2024
JOB #: 2171-002
DRAWN BY: DSC
DESIGN BY: DSC
REVIEW BY: WNM

DRAWING: **CONSTRUCTION SITE MANAGEMENT PLAN**

SHEET NO. **C1**