

ALL SITE PLAN DIMENSIONS AND SURVEY ELEVATIONS ARE REFERENCED FROM:  
 EXISTING CONDITIONS PLAN  
 LOT 3, COPPER RIDGE BUSINESS PARK, FILING NO. 4  
 ROUTT COUNTY, COLORADO  
 PROVIDED BY: FOUR POINTS SURVEYING AND ENGINEERING  
 DATED: 6-21-22

**REVIEWED  
 FOR  
 CODE  
 COMPLIANCE**  
 06/23/2023

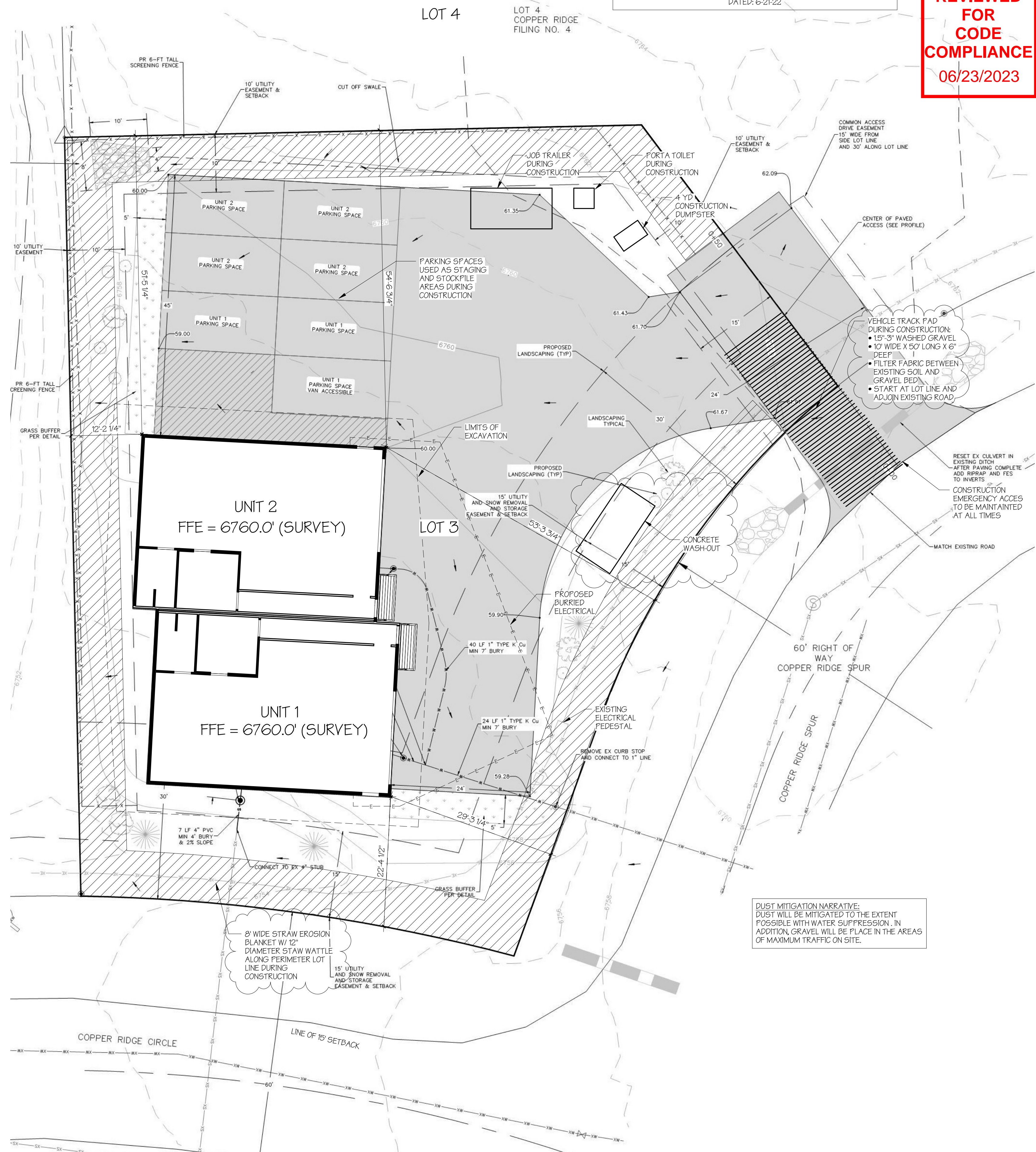

DUST MITIGATION NARRATIVE:  
 DUST WILL BE MITIGATED TO THE EXTENT  
 POSSIBLE WITH WATER SUPPRESSION. IN  
 ADDITION, GRAVEL WILL BE PLACED IN THE AREAS  
 OF MAXIMUM TRAFFIC ON SITE.

1 CONSTRUCTION SITE MANAGEMENT PLAN  
 1" = 10'-0"

**The ENGINEERING LOFT**  
 15873 FAIRWAY DRIVE  
 BUENA VISTA, CO 81211  
 720.491.1611  
 CHRISTINA@ENGINEERINGLOFT.COM

**RICHEY LIVE/WORK UNITS**  
 LOT 3 COPPER RIDGE BUSINESS PARK SUBDIVISION F4  
 STEAMBOAT SPRINGS, CO 80487  
 CONSTRUCTION SITE MANAGEMENT PLAN



PRELIM DATE:	7.18.22
RELEASE DATE:	7.19.22
REVISION DATE:	8.29.22
	4.10.23
	6.12.23

SHEET:  
**A1.1**

PROJECT NO: 21160